

INLAND WETLANDS
COMMISSION
Telephone (203) 563-0180
Fax (203) 563-0284



TOWN HALL
238 Danbury Road
Wilton, Connecticut 06897

APPLICATION FOR AN INTERMEDIATE REGULATED ACTIVITY

For Office Use Only:

Filing Fee \$ _____	WET# _____
Date of Submission _____	Wilton Land Record Map# _____
Date of Acceptance _____	Volume # _____ Page # _____
	Assessor's Map # _____ Lot# _____

APPLICANT INFORMATION:

Applicant Caitlin Cornell & Colin McKeon
Address 16 Overidge Lane
Wilton, CT 06897
Telephone (802) 779-3740
Email caitlinRcornell@gmail.com

Agent (if applicable) _____
Address _____
Telephone _____
Email _____

PROJECT INFORMATION:

Property Address 16 Overidge Lane
Acres of altered Wetlands On-Site 0
Linear Feet of Watercourse -
Linear Feet of Open Water 0
Sq. Ft. of proposed and/or altered impervious coverage 0

Site Acreage 2.437
Cu. Yds. of Material Excavated 28
Cu. Yds. of Material to be Deposited 65
Acres of altered upland buffer 0
Sq. Ft. of disturbed land in regulated area 0

APPLICATION REQUIREMENTS:

Is The Site Within a Public Water Supply
Watershed Boundary? NO ☒ YES* ☐

Is The Site Within 500 Feet of a Town Boundary?
NO ☒ YES* ☐

* If the answer is yes, then the applicant is responsible for notifying the appropriate water authority and/or adjoining community's Wetlands Department. Instructions for notification are available at the office of the commission.

Project Description and Purpose: New septic system (will use existing septic tank). Propose new 1,000 gallon pump chamber. Install new leaching area, which will require 65 cubic yards of select fill.

In addition, the applicant shall provide nine (9) collated copies of the following information as well as an electronic submission via email to mike.conklin@wiltonct.org & elizabeth.larkin@wiltonct.org **

- ☐ A. Written consent from the owner authorizing the agent to act on his/her behalf
- ☐ B. A Location Map at a scale of 1" = 800'
- ☐ C. *A Site Plan showing existing and proposed features at a scale not to exceed 1" = 40'*
- ☐ D. Sketch Plans depicting the alternatives considered
- ☐ E. Names and addresses of adjoining property owners
- ☐ F. A narrative describing, in detail
 - a. the proposed activity
 - b. the alternatives considered
 - c. impacts
 - d. proposed mitigation measures
- ☐ G. Soils Report prepared by a Certified Soil Scientist and Wetlands Map prepared by a Registered Land Surveyor
- ☐ H. Description of the chemical and physical characteristics of fill material to be used in the Regulated Area
- ☐ I. Description and maps detailing the watershed of the Regulated Area
- ☐ J. One original application and eight (8) copies

****Application materials shall be collated and copies of documents more than two pages in length shall be double sided.**

See Section 7 of the Wetlands and Watercourses Regulations of the Town of Wilton for a more detailed description of applications requirements.

The Applicant or his/her agent certifies that he is familiar with the information provided in this application and is aware of the penalties for obtaining a permit through deception, inaccurate or misleading information.

By signing this application, permission is hereby given to necessary and proper inspections of the subject property by the Commissioners and designated agents of the Commission or consultants to the Commission, at reasonable times, both before and after a final decision has been rendered.

Applicant's Signature:  Date: 3/8/2024

Agent's Signature (if applicable):  Date: 3/8/2024

Inland Wetlands Commission
Town Hall
238 Danbury Road
Wilton, CT 06897

March 8, 2024

Re: Application for an Intermediate Regulated Activity

Dear Inland Wetland Commission:

Enclosed is an application for an intermediate regulated activity permit to allow us to install a new septic system and the requisite application fee.

D. Palladino & Son Septic Co. ("Palladino") advised that our septic system is "nearing the end of its lifespan" and that it has operated well beyond its expected lifespan of 40-45 years. Therefore, we feel it is best to install a new system to avoid a system failure. Palladino has designed the new system, advised on the contents of this application and will install the new septic system.

Thank you for your consideration with this matter.

Best regards,

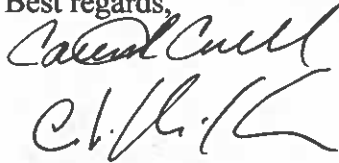
Two handwritten signatures are present. The first signature, in cursive, appears to read 'Caitlin Cornell'. The second signature, also in cursive, appears to read 'Colin McKeon'.

Caitlin Cornell
Colin McKeon

Caitlin Cornell & Colin McKeon
Application for Intermediate Regulated Activity

Item A

Written Consent from the owner authorizing the agent to act on his / her behalf

Not applicable.

Caitlin Cornell & Colin McKeon
Application for Intermediate Regulated Activity

Item B

A Location Map at a scale of 1" = 800'

Please see attached.

Town of Wilton

Geographic Information System (GIS)



Date Printed: 1/23/2024

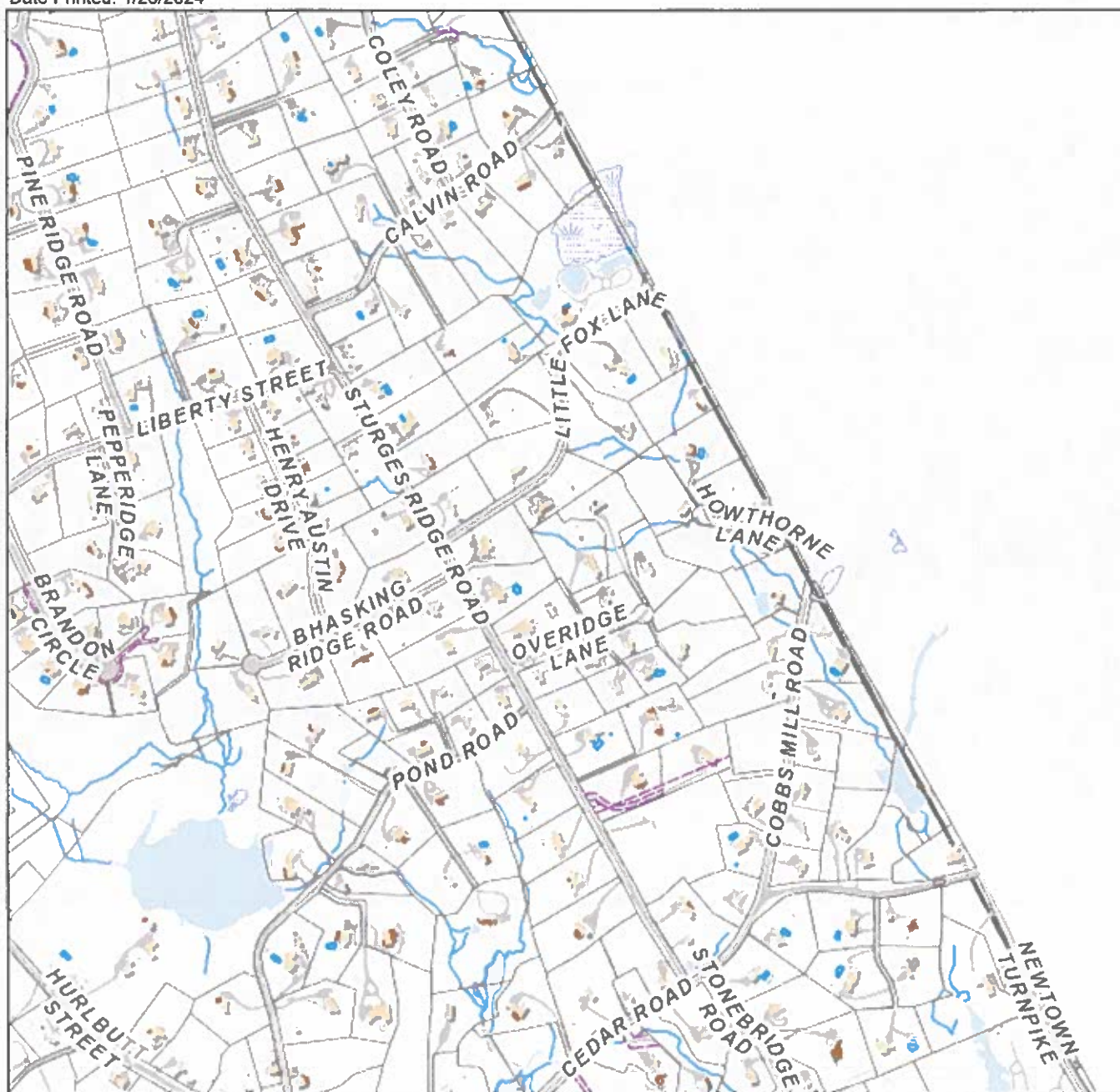

MAP DISCLAIMER - NOTICE OF LIABILITY

This map is for assessment purposes only. It is not for legal description or conveyances. All information is subject to verification by any user. The Town of Wilton and its mapping contractors assume no legal responsibility for the information contained herein.

Zoning Effective: July 28, 2017

Planimetrics Updated: 2014

Approximate Scale: 1 inch = 800 feet

0 800
Feet



Caitlin Cornell & Colin McKeon
Application for Intermediate Regulated Activity

Item C

A Site Plan Showing Existing and Proposed Features at a Scale not to Exceed 1" = 40'

Please see attached.

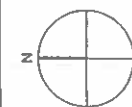

PROPOSED 9" OF GLF 12-72
PROPOSED 8" OF SELECT FILL

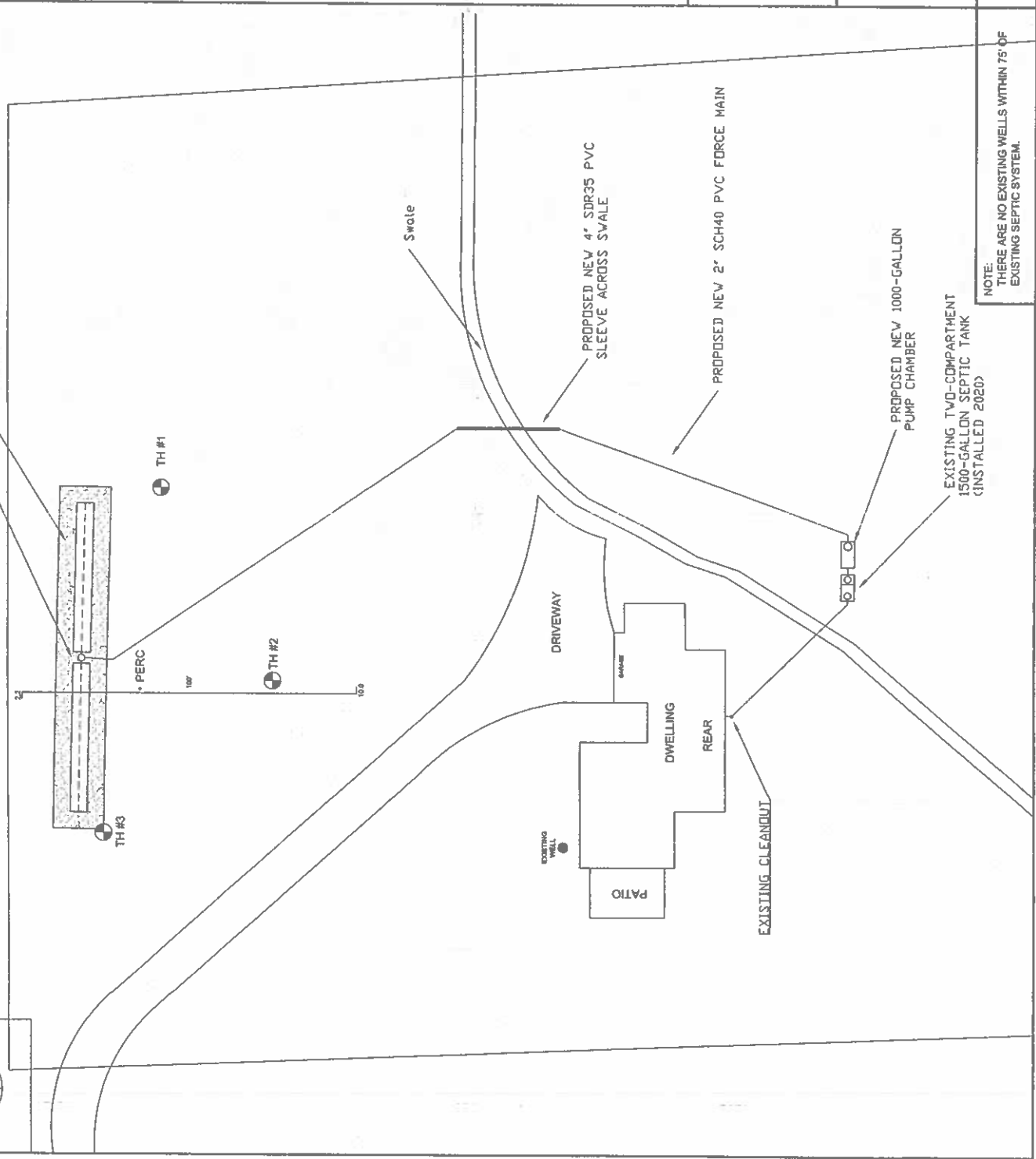

NOTE:
THERE ARE NO EXISTING WELLS WITHIN 75' OF
EXISTING SEPTIC SYSTEM.

Code Complying Area

DESIGN PARAMETERS: 7% SLOPE
6 BEDROOM DWELLING 1700 sq. ft. PVC
900 SQUARE FEET REQUIRED
PROPOSED 9" OF GLF 12-72
90" X 10.1' SOFTALF = 909 SQ. FT. TOTAL

PERC DATA

PERC DATA	PERC DATA
8" Round	18" Deep
10:20	4"
10:30	8.33"
11:00	11"
11:10	12.8"
11:20	13.5"
11:30	14.28"
11:40	15"

AVERAGE BATTERY LAYER

1700 sq. ft. PVC
27" x 32" = 864' 2 = 28.5'

TEST HOLE DATA

TH #1 Topsoil
9" - 38" Red Brown Fine Sandy Loam
38" - 72" Gray Mottled Hardpan
No Water
No Ledge
27" - Plastic Layer

TH #2 Topsoil
9" - 38" Red Brown Fine Sandy Loam
38" - 72" Gray Mottled Hardpan
No Water
No Ledge
32" - Plastic Layer

TH #3 Topsoil
9" - 38" Red Brown Fine Sandy Loam
38" - 72" Gray Mottled Hardpan
No Water
No Ledge
32" - Plastic Layer

D. PALLADINO & SON
SEPTIC CO. INC.
PO BOX 968
NEW CANAAN CT 06840
LICENSE #004053 TEL: (203)966-9349

Caitlin Cornell
16 Overridge Lane
Wilton, CT 06897

DATE: August 14, 2023
SCALE: 1" = 20' - 0"

Item D

Sketch Plans Depicting Alternatives Considered

This location was selected to maximize distance from wetlands.

Caitlin Cornell & Colin McKeon
Application for Intermediate Regulated Activity

Item E

Names and Addresses of Adjoining Property Owners

Address: 18 Overidge Lane

Names: Walters, Frank S & Frances, Walters

Address: 20 Overidge Lane

Names: Chico, Hernan Francisco & Seijas, Vanessa Lauren

Address: 21 Little Fox LA

Names: Levine, Theodore A & Levine, Emma

Address: 94 Sturges Ridge Road

Names: McFadden, Mary Beth & Levenherz, Shanon V

Address: 88 Sturges Ridge Road

Names: Davis, David G & Davis Jeanette

Address: 76 Sturges Ridge Road

Name: Anda, Jon

Item F

Narrative Describing, in detail

- (a) **Proposed Activity:** Existing two-compartment septic tank to remain. Install new 1,000 gallon pump chamber. Install new 2" SCH 40 pump line and sleeve across swale. Install 90' of GLF 12-72. Will require 65 cubic yards of select fill.
- (b) **Alternatives Considered:** None, since a viable septic system is necessary for the use and enjoyment of our property. I have, however, worked with who I understand is the best to design and install the new system, Palladino & Son Septic Co., to ensure it is done professionally and without any damage or impact to the wetlands.
- (c) **Impacts:** Palladino has stated that there will be no impact to wetlands.
- (d) **Proposed Mitigation Measures:** This location was selected to maximize distance from wetlands. Silt fence to be installed.

Caitlin Cornell & Colin McKeon
Application for Intermediate Regulated Activity

Item G
Soil Report

Please see attached.

SOIL & WETLAND SCIENCE, LLC

OTTO R. THEALL

PROFESSIONAL SOIL SCIENTIST

PROFESSIONAL WETLAND SCIENTIST

2 LLOYD ROAD

NORWALK, CONNECTICUT 06850

TELEPHONE (203) 845-0278

FACSIMILE (203) 354-4881

SOIL INVESTIGATION REPORT

16 OVERIDGE LANE

WILTON, CONNECTICUT

MARCH 13, 2002

I conducted an on-site investigation of the soils on a portion of the property located at 16 Overidge Lane in Wilton, Connecticut on March 13, 2002. The search for inland wetland soils was conducted in the field by inspection of approximately 60 soil samples taken with spade and auger.

The wetland line was marked in the field with red flags numbered 1 through 8 and 9 through 15. The wetland soils consist of *Leicester fine sandy loam (Lc)*. The non-wetland soils consist of *Charlton fine sandy loam, 3 to 8 percent slopes (CfB)*. The soil mapping units contain small inclusions of other soil types.

In my professional opinion, the majority of the length of the swale in the middle of the wetland does not qualify as an intermittent watercourse. Therefore, no watercourse flagging was done.

Respectfully submitted:



Otto R. Theall

Professional Soil Scientist

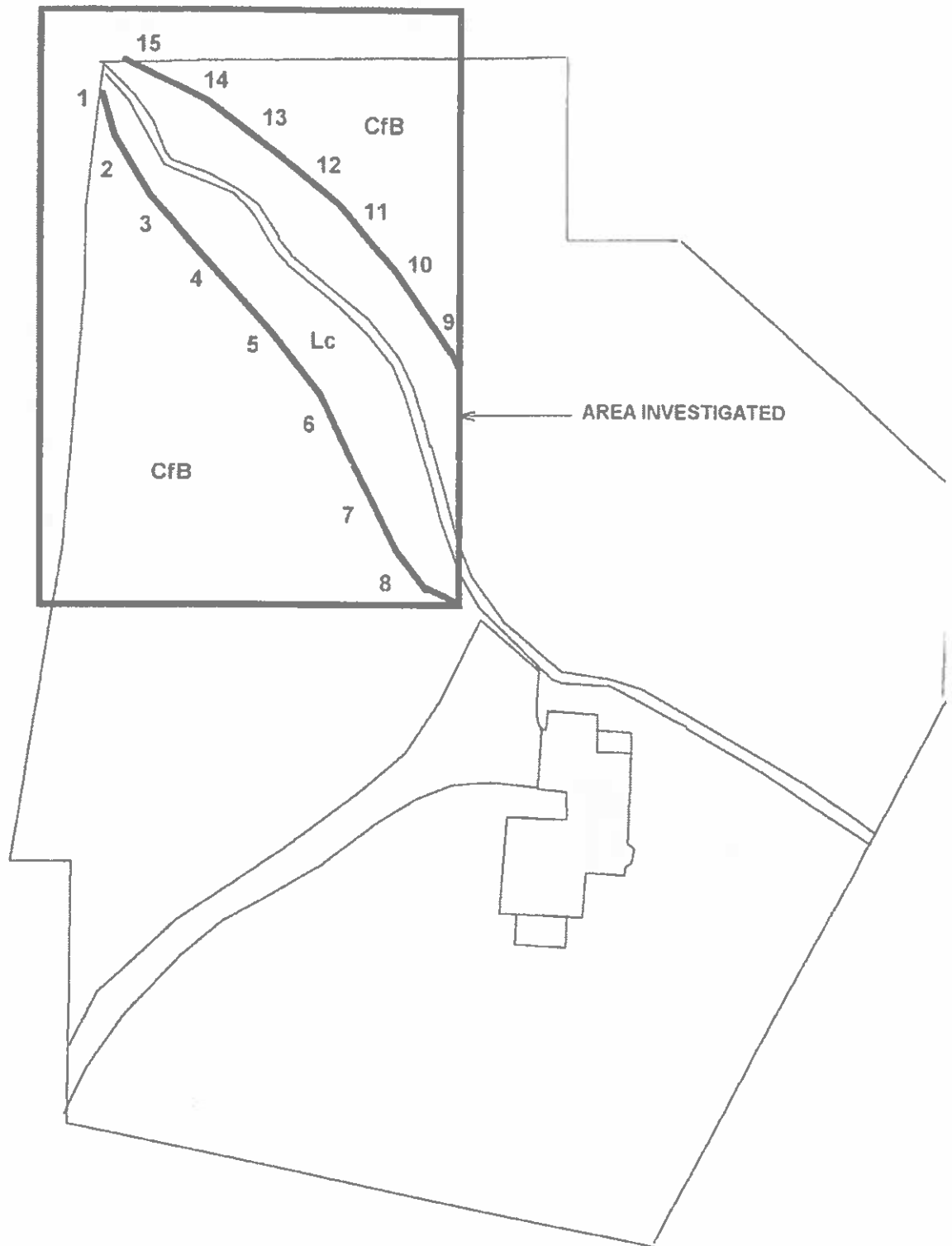

SKETCH OF SOIL SURVEY
16 OVERIDGE LANE
WILTON, CONNECTICUT
SOIL & WETLAND SCIENCE, LLC
MARCH 13, 2002

Item H

Description of the Chemical and Physical characteristics of fill material to be used in the
Regulated Area

Select fill will be utilized.

Item I







Description and Maps Detailing the Watershed of the Regulated Area

Not applicable.

WILTON

CONNECTICUT SUBREGIONAL BASINS AND SURFACE WATER FLOW DIRECTIONS

Explanation

-  Town Boundary
-  Subregional Watershed Boundary
- 4201** Subrg. Basin ID# - as designated by CTDEP
-  Watercourse  Open Water
-  Basin Outlet
-  Surface Water Flow Direction

The table provides statistics for each subregional basin. Shown are the areas of the basin within the town, the percentage for that area, and the percent of the town covered by each basin.

Sbas_nc	AcresInTw	Percofb	Percoftwn
7200	318.81	1.0	1.8
7203	1777.93	23.3	10.2
7300	6609.70	31.7	37.8
7301	4046.03	86.1	23.1
7302	4738.78	32.9	27.1

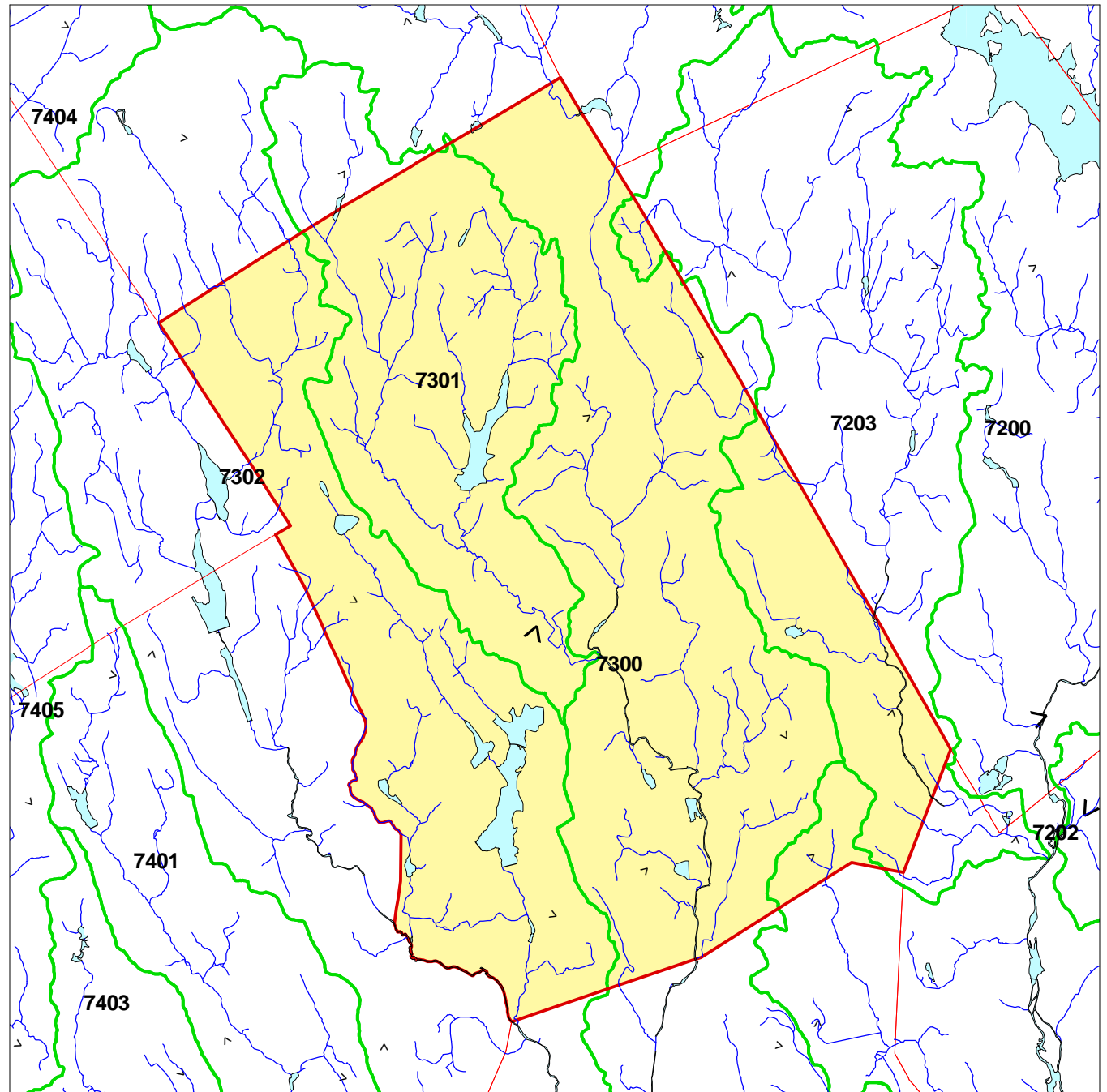

Town Area: 17491 Acres

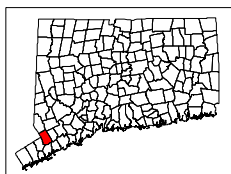

Digital layers provided by the CTDEP.
Map composed by the NEMO project.
For educational purposes only.

1 0 1 Miles



The University of Connecticut, CES: November 02, 1999