

INLAND WETLANDS
COMMISSION
Telephone (203) 563-0180
Fax (203) 563-0284



TOWN HALL
238 Danbury Road
Wilton, Connecticut 06897

APPLICATION FOR A MINOR REGULATED ACTIVITY

For Office Use Only:

WET# _____	
Filing Fee \$ _____	Wilton Land Record Map# _____
Date of Submission _____	Volume # _____ Page # _____
Date of Acceptance _____	Assessor's Map # _____ Lot# _____

APPLICANT INFORMATION:

Applicant: Thomas De Loia
Address: 84 Pine Ridge Rd
Wilton, CT 06897
Telephone: 415.265.3662
Email: tom@deloia.com

Agent (if applicable) _____
Address _____
Telephone _____
Email _____

PROPERTY INFORMATION:

Property Address: 84 Pine Ridge Rd
Acres of altered Wetlands On-Site: 0
Linear Feet of Watercourse: 40-60
Linear Feet of Open Water: 0
Sq. Ft. of proposed and/or altered impervious coverage: 0

Site Acreage: 2.03
Cu. Yds. of Material Excavated: 0
Cu. Yds. of Material to be Deposited: 0
Acres of altered upland buffer: 0
Sq. Ft. of disturbed land in regulated area: 0

APPLICATION REQUIREMENTS:

Is The Site Within a Public Water Supply
Watershed Boundary? NO * _____ YES* _____

Is The Site Within 500 Feet of a Town Boundary?
NO* _____ YES* _____

* If the answer is yes, then the applicant is responsible for notifying the appropriate water authority and/or adjoining community's Wetlands Department. Instructions for notification are available at the office of the commission.

Project Description and Purpose: Fell approximately 15 dead Ash tree, some of which are in wetlands.
Cut trees that are already on the ground and the dead trees into 6-8 ft lengths and stack them
on my property outside the wetland. Remove unsightly brush. Remove unsightly brush and
dead trees on the North and South edge of property.

In addition, the applicant shall provide three (3) collated paper copies of the following information as well as an electronic submission via email to mike.conklin@wiltonct.org & elizabeth.larkin@wiltonct.org **

- ☐ A. Written consent from the owner authorizing the agent to act on his/her behalf
- ☒ B. A Location Map at a scale of 1" = 800'
- ☒ C. A Site Plan showing existing and proposed features
Include photos & Letter from Arborist
- ☒ D. Names and addresses of adjoining property owners

****Application materials shall be collated and copies of documents more than two pages in length shall be double sided.**

See Section 7 of the Wetlands and Watercourses Regulations of the Town of Wilton for a more detailed description of applications requirements.

The Applicant or his/her agent certifies that he is familiar with the information provided in this application and is aware of the penalties for obtaining a permit through deception, inaccurate or misleading information.

By signing this application, permission is hereby given to necessary and proper inspections of the subject property by the Commissioners and designated agents of the Commission or consultants to the Commission, at reasonable times, both before and after a final decision has been rendered.

Applicant's Signature: _____

Date: _____

Agent's Signature (if applicable): _____

Date: _____

THOMAS DE LOIA
84 PINE RIDGE RD, WILTON, CT 06897
(415) 265-3662 CELL
tom@deloia.com

December 17, 2021

Mike Conklin
Director of Environmental Affairs
Town of Wilton
238 Danbury Road
Wilton, CT 06897

Hello Mike,

Application for a Minor Regulated Activity

Enclosed is my application to remove the dead and felled trees from the back of our property. I am also enclosing a check for \$210 and three copies of the following documents:

Section B:

- A location map at a scale of 1" to 800'

Section C:

- A map of our property showing the area of wetlands and where we plan to stack the wood
- A map from the Town of Wilton showing the soil types
- A panorama photo with the dead trees marked in yellow
- Three pages of photos showing the trees marked with orange tape
- A letter from an Arborist along with a page with his name from the CT Tree Protective Association

Section D:

- A map showing our neighbors

Thank you for coming by and giving me your suggestions.

Sincerely,



Thomas J. De Loia
attachments

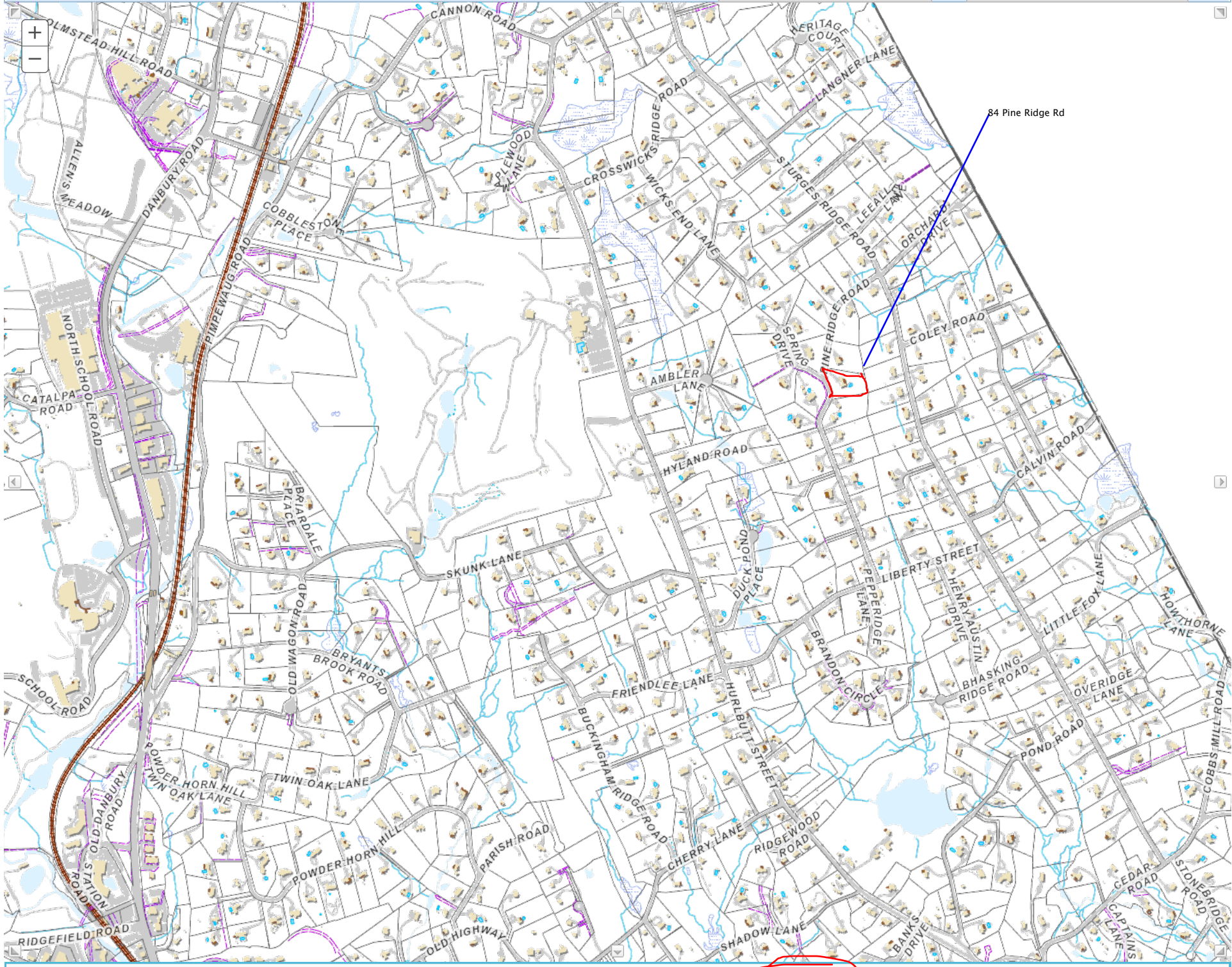

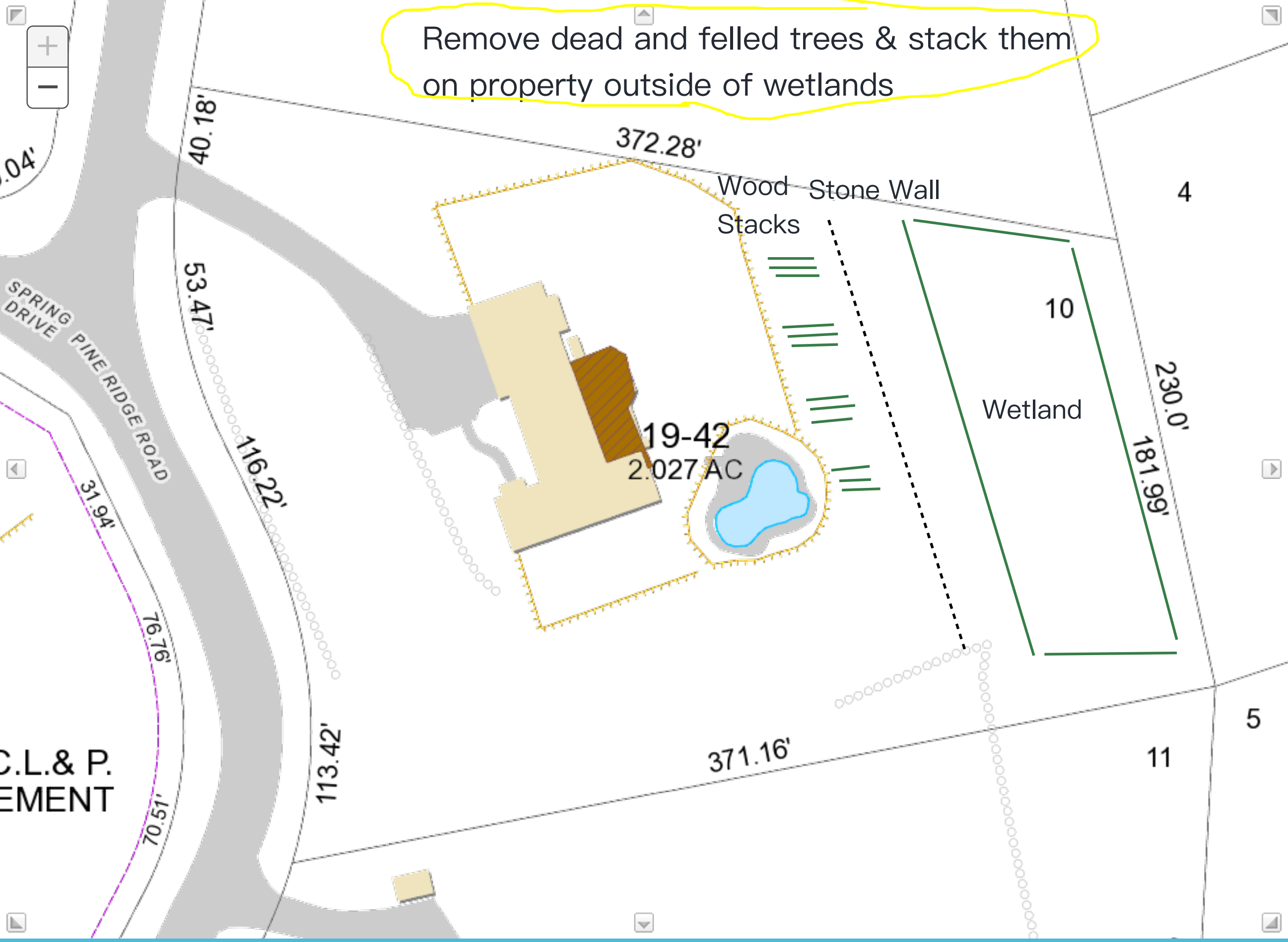

4

S 00°-53'-10" W

181.99'

50'

Rd

88,330[±] SF
2.027[±] AC

7

1

1A

9

11

11

Wx

Wx

40'

UD

UD

Wx

Wx

UD

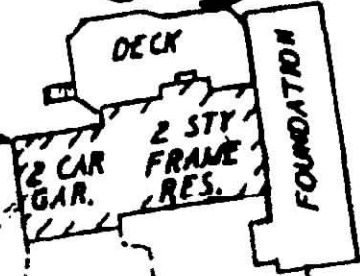

105'

90'-00"-00'

WELL

86'± LINE

Pb

Pb

Pb

SERVICE WIRE

DRIVEWAY

SETBACK

L=53.47
R=100.00

116.22

R=132.16

L=113.42

N 10°-19'-00" W

PINE RIDGE ROAD

ROAD

50'

ORUCE

BUILDING COVERAGE : 3 600 ± S.F

Fell ~ 16 trees, mostly Ash, 6–7 in wetlands



The three sets of photos show marked trees where marks are not visible in the large panorama photo







DEAR MR. DELOIA,

IT WAS A PLEASURE TO
MEET WITH YOU AND KIETH ON TUESDAY
I HOPE THAT THIS RECOMENDATION WILL
HELP YOU PROCEED WITH YOUR PROJECT.

THE 12 DEAD ~~RED~~ WHITE ASH
TREES (FRAXINUS AMERICANA) DBH BETWEEN
8" AND 18" WERE KILLED BY THE EMERALD
ASH BORER. THIS INVASIVE BORER HAS
DELIMITED ASH TREES OVER MOST OF THE
UNITED STATES.

THESE DEAD WHITE ASH TREES
ARE NOT ONLY AN EYESORE BUT ALSO
A HAZARD TO THE PROPERTY AND FENCE.
MORE IMPORTANTLY A HAZARD TO ANY PERSON
IN THE REAR OF THE PROPERTY.

HOPEFULLY THIS WILL HELP
YOU PROCEED WITH THE IMPROVEMENTS
AND SAFETY ON YOUR PROPERTY.

SINCERELY/
PETER L. RADLET

GT ARBORIST LIC # 6168



List of individuals Licensed as arborists by the State of Connecticut is provided as a public service by the Connecticut Tree Protective Association. Contact information on Connecticut Licensed Arborists who are CTPA members may be found on the CTPA Website. Arborists Businesses registered with the State of Connecticut may be found on CTPA's Go To The Top web page.



Connecticut Licensed Arborists

(This list was last update on May 19, 2020.)

761. PUZYCKI, TED

Arborist License Number: S-4192
NO. BRANFORD, CT

762. QUAGLIAROLI, LINDA

Arborist License Number: S-3221
WINDSOR LOCKS, CT

763. QUALEY, BRIAN

Arborist License Number: 62416
RIDGEFIELD, CT

764. QUARANTA, JOE P.

Arborist License Number: S-5793
ROXBURY, CT

765. QUICK, PAUL

Arborist License Number: 62817
Darien, CT

766. QUINN, MATTHEW

Arborist License Number: 62784
Woodstock, CT

767. QUIROS, MAURICIO

Arborist License Number: S-6780
BETHEL, CT

768. RADLET, PETER L.

Arborist License Number: 61688
DANBURY, CT

769. RANDALL, MARK D.

Arborist License Number: 62343
REDDING, CT

