

INLAND WETLANDS  
COMMISSION  
Telephone (203) 563-0180  
Fax (203) 563-0284



TOWN HALL  
238 Danbury Road  
Wilton, Connecticut 06897

## APPLICATION FOR A MINOR REGULATED ACTIVITY

### For Office Use Only:

Filing Fee \$ \_\_\_\_\_

Date of Submission \_\_\_\_\_

Date of Acceptance \_\_\_\_\_

WET# \_\_\_\_\_

Wilton Land Record Map# \_\_\_\_\_

Volume # \_\_\_\_\_ Page # \_\_\_\_\_

Assessor's Map # \_\_\_\_\_ Lot# \_\_\_\_\_

### APPLICANT INFORMATION:

Applicant: SHARON COWLEY (DRW Company LLC) Agent (if applicable) \_\_\_\_\_

Address 463 DANBURY RD.  
WILTON CT

Address \_\_\_\_\_

Telephone 203-726-6161

Telephone \_\_\_\_\_

Email sharon@createlearningcenter.com Email \_\_\_\_\_

### PROPERTY INFORMATION:

Property Address 463 DANBURY ROAD

Site Acreage 2.003

Acres of altered Wetlands On-Site 0

Cu. Yds. of Material Excavated 0

Linear Feet of Watercourse 341

Cu. Yds. of Material to be Deposited 0

Linear Feet of Open Water 341

Acres of altered upland buffer 0.0055

Sq. Ft. of proposed and/or altered impervious coverage  
687

Sq. Ft. of disturbed land in regulated area 240

### APPLICATION REQUIREMENTS:

Is The Site Within a Public Water Supply  
Watershed Boundary? NO ☒ YES\* \_\_\_\_\_

Is The Site Within 500 Feet of a Town Boundary?  
NO ☒ YES\* \_\_\_\_\_

\* If the answer is yes, then the applicant is responsible for notifying the appropriate water authority and/or adjoining community's Wetlands Department. Instructions for notification are available at the office of the commission.

Project Description and Purpose: PLACEMENT OF SHEDS (DEPICTED AS ONE  
SITED ON THE DRAWING) WITHIN THE ESTABLISHED 100'  
UPLAND REVIEW AREA.

In addition, the applicant shall provide three (3) collated paper copies of the following information as well as an electronic submission via email to [mike.conklin@wiltonct.org](mailto:mike.conklin@wiltonct.org) & [elizabeth.larkin@wiltonct.org](mailto:elizabeth.larkin@wiltonct.org) \*\*

- ☐ A. Written consent from the owner authorizing the agent to act on his/her behalf
- ☐ B. A Location Map at a scale of 1" = 800'
- ☒ C. **A Site Plan showing existing and proposed features**
- ☐ D. Names and addresses of adjoining property owners

**\*\*Application materials shall be collated and copies of documents more than two pages in length shall be double sided.**

See Section 7 of the Wetlands and Watercourses Regulations of the Town of Wilton for a more detailed description of applications requirements.

The Applicant or his/her agent certifies that he is familiar with the information provided in this application and is aware of the penalties for obtaining a permit through deception, inaccurate or misleading information.

By signing this application, permission is hereby given to necessary and proper inspections of the subject property by the Commissioners and designated agents of the Commission or consultants to the Commission, at reasonable times, both before and after a final decision has been rendered.

Applicant's Signature: Sharon Cowley Date: 9/30/22

Agent's Signature (if applicable): \_\_\_\_\_ Date: 9/30/22

TOWN OF WILTON, CONNECTICUT  
LIST OF ADJOINERS TO 463 DANBURY ROAD, WILTON, CT

Parcel ID	Site Address	Owner Name	Mailing Address	Mailing City	Mailing State	Mailing Zip
34-4	OLMSTEAD HILL RD	CONNECTICUT STATE OF D.O.T.	2800 BERLIN TPKE	NEWINGTON	CT	06111-0000
34-5	454 DANBURY RD	TOMAS FAMILY LP	67 PINE RIDGE RD	WILTON	CT	06897-0000
35-35	28 SUGAR LOAF DR	ANDRIUK ALEXANDER	28 SUGAR LOAF DR	WILTON	CT	06897-0000
35-36	18 SUGAR LOAF DR	OBRANSKI SEAN & DIANA	18 SUGAR LOAF DR	WILTON	CT	06897-0000
35-37	398 OLMSTEAD HILL RD	HORICKA ROMAN	398 OLMSTEAD HILL RD	WILTON	CT	06897-0000
35-38	463 DANBURY RD	463 DRW COMPANY LLC	463 DANBURY RD	WILTON	CT	06897-0000
35-39	465 DANBURY RD	ROBLAR LLC	465 DANBURY RD	WILTON	CT	06897-0000
35-53	462 DANBURY RD	462 DANBURY RD ASSOCIATES LLC	462 DANBURY RD	WILTON	CT	06897-0000
34-4-1	414 OLMSTEAD HILL RD	WILTON HISTORICAL SOCIETY INC	224 DANBURY RD	WILTON	CT	06897-0000

PEAK ENGINEERS, LLC

SOURCE TOWN GIS

PEAK ENGINEERS LLC  
16 OLD MILL RD  
REDDING, CT 06896



**PEAK ENGINEERS LLC**  
**16 OLD MILL RD**  
**REDDING, CT 06896**

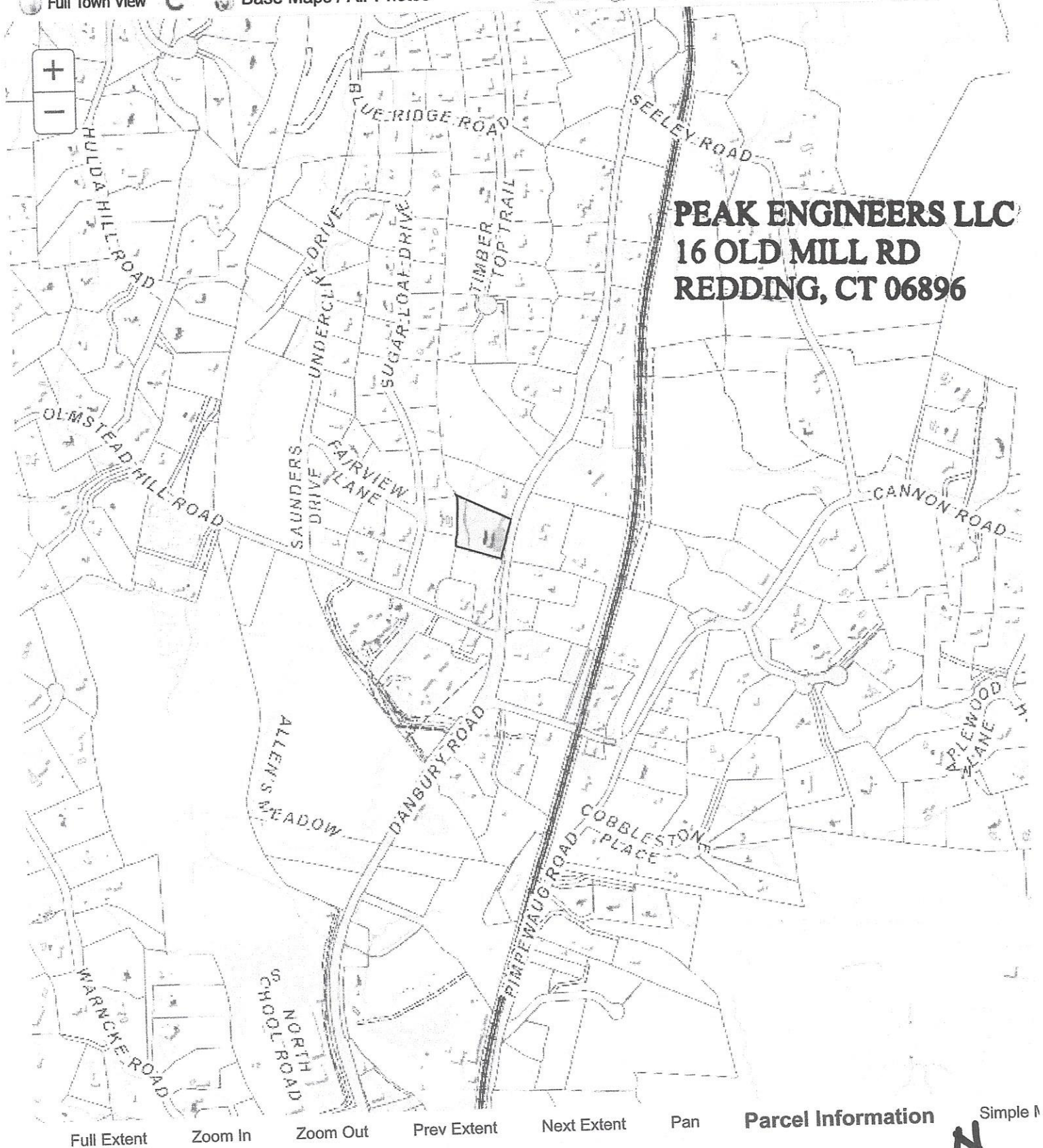

MapXpress v1.2

SOURCE: TOWN ON-LINE GIS. SHOWING 463 DANBURY ROAD, WILON, CT  
SCALE 1"=800', NORTH IS UP.

**LOCATION SKETCH 1"=800'**



