

INLAND WETLANDS  
COMMISSION  
Telephone (203) 563-0180  
Fax (203) 563-0284



TOWN HALL  
238 Danbury Road  
Wilton, Connecticut 06897

## APPLICATION FOR A MINOR REGULATED ACTIVITY

**For Office Use Only:**

Filing Fee \$ _____	WET# _____
Date of Submission _____	Wilton Land Record Map# _____
Date of Acceptance _____	Volume # _____ Page # _____
	Assessor's Map # _____ Lot# _____

### APPLICANT INFORMATION:

Applicant Brian + Lisa Erickson  
Address 280 Mountain Rd  
Wilton CT 06897  
Telephone 1-425-406-9000  
Email Branerack@hotmail.com

Agent (if applicable) Caenb Tom COT Builders  
Address 72 Shorefront Park  
Newark Ct 06854  
Telephone 203-216-3169  
Email Caentomas@COTBuilders.com

### PROPERTY INFORMATION:

Property Address 280 Mountain Road  
Acres of altered Wetlands On-Site —  
Linear Feet of Watercourse 150 LF +/-  
Linear Feet of Open Water 150 LF +/-  
Sq. Ft. of proposed and/or altered impervious coverage 269 #

Site Acreage 2.001  
Cu. Yds. of Material Excavated 15 yds +/-  
Cu. Yds. of Material to be Deposited 15 yds +/-  
Acres of altered upland buffer 269 #  
Sq. Ft. of disturbed land in regulated area 269 #

### APPLICATION REQUIREMENTS:

Is The Site Within a Public Water Supply  
Watershed Boundary? NO YES\* ☒

Is The Site Within 500 Feet of a Town Boundary?  
NO ☒ YES\*       

\* If the answer is yes, then the applicant is responsible for notifying the appropriate water authority and/or adjoining community's Wetlands Department. Instructions for notification are available at the office of the commission.

Project Description and Purpose: 12x12 Rear Addition Including Foundation, 1st +  
2nd Floor. 5'x25' Front Porch w/ Roof Above. All Foundation  
To be Frost wall only w/ excavated materials being returned,  
and placed under front Porch.

In addition, the applicant shall provide three (3) collated paper copies of the following information as well as an electronic submission via email to [mike.conklin@wiltonct.org](mailto:mike.conklin@wiltonct.org) & [elizabeth.larkin@wiltonct.org](mailto:elizabeth.larkin@wiltonct.org) \*\*

- ☒ A. Written consent from the owner authorizing the agent to act on his/her behalf
- ☒ B. A Location Map at a scale of 1" = 800'
- ☒ C. A Site Plan showing existing and proposed features
- ☐ D. Names and addresses of adjoining property owners

**\*\*Application materials shall be collated and copies of documents more than two pages in length shall be double sided.**

See Section 7 of the Wetlands and Watercourses Regulations of the Town of Wilton for a more detailed description of applications requirements.

The Applicant or his/her agent certifies that he is familiar with the information provided in this application and is aware of the penalties for obtaining a permit through deception, inaccurate or misleading information.

By signing this application, permission is hereby given to necessary and proper inspections of the subject property by the Commissioners and designated agents of the Commission or consultants to the Commission, at reasonable times, both before and after a final decision has been rendered.

Applicant's Signature:  Date: 5/21/21

Agent's Signature (if applicable)  Date: 5/19/21

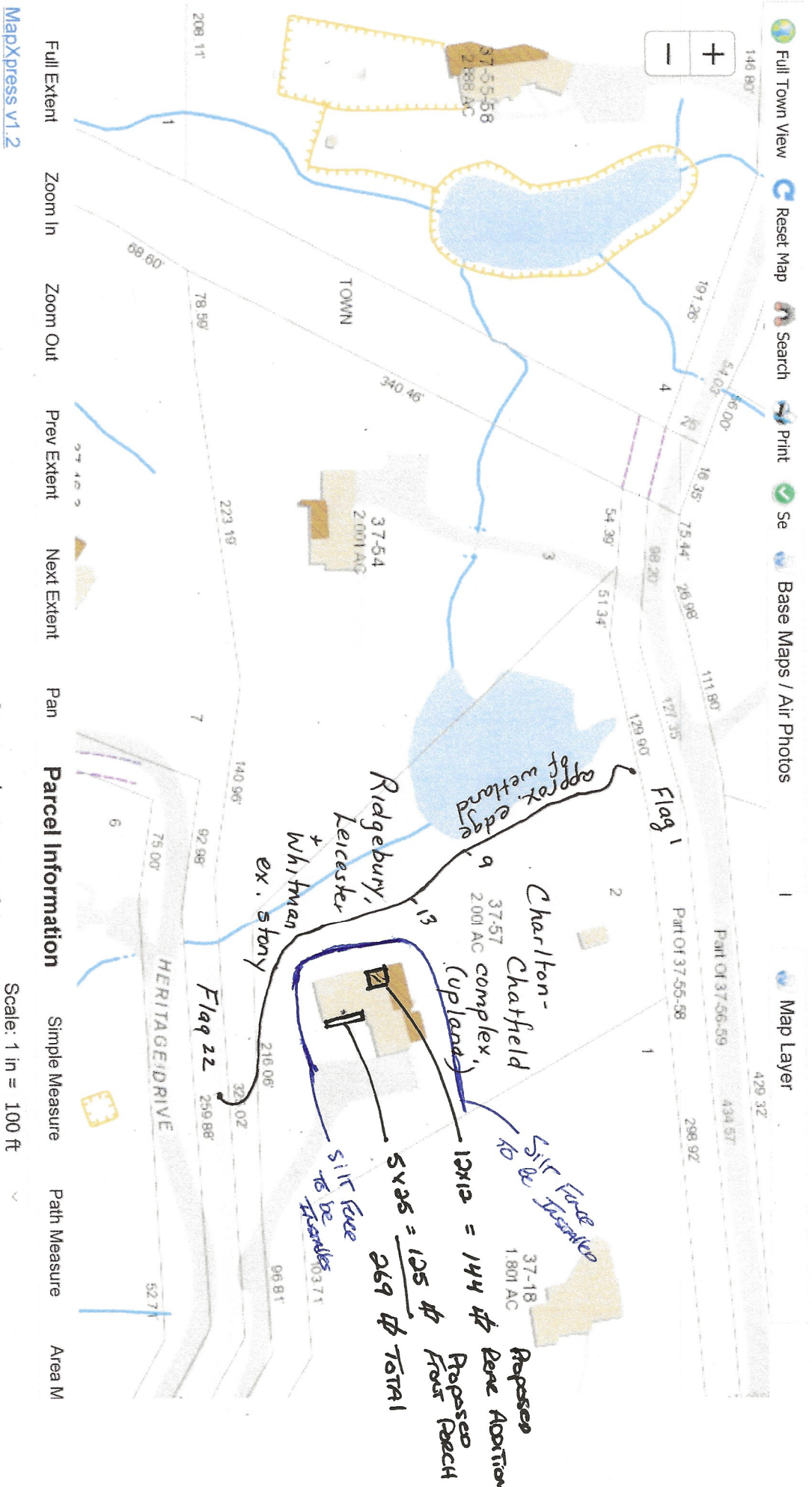

Wetland flagged 5-10-21  
 Mary Jaehning  
 Soil Sci.  
 203 431 8113

May 18, 2021

Brian and Lise Erickson  
280 Mountain Rd  
Wilton, CT 06897

We, Brian and Lise Erickson, owners of the property at 280 Mountain Rd in Wilton CT, grant permission for Carmelo Tomas of CJT builders to act as our Agent.

Signed,

Brian Erickson

*Brian Erickson*

Lise Erickson

*Lise Erickson*



① 282 Mountain Rd  
Deane + Carolyn Thomas  
Map + Lot 37-54

Adjoining Property  
owners of  
280 Mountain Rd.

② 274 Mountain Rd  
Virginia Wigren  
Map + Lot 37-18

③ 268 Mountain Rd  
Erik Deidan  
Map + Lot 37-55-58

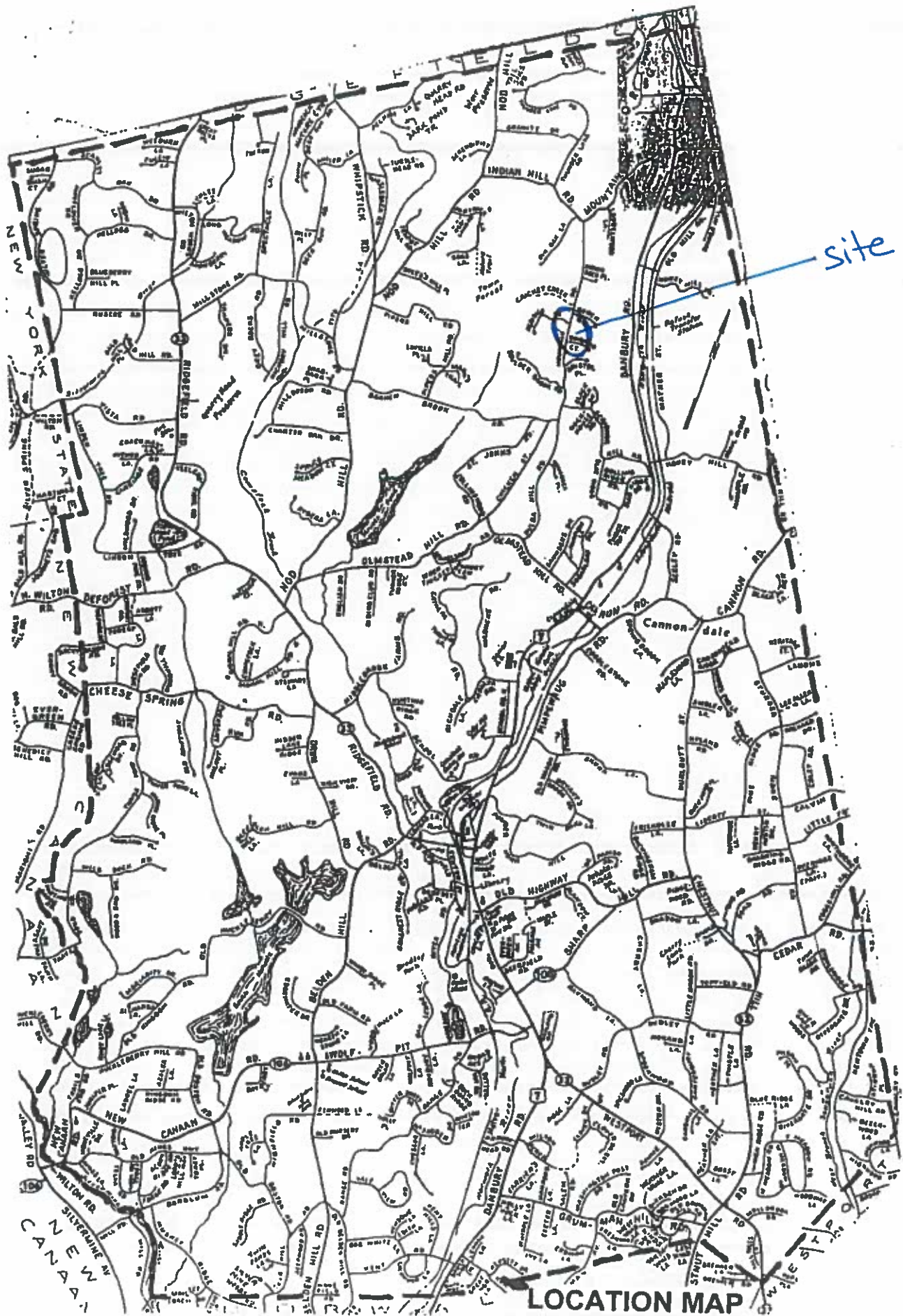

37-END  
WILTON TOWN OF  
238 DANBURY RD  
WILTON CT 06897

37-16-4  
DALLDORF ROBERT C  
286 MOUNTAIN RD  
WILTON CT 06897

37-19  
VENEGAS HECTOR J &  
262 MOUNTAIN RD  
WILTON CT 06897

37-53  
DELEPINE LINDA ANGELA  
252 MOUNTAIN RD  
WILTON CT 06897

37-56-59  
WARREN ANDREW F  
266 MOUNTAIN RD  
WILTON CT 06897

37-16  
ASHLEY JAMES C & ANDREA M  
290 MOUNTAIN RD  
WILTON CT 06897

37-17  
PRINZ DANA LYNN MACK TR  
PO BOX 7174  
WILTON CT 06897

37-25  
WANG JIANGHONG  
17 BERCH CT  
WILTON CT 06897

37-54  
DEANE THOMAS R & CAROLYN S  
282 MOUNTAIN RD  
WILTON CT 06897

37-57  
ERICKSON BRIAN A & LISE M  
280 MOUNTAIN RD  
WILTON CT 06897

37-16-3  
SELL NANCY J  
284 MOUNTAIN RD  
WILTON CT 06897

37-18  
WIGREN VIRGINIA K  
274 MOUNTAIN RD  
WILTON CT 06897

37-26  
LEE JAMES J & ISABEL K  
291 MOUNTAIN RD  
WILTON CT 06897

37-55-58  
DEIDAN ERIK  
268 MOUNTAIN RD  
WILTON CT 06897