

May 19, 2021

Inland Wetlands Commission
Town Hall Annex
238 Danbury Road
Wilton, CT 06897

RE: Application for an Intermediate Regulated Activity – NARRATIVE / PROJECT DESCRIPTION
8 Seeley Road, Wilton CT 06897

Dear Commission Members –

This Narrative will serve to describe the REVISED scope of work requested for the Intermediate Regulated Activity for the property location noted above.

It is important for us once again to apologize for removing the 11 trees on our property without obtaining permission from the Town. It is important that it be recognized that we did not realize that a permit would need to be issued prior to commencing this work.

The following list describes the items that we are asking the Commission to grant permission for under this Intermediate Application.

DESCRIPTION / REQUEST FOR PERMISSION (Landscape Plans Included for reference)

- 1- Complete the proposed trimming of dead branches located on one large tree (West side of the front yard). *This tree is currently dead – we would like to request permission to remove this tree completely in the future as part of this application*
- 2- Complete the removal of one pine tree that was previously topped (but not fully removed) on the West side of the house (see site plan sketch for location)
- 3- Install (4) Native **SHADBLOW SERVICEBERRY Trees** (*Amelanchier Canadensis*) along the West side of the property toward the Norwalk River (see Proposed Landscape Plan for locations and images/description below). Low ground cover is currently heavily established in this area with a mature bed of Skunk Cabbage and native grasses (see picture below).

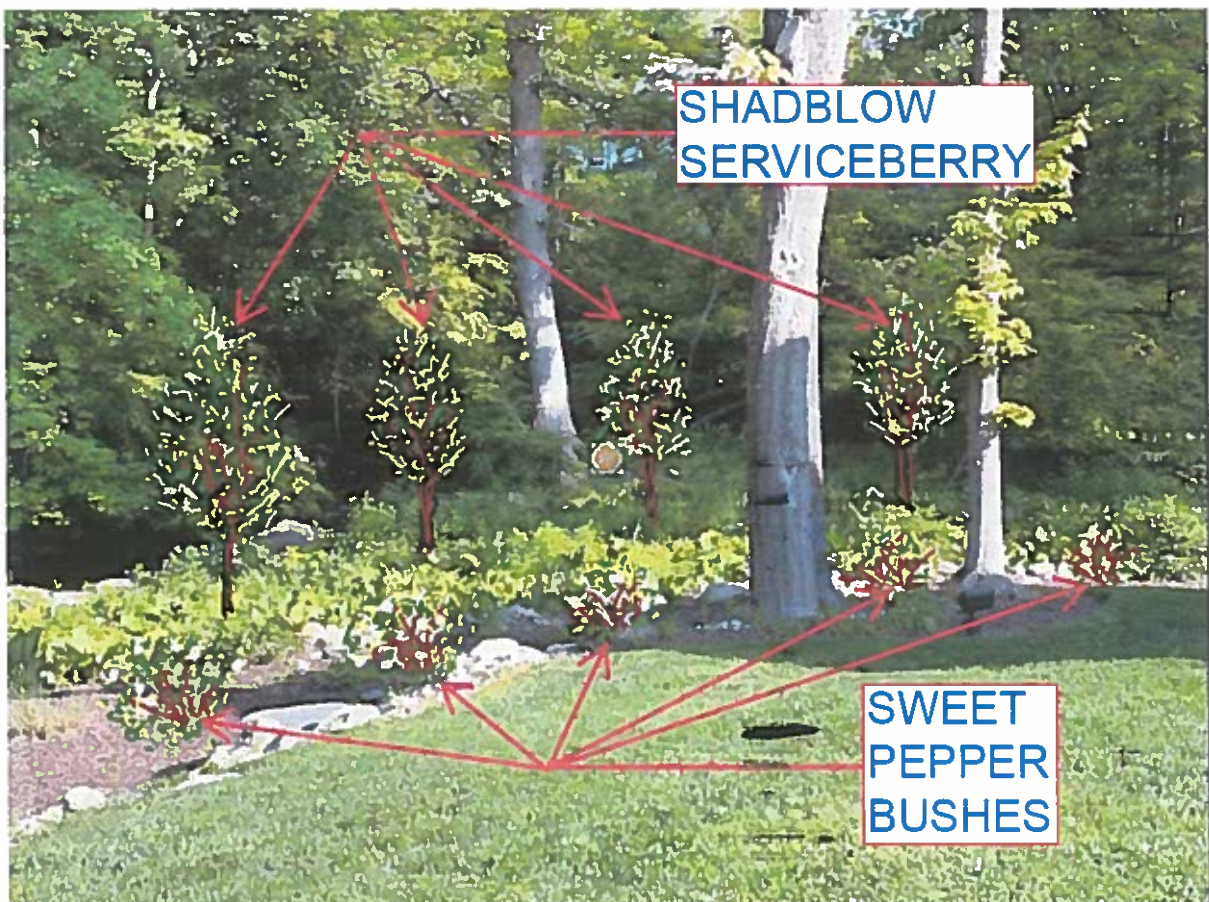

- 4- Install (16) native **CLETHRA ANIFOLIA (Vanilla Spice) - Sweet Pepper Bushes** along and existing mulch bed area on the west side of the house (see proposed Landscape Plan sketch for locations and plant specifications)
- 5- After discussions with the Mike Conklin, we have decided to withdraw the fill request at this time and would like to install (3) **ALNUS INCANA – Button Bushes** for this area to fill in and screen the exposed well cap (see proposed Landscape Plan sketch for locations and plant specifications)

As previously stated - the noted trailer that had been placed within the wetland area was placed in this position temporarily during the tree work in order to make room for the tree company to maneuver. The trailer was removed from the wetland area the same day that Zen was on site.

As previously stated - the noted pile of yard waste noted at the rear of the property that were deep in the woods was created well before we purchased the parcel by the previous owners. When the Cease and Desist order was modified allowing us to clean up the yard we had the pile of branches cleaned up and removed

As we discussed during our Show Cause Hearing, our property has an abundance of trees that continue to fight to survive due to the overgrown canopy that exists. We feel that the new selections made will not complete and will only help the property with lower ground cover. The new medium height canopy will also add some well needed color to the existing landscape as well. Below are images of the landscape materials we are proposing (see the location plan for placement under separate cover)

Proposed Tree Plant Material -



(3) AMELANCHIER CANADENSIS - Shadblow Serviceberry

Amelanchier canadensis (Canadian Serviceberry)

Canadian Serviceberry, Canadian Service-berry, Serviceberry, Juneberry, Grape Pear, Shadblow, Shadbush, Junebush, Amelanchier botryapium, Amelanchier intermedia, Amelanchier oblongifolia

Amelanchier canadensis (Canadian Serviceberry) is a dense, upright, multi-stemmed large shrub or small tree with a delicate, dome-shaped crown. In mid spring, attractive erect sprays of small, slightly fragrant, white, star-shaped flowers emerge just before the leaves. Attractive to pollinators, they are followed by small, edible, blue-black berries in early summer. The berries are used in jams, jellies and pies and are appreciated by both birds and humans. The foliage of mid-green, finely-toothed, oval leaves, turns to brilliant shades of yellow, orange and red in the fall. The plant remains attractive even after the leaves drop, thanks to its elegant growth habit and its light gray bark adorned with charcoal-gray striations. A terrific plant with four seasons of interest, to use around ponds, lakes, and streams, or in boggy or marshy ground.

- Grows up to 25-30 ft. tall (7-9 m) and 15-20 ft. wide (4-6 m)
- A full sun to part shade lover, this plant is easily grown in moist, well-drained, acidic soils. Best berry production and fall color occur in full sun. Adaptable to both wet and dry sites and various soil types.
- Low maintenance, this plant is also generally pest and disease free but keep an eye out for fire blight.
- Perfect as a specimen plant, hedges and screens, or for banks and slopes. Can be used for erosion control. Great in naturalized or native plant gardens or along stream banks and ponds.
- Propagate by seed and semi-hardwood cuttings or remove suckers in winter.
- Native to eastern North America.

Proposed Low Ground Cover Planting Materials –



(3) ALNUS INCANA – Button Bush

Cephalanthus occidentalis (Button Bush)

Common Buttonbush, Buttonbush, Button Bush, Globe-Flowered Bush, Honeybells, Little Snowballs, Swamp Globeflower, White Pond-Dogwood, Button Willow, Cephalanthus occidentalis var. californicus, Cephalanthus occidentalis var. pubescens

A wonderful butterfly magnet, *Cephalanthus occidentalis* (Button Bush) is a multi-stemmed, deciduous shrub of lax and loose, rounded habit. In early summer to early fall, it boasts long-lasting, unusual, spherical flower heads, 1.5 in. across (4 cm). Resembling pincushions, each scented flower head is packed with creamy-white, tubular flowers that are very attractive to hummingbirds, butterflies, and other insect pollinators. They mature into hard buttonlike balls in late summer, which usually persist throughout the winter. The foliage of oval, glossy bright green leaves, 6 in. long (15 cm), is attractive. Button Bush is a handsome ornamental shrub suited to wet soils. In a naturalized landscape where excess moisture is available, at the edge of ponds or wetlands, it is a reliable performer.

- Grows up to 5-12 ft. tall (150-360 cm) and 4-8 ft. wide (120-240 cm).
- A full sun lover, this plant is best grown in moist, humusy, neutral to acid soils. Tolerates light shade but best flowering occurs in full sun. Not fussy about soil type as long as it is rich or moist. Performs well in wet soils, including flood conditions and shallow standing water. Can grow in water to 18 in. deep (45 cm).
- Perfect for beds and borders, cottage gardens, bog gardens, rain gardens or along ponds or streams.
- No serious pest or disease issues.
- Pruning is usually not necessary, but may be done in early spring to shape.
- Propagate by semi-ripe or hardwood cuttings.
- Native to North America, Cuba, Mexico, eastern Asia



(16) CLETHRA ANIFOLIA (Vanilla Spice) - Sweet Pepper Bush

Clethra alnifolia 'Caleb' VANILLA SPICE' (Summersweet)

Sweet Pepper Bush 'Caleb' VANILLA SPICE', Sweet Pepperbush 'Caleb' VANILLA SPICE', Summer Sweet 'Caleb' VANILLA SPICE', Summersweet 'Caleb' VANILLA SPICE'

Clethra alnifolia 'Caleb' VANILLA SPICE' (Summersweet) is a compact, slowly spreading, deciduous shrub boasting bottlebrush spikes of extremely fragrant white flowers which bloom for 4-6 weeks in mid to late summer. Each individual flower is quite large, 10-12 in. long (25-30 cm), roughly double the size of other varieties. Opening from bottom to top, they are very attractive to bees, butterflies and other pollinators, at a time of the year when there's not a wealth of nectars to choose from. The flowers give way to spikes of dark brown fruits which persist into winter, providing continuing interest. The serrated, glossy, dark green foliage warms up to golden-yellow in fall. One of its most attractive characteristics is to produce great blooms in shady locations. A popular Summersweet selection because it is more compact and its flowers are larger than the species.

- Densely-branched, rounded, this summer-flowering shrub spreads slowly by suckers and typically grows 3-6 ft. tall and wide (90-180 cm).
- A full sun to part shade lover, this plant is best grown in average, medium to wet, acidic, sandy soils. Tolerates full shade. Do not let the soil dry out. Clay and wet soil tolerant.
- Flowers attract butterflies and hummingbirds. *Clethra alnifolia* is rarely bothered by deer.
- Mass in mixed shrub borders for dramatic summer blooms. Great flowering shrub for shade or woodland gardens or along stream banks or ponds. May be naturalized in cottage gardens, wild gardens or naturalized areas.
- This plant enjoys an excellent resistance to insects and diseases.
- Promptly remove root suckers unless naturalized look is desired
- This shrub flowers on new wood, so pruning for shape is best done in spring.
- Propagate by cuttings.

We would be happy to further address any questions with the Commission.
Thank you for your time.

Lindsey and Tim Geitz

