

INLAND WETLANDS
COMMISSION
Telephone (203) 563-0180
Fax (203) 563-0284



TOWN HALL
238 Danbury Road
Wilton, Connecticut 06897

APPLICATION FOR A MINOR REGULATED ACTIVITY

For Office Use Only:

Filing Fee \$ _____	WET# _____
Date of Submission _____	Wilton Land Record Map# _____
Date of Acceptance _____	Volume # _____ Page # _____
	Assessor's Map # _____ Lot# _____

APPLICANT INFORMATION:

Applicant <u>Kelly L. Morron</u>	Agent (if applicable) _____
Address <u>846 Ridgefield Road</u>	Address _____
Telephone <u>(203) 210-5445</u>	Telephone _____
Email <u>morganhouse@optonline.net</u>	Email _____

PROPERTY INFORMATION:

Property Address <u>846 Ridgefield Road</u>	Site Acreage <u>Property is 3.05 acres</u>
Acres of altered Wetlands On-Site <u>No altered wetlands</u>	Cu. Yds. of Material Excavated <u>500 gallons where indicated</u>
Linear Feet of Watercourse <u>Don't know, it comes and goes</u>	Cu. Yds. of Material to be Deposited <u>120 gal to fill where current tank is</u>
Linear Feet of Open Water <u>Don't know, gets wetter and less wet</u>	Acres of altered upland buffer _____
Sq. Ft. of proposed and/or altered impervious coverage _____	Sq. Ft. of disturbed land in regulated area _____

APPLICATION REQUIREMENTS:

Is The Site Within a Public Water Supply
Watershed Boundary? NO xx YES* _____

Is The Site Within 500 Feet of a Town Boundary?
NO xx YES* _____

* If the answer is yes, then the applicant is responsible for notifying the appropriate water authority and/or adjoining community's Wetlands Department. Instructions for notification are available at the office of the commission.

Project Description and Purpose: I am applying for a permit to bury a new (other than preexisting) propane tank in conjunction with with a generator, for which application for permit has been filed (4/29/2021).

In addition, the applicant shall provide three (3) collated paper copies of the following information as well as an electronic submission via email to mike.conklin@wiltonct.org & elizabeth.larkin@wiltonct.org **

- () NA A. Written consent from the owner authorizing the agent to act on his/her behalf
- (X) B. A Location Map at a scale of 1" = 800'
- (X) C. **A Site Plan showing existing and proposed features** Site for proposed tank says "propane tank" with oval
- (X) D. Names and addresses of adjoining property owners

****Application materials shall be collated and copies of documents more than two pages in length shall be double sided.**

See Section 7 of the Wetlands and Watercourses Regulations of the Town of Wilton for a more detailed description of applications requirements.

The Applicant or his/her agent certifies that he is familiar with the information provided in this application and is aware of the penalties for obtaining a permit through deception, inaccurate or misleading information.

By signing this application, permission is hereby given to necessary and proper inspections of the subject property by the Commissioners and designated agents of the Commission or consultants to the Commission, at reasonable times, both before and after a final decision has been rendered.

Applicant's Signature: Kelly L. Morron Date: May 7, 2021

Agent's Signature (if applicable) _____ Date: _____

Morrison Permit attachment
Location of 846 Ridgefield Road is in orange color: Corner of Millstone and Ridgefield Road

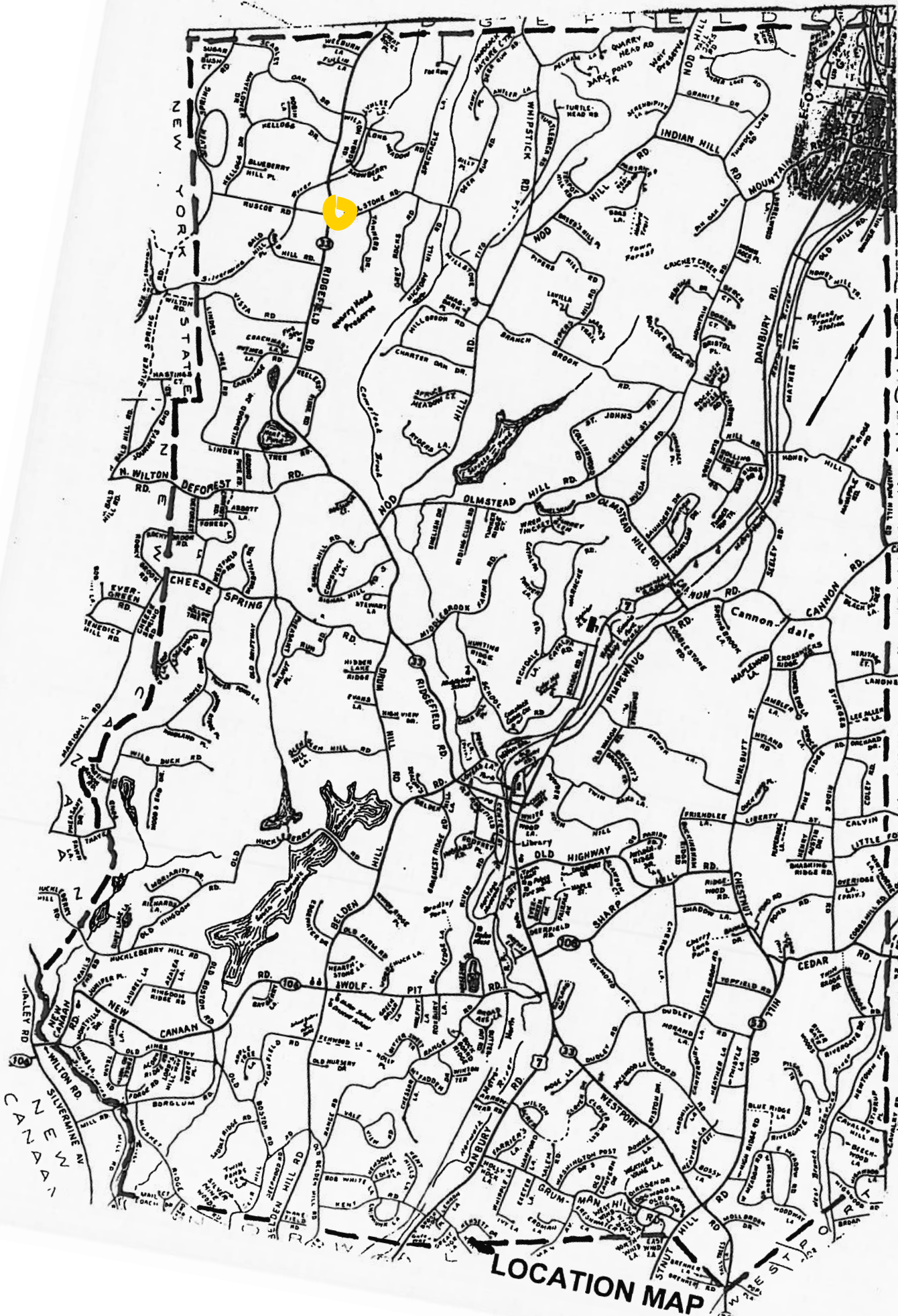

ACEMENT AREA
18" HIGH CONCRETE GALLERY
2" OF 1" BROKEN STONE. SET
S 12" IN GRADE

LAND USE APPROVALS
HEALTH
WETLANDS
EROSION
ZONING

EDGE OF FLAGGED WETLANDS

SITE BENCHMARK
GARAGE SLAB
ELEVATION 100.00

APPROXIMATE EXTENT OF FILL REQUIRED
FOR SYSTEM INSTALLATION

PLAN NOTE:
BOXED " " ITEM
AT THE TIME OF T

THERE SHALL BE NO FOOTING,
STORM, OR GROUNDWATER DRAINS
WITHIN 25' OF THE EXISTING
WELL.

FINAL PLAN
RIDGEFIELD ROAD
Proposed Replacement
Septic System Plan

FILE COPY

WILTON DEPT OF
ENVIRONMENTAL HEALTH
APPROVED BY
DATE

APPROXIMATE LOCATION OF
EXISTING SEPTIC TANK-EXACT
LOCATION TO BE FIELD VERIFIED
AND 75' SETBACK SHALL BE
MAINTAINED TO THE EXISTING
WELL. EXISTING TANK SHALL BE
PUMPED DRY AND CRUSHED IN
PLACE AND NEW TANK INSTALLED
AS SHOWN IF REQUIRED.

IN THE EVENT THAT THIS SYSTEM IS
IMPLEMENTED, THE AREA OF THE SYSTEM
UNDER THE DRIVEWAY SHALL BE TESTED
AND PERCOLATION TESTS PERFORMED IN
ORDER TO VERIFY UNDERLYING SOIL
CHARACTERISTICS.
GALLERIES UNDER DRIVEWAY AND WITHIN
10' OF DRIVEWAY SHALL HAVE H-20
LOADING SPECS.

LEGEND

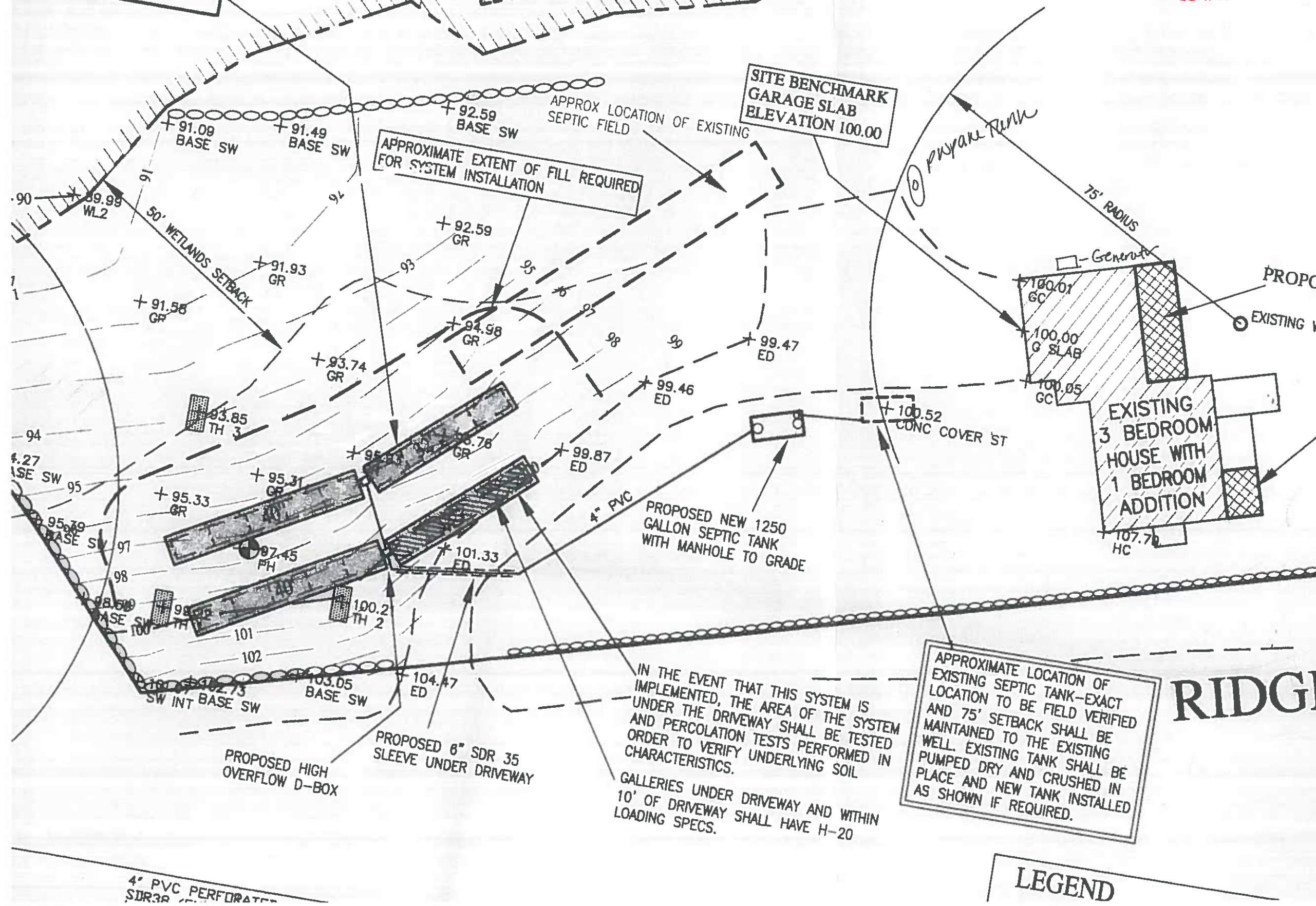

107-6 OLSON THOMAS B 831 RIDGEFIELD RD WILTON CT 06897	107-7 ORRICO THOMAS F 9 RUSCOE RD WILTON CT 06897	107-9 SHERK ALEXANDER B & KATHRYN F (SV) 6 RUSCOE RD WILTON CT 06897
107-10 KULKE DEANNE 860 RIDGEFIELD RD WILTON CT 06897	107-11 MORRON KELLY L 846 RIDGEFIELD RD WILTON CT 06897	107-12 VEHSLAGE STEPHEN T JR 24 MILLSTONE RD WILTON CT 06897
107-24 BROWN CHRISTOPHER WALLACE & 25 MILLSTONE RD WILTON CT 06897	107-25 KOBYRA PAUL & STEPHANIE 31 MILLSTONE RD WILTON CT 06897	107-26 MABLEY FRANK H 15 MILLSTONE RD WILTON CT 06897
107-27 DILETTUSO JEROME T & 11 MILLSTONE RD WILTON CT 06897	107-28 HORGAN PATRICK & SUSAN BEDSOW 3 MILLSTONE RD WILTON CT 06897	