

INLAND WETLANDS  
COMMISSION  
Telephone (203) 563-0180  
Fax (203) 563-0284



TOWN HALL  
238 Danbury Road  
Wilton, Connecticut 06897

*after-the-fact*  
**APPLICATION FOR A MINOR REGULATED ACTIVITY**

**For Office Use Only:**

Filing Fee \$ 360.00  
Date of Submission 4-19-21  
Date of Acceptance N/A

WET# 2695  
Wilton Land Record Map# 5057  
Volume # 1254 Page # 39  
Assessor's Map # 137 Lot# 43-3

**APPLICANT INFORMATION:**

Applicant Lisa Rosenthal  
Address 14 Trails End Rd  
Wilton, CT 06897  
Telephone 203-563-9858  
Email Lisbr@optonline.net

Agent (if applicable) Tony Baucher  
Address 140 Oxford Rd  
Oxford, CT 06457  
Telephone 203-800-6347  
Email bauchertony@rocketmail.com

**PROPERTY INFORMATION:**

Property Address 14 Trails End Rd  
Acres of altered Wetlands On-Site 0  
Linear Feet of Watercourse 280  
Linear Feet of Open Water 280  
Sq. Ft. of proposed and/or altered impervious coverage 62 57.14

Site Acreage 3.07  
Cu. Yds. of Material Excavated 0  
Cu. Yds. of Material to be Deposited 0  
Acres of altered upland buffer 62 SA 1.001  
Sq. Ft. of disturbed land in regulated area 62

**APPLICATION REQUIREMENTS:**

Is The Site Within a Public Water Supply  
Watershed Boundary? NO ☒ YES\* ☐

Is The Site Within 500 Feet of a Town Boundary?  
NO ☒ YES\* ☐

\* If the answer is yes, then the applicant is responsible for notifying the appropriate water authority and/or adjoining community's Wetlands Department. Instructions for notification are available at the office of the commission.

Page 2 Application for a Minor Regulated Activity

Project Description and Purpose: Install ① 35 kW propane  
powered generator and ① 500 gallon above  
ground propane tank approximately 10 ft in  
wetland

In addition, the applicant shall provide three (3) collated paper copies of the following information as well as an electronic submission via email to [mike.conklin@wiltonct.org](mailto:mike.conklin@wiltonct.org) & [elizabeth.larkin@wiltonct.org](mailto:elizabeth.larkin@wiltonct.org) \*\*

- ☐ A. Written consent from the owner authorizing the agent to act on his/her behalf ✓
- ☐ B. A Location Map at a scale of 1" = 800' 1-
- ☐ C. A Site Plan showing existing and proposed features ✓
- ☐ D. Names and addresses of adjoining property owners ✓

**\*\*Application materials shall be collated and copies of documents more than two pages in length shall be double sided.**

See Section 7 of the Wetlands and Watercourses Regulations of the Town of Wilton for a more detailed description of applications requirements.

The Applicant or his/her agent certifies that he is familiar with the information provided in this application and is aware of the penalties for obtaining a permit through deception, inaccurate or misleading information.

By signing this application, permission is hereby given to necessary and proper inspections of the subject property by the Commissioners and designated agents of the Commission or consultants to the Commission, at reasonable times, both before and after a final decision has been rendered.

Applicant's Signature: \_\_\_\_\_ Date: \_\_\_\_\_

Agent's Signature (if applicable)  Date: 4-19-2021

## 14 Trails End Rd permits

From: Lisa Rosenthal (lisbr@optonline.net)

To: bouchertony@rocketmail.com

Date: Friday, April 16, 2021, 4:13 PM EDT

To whom it may concern,  
I give Tony Boucher from A & J Generator and Equipment LLC, permission to pull the permits on our property at 14 Trails End Rd in Wilton, Ct.  
Thank you,  
Lisa and Norm Rosenthal

Sent from my iPad

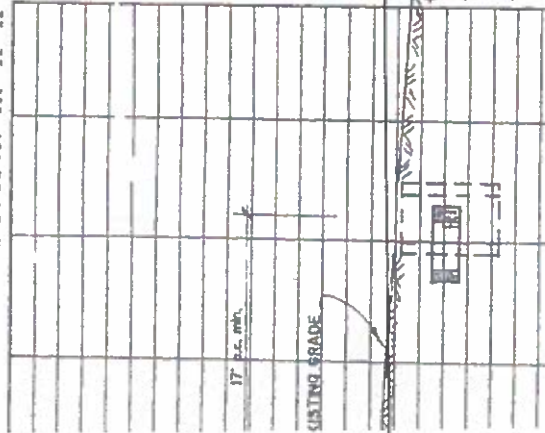



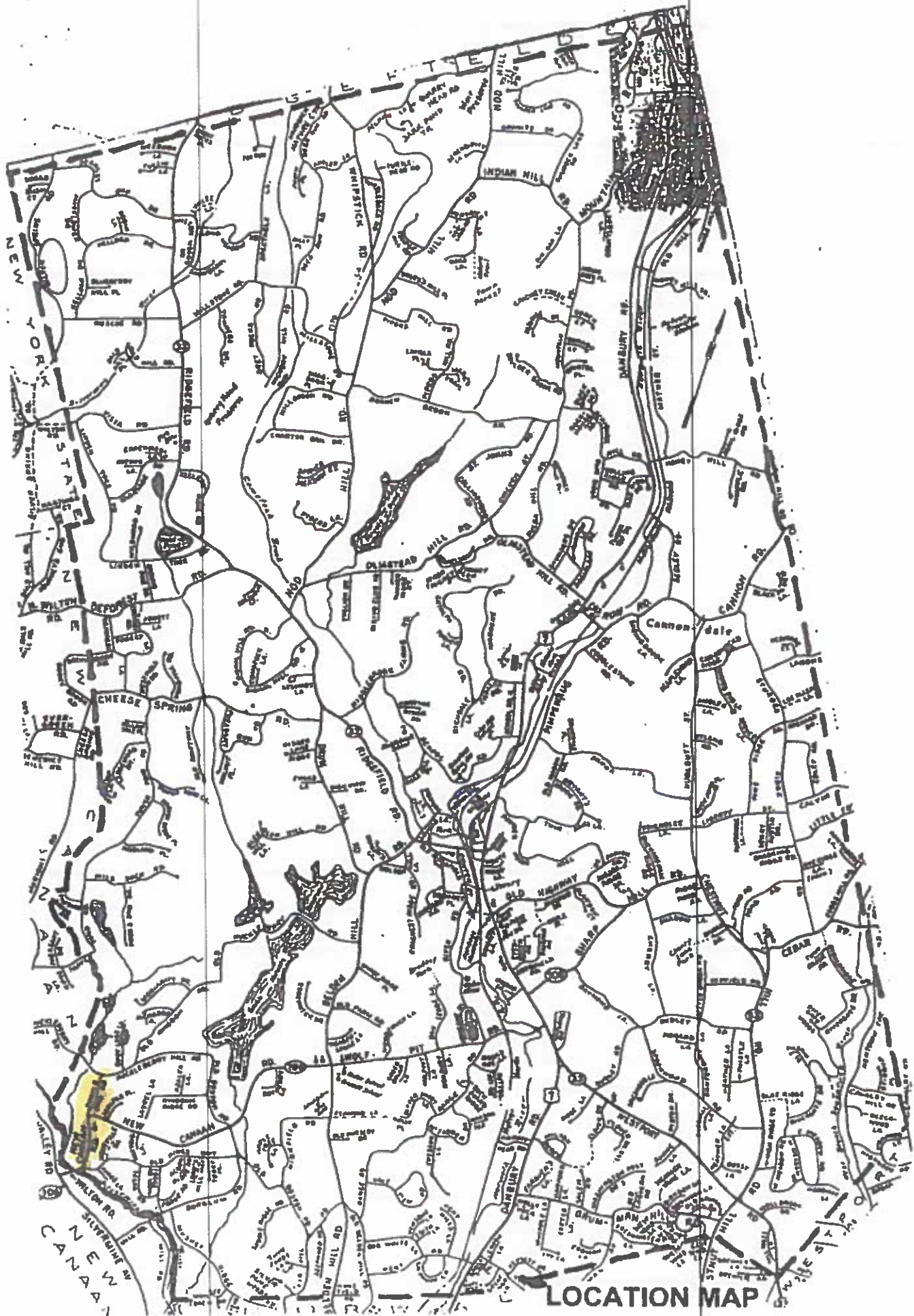

137-32  
KENNEDY MARGARET E  
291 NEW CANAAN RD  
WILTON CT 06897

137-35  
WILTON QUAKER MEETING OF  
317 NEW CANAAN RD  
WILTON CT 06897

137-43-3  
ROSENTHAL NORMAN S & LISA  
14 TRAILS END RD  
WILTON CT 06897

137-50  
CAPALBO CHRISTOPHER M & AMY L  
20 JUNIPER PL  
WILTON CT 06897

137-33  
MACALUSO JOSEPH J &  
293 NEW CANAAN RD  
WILTON CT 06897

137-37-2  
SOUND MANAGEMENT GROUP INC  
14 CENTERVIEW RD  
WOODBIDGE CT 06525

137-43-4  
CREVELING KEITH S & ILINCA D  
18 TRAILS END RD  
WILTON CT 06897

137-51  
LING XUEHAI  
8 JUNIPER PL  
WILTON CT 06897

137-44  
GARDINER KEVIN T & MAURICIA L  
295 NEW CANAAN RD  
WILTON CT 06897

137-43  
SPROLE FRANK JARED & BETH BRIDGE  
16 TRAILS END RD  
WILTON CT 06897

137-44  
FLANAGAN EUGENE L III & SUSAN J  
19 JUNIPER PL  
WILTON CT 06897