

# WILTON CAMPUS PROPOSED PHOTOMETRIC PLAN

SCALE: NTS

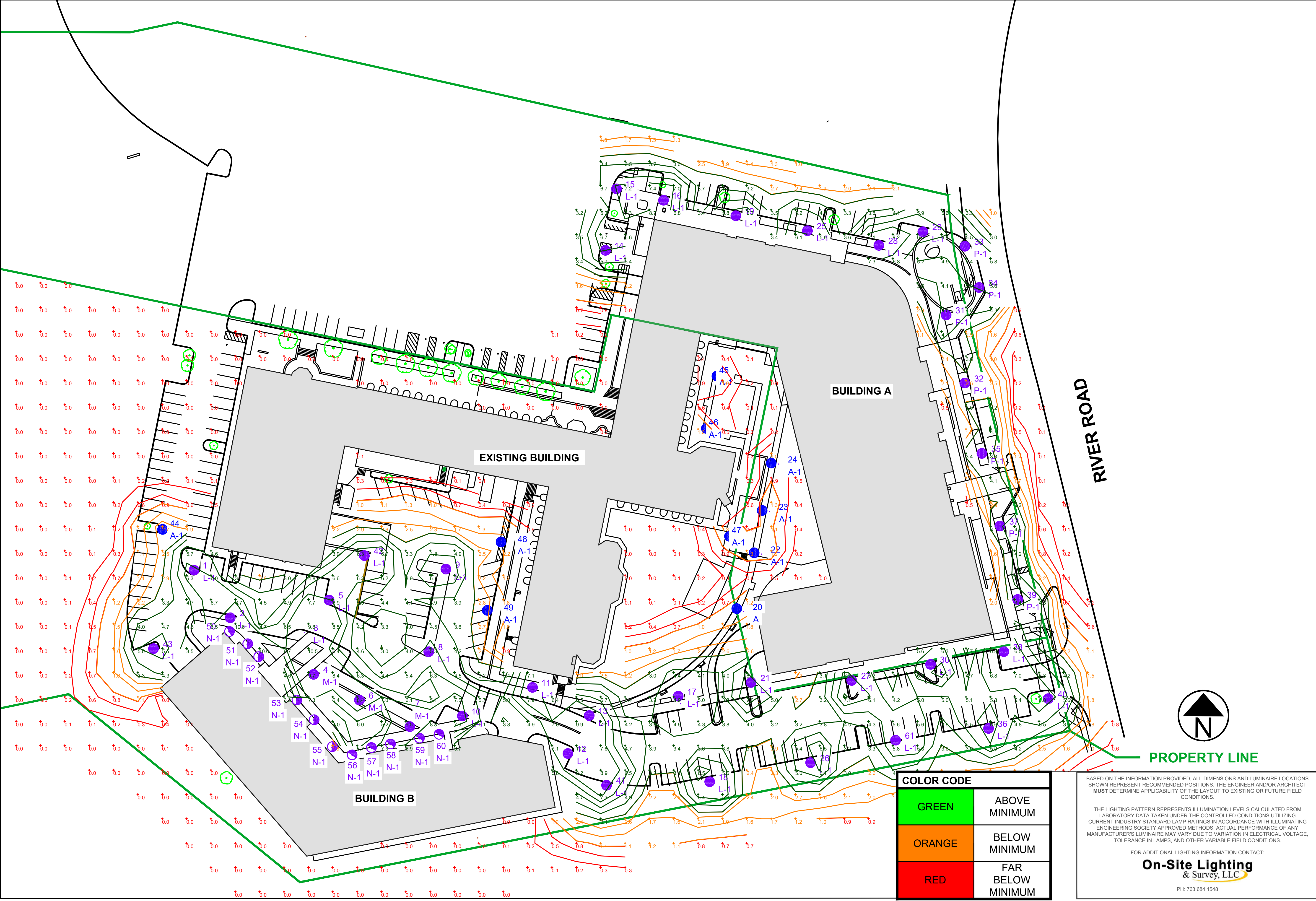

On-Site Lighting  
& Survey, LLC

1111 HIGHWAY 25 NORTH  
SUITE 201  
BUFFALO MN 55313  
  
PH:763.684.1548  
FAX:763.682.9048

**KIMCO**  
REALTY

**WILTON  
CAMPUS**  
  
15 RIVER ROAD  
WILTON, CT 06897

#	DATE	INIT	DESCRIPTION
1	04.08.2024	DMW	ADDED BOLLARDS, POLE LOCATIONS
2	04.16.2024	DMW	SPECIFICATION CHANGE

**PROPOSED  
PHOTOMETRIC  
PLAN**

PROJECT #  
**116910**

DESIGN LEVEL	04.04.2024
AGI	<b>3</b>
CAD	D.M.WARZECKA
SHEET#	<b>SL200</b>
REV#	<b>2</b>

COLOR CODE	
GREEN	ABOVE MINIMUM
ORANGE	BELOW MINIMUM
RED	FAR BELOW MINIMUM

BASED ON THE INFORMATION PROVIDED, ALL DIMENSIONS AND LUMINAIRE LOCATIONS SHOWN REPRESENT RECOMMENDED POSITIONS. THE ENGINEER AND/OR ARCHITECT MUST DETERMINE APPLICABILITY OF THE LAYOUT TO EXISTING OR FUTURE FIELD CONDITIONS.

THE LIGHTING PATTERN REPRESENTS ILLUMINATION LEVELS CALCULATED FROM LABORATORY DATA TAKEN UNDER THE CONTROLLED CONDITIONS UTILIZING CURRENT INDUSTRY STANDARD LAMP RATINGS IN ACCORDANCE WITH ILLUMINATING ENGINEERING SOCIETY APPROVED METHODS. ACTUAL PERFORMANCE OF ANY MANUFACTURER'S LUMINAIRE MAY VARY DUE TO VARIATION IN ELECTRICAL VOLTAGE, TOLERANCE IN LAMPS, AND OTHER VARIABLE FIELD CONDITIONS.

FOR ADDITIONAL LIGHTING INFORMATION CONTACT:  
**On-Site Lighting  
& Survey, LLC**  
PH: 763.684.1548

# WILTON CAMPUS PROPOSED LANDSCAPE LIGHTING PLAN

SCALE: NTS

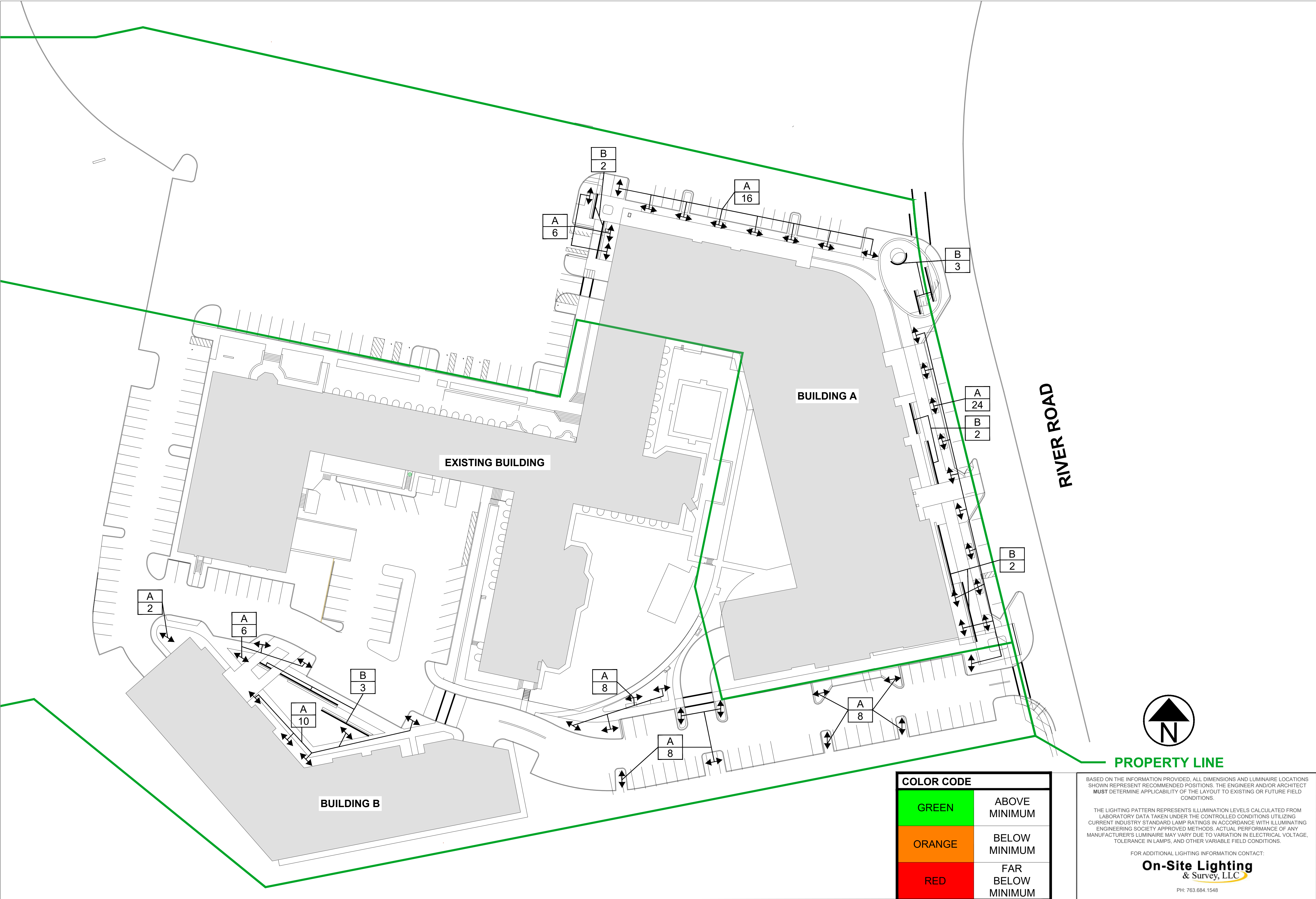

COLOR CODE	
GREEN	ABOVE MINIMUM
ORANGE	BELOW MINIMUM
RED	FAR BELOW MINIMUM

BASED ON THE INFORMATION PROVIDED, ALL DIMENSIONS AND LUMINAIRE LOCATIONS SHOWN REPRESENT RECOMMENDED POSITIONS. THE ENGINEER AND/OR ARCHITECT MUST DETERMINE APPLICABILITY OF THE LAYOUT TO EXISTING OR FUTURE FIELD CONDITIONS.

THE LIGHTING PATTERN REPRESENTS ILLUMINATION LEVELS CALCULATED FROM LABORATORY DATA TAKEN UNDER THE CONTROLLED CONDITIONS UTILIZING CURRENT INDUSTRY STANDARD LAMP RATINGS IN ACCORDANCE WITH ILLUMINATING ENGINEERING SOCIETY APPROVED METHODS. ACTUAL PERFORMANCE OF ANY MANUFACTURER'S LUMINAIRE MAY VARY DUE TO VARIATION IN ELECTRICAL VOLTAGE, TOLERANCE IN LAMPS, AND OTHER VARIABLE FIELD CONDITIONS.

FOR ADDITIONAL LIGHTING INFORMATION CONTACT:

**On-Site Lighting & Survey, LLC**  
PH: 763.684.1548

On-Site Lighting & Survey, LLC

1111 HIGHWAY 25 NORTH  
SUITE 201  
BUFFALO MN 55313  
  
PH:763.684.1548  
FAX:763.682.9048



**WILTON CAMPUS**  
  
15 RIVER ROAD  
WILTON, CT 06897

ENGINEER INFO

ENGINEER SEAL

#	DATE	INIT	DESCRIPTION
1	04.08.2024	DMW	ADDED BOLLARDS, POLE LOCATIONS
2	04.16.2024	DMW	SPECIFICATION CHANGE

**PROPOSED LANDSCAPE LIGHTING PLAN**

PROJECT #  
**116910**

DESIGN LEVEL	04.04.2024
AGI	<b>3</b>
CAD	D.M.WARZECKA
SHEET#	<b>SL201</b>
REV #:	<b>2</b>

# WILTON CAMPUS PROPOSED BUILDING MOUNTS LEVEL 1

SCALE: NTS

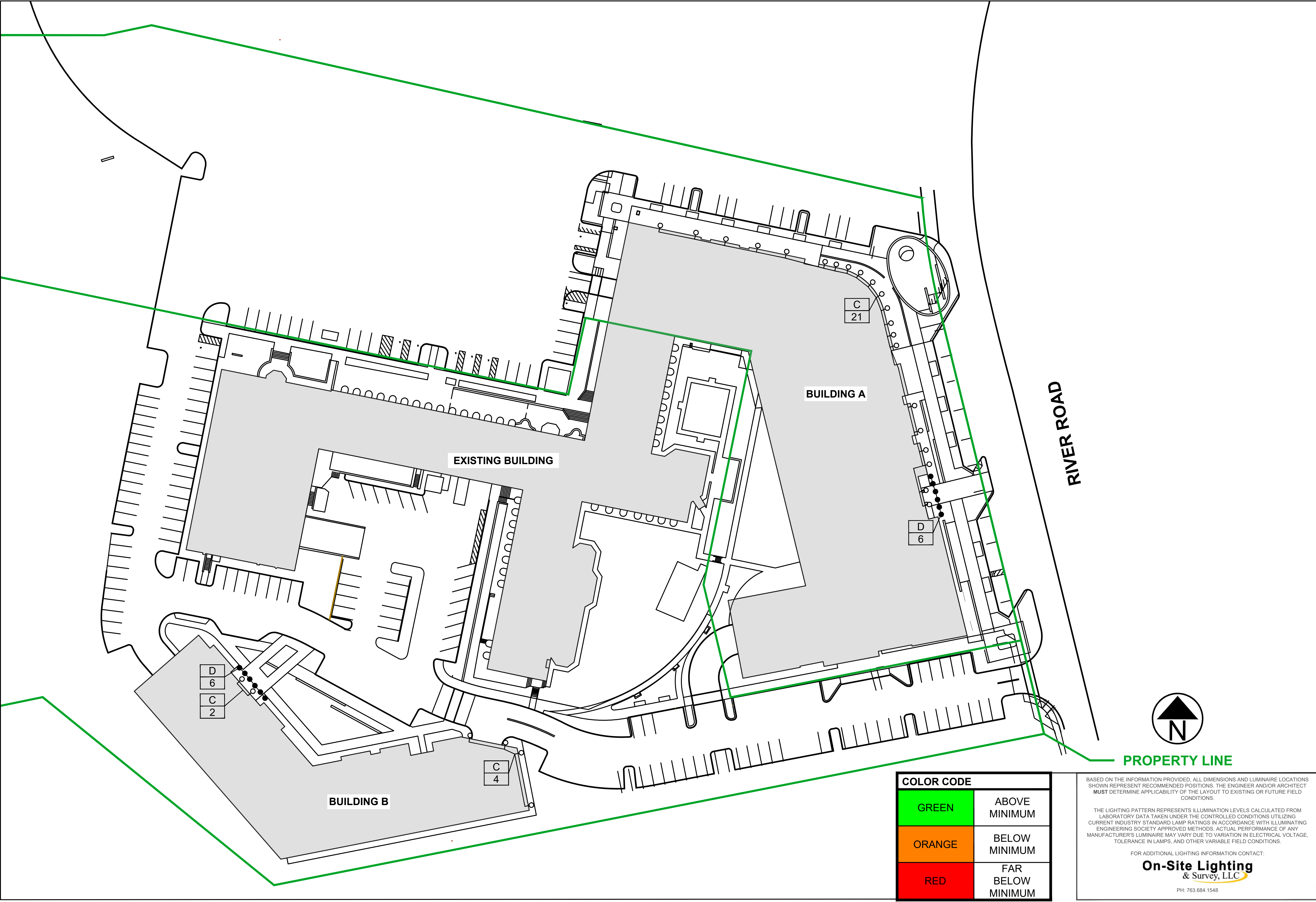

On-Site Lighting  
& Survey, LLC

1111 HIGHWAY 25 NORTH  
SUITE 201  
BUFFALO MN 55313  
PH:763.684.1548  
FAX:763.682.9048

**KIMCO**  
REALTY

**WILTON CAMPUS**  
15 RIVER ROAD  
WILTON, CT 06897

ENGINEER INFO

ENGINEER SEAL

#	DATE	INIT	DESCRIPTION
1	04.08.2024	DMW	ADDED BOLLARDS, POLE LOCATIONS
2	04.16.2024	DMW	SPECIFICATION CHANGE

**PROPOSED BUILDING MOUNT PLAN**

PROJECT #  
**116910**

04.04.2024

DESIGN LEVEL  
**3**

AGI  
D.M.WARZECKA

CAD  
D.M.WARZECKA

SHEET#  
**SL202**

REV#  
**2**

# WILTON CAMPUS PROPOSED BUILDING MOUNTS LEVEL 2

SCALE: NTS

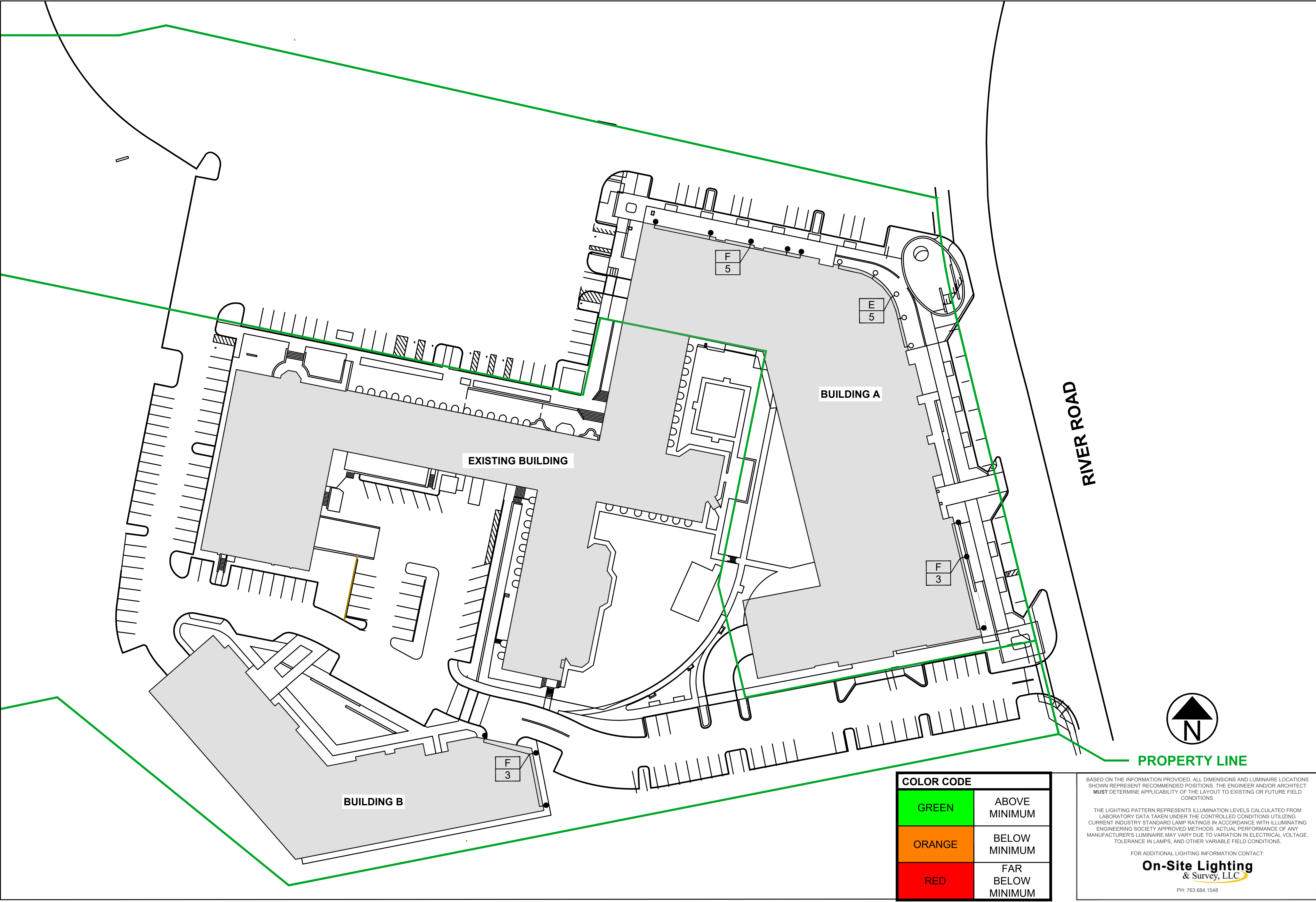

On-Site Lighting  
& Survey, LLC

1111 HIGHWAY 25 NORTH  
SUITE 201  
BUFFALO MN 55313  
  
PH:763.684.1548  
FAX:763.682.9048

**KIMCO**  
REALTY

**WILTON  
CAMPUS**  
  
15 RIVER ROAD  
WILTON, CT 06897

ENGINEER INFO

ENGINEER SEAL

#	DATE	INIT	DESCRIPTION
1	04.08.2024	DMW	ADDED BOLLARDS, POLE LOCATIONS
2	04.16.2024	DMW	SPECIFICATION CHANGE

**PROPOSED  
BUILDING  
MOUNT PLAN**

PROJECT #  
**116910**

DESIGN LEVEL	04.04.2024
AGI	<b>3</b>
CAD	D.M.WARZECKA
SHEET#	<b>SL203</b>
REV #:	<b>2</b>

BASED ON THE INFORMATION PROVIDED, ALL DIMENSIONS AND LUMINAIRE LOCATIONS SHOWN REPRESENT RECOMMENDED POSITIONS. THE ENGINEER AND/OR ARCHITECT MUST DETERMINE APPLICABILITY OF THE LAYOUT TO EXISTING OR FUTURE FIELD CONDITIONS.

THE LIGHTING PATTERN REPRESENTS ILLUMINATION LEVELS CALCULATED FROM LABORATORY DATA TAKEN UNDER THE CONTROLLED CONDITIONS UTILIZING CURRENT INDUSTRY STANDARD LAMP RATINGS IN ACCORDANCE WITH ILLUMINATING ENGINEERING SOCIETY APPROVED METHODS. ACTUAL PERFORMANCE OF ANY MANUFACTURER'S LUMINAIRE MAY VARY DUE TO VARIATION IN ELECTRICAL VOLTAGE, TOLERANCE IN LAMPS, AND OTHER VARIABLE FIELD CONDITIONS.

FOR ADDITIONAL LIGHTING INFORMATION CONTACT:  
**On-Site Lighting  
& Survey, LLC**  
PH: 763.684.1548

# WILTON CAMPUS PROPOSED BUILDING MOUNTS LEVEL 3

SCALE: NTS

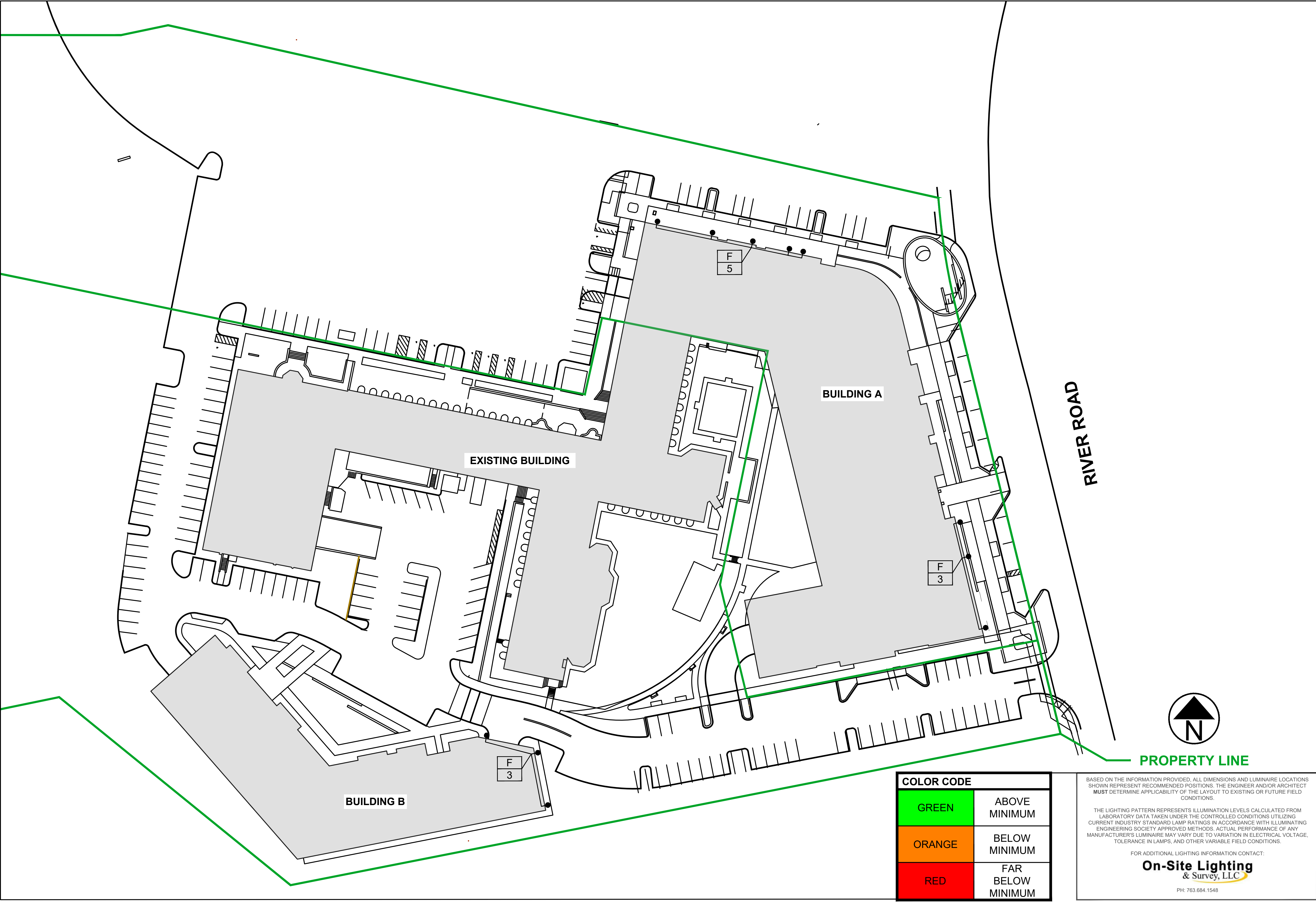

On-Site Lighting  
& Survey, LLC

1111 HIGHWAY 25 NORTH  
SUITE 201  
BUFFALO MN 55313  
  
PH:763.684.1548  
FAX:763.682.9048

**KIMCO**  
REALTY

**WILTON  
CAMPUS**  
  
15 RIVER ROAD  
WILTON, CT 06897

ENGINEER INFO

ENGINEER SEAL

#	DATE	INIT	DESCRIPTION
1	04.08.2024	DMW	ADDED BOLLARDS, POLE LOCATIONS
2	04.16.2024	DMW	SPECIFICATION CHANGE

**PROPOSED  
BUILDING  
MOUNT PLAN**

PROJECT #  
**116910**

DESIGN LEVEL	04.04.2024
AGI	<b>3</b>
CAD	D.M.WARZECKA
SHEET#	<b>SL204</b>
REV #:	<b>2</b>

BASED ON THE INFORMATION PROVIDED, ALL DIMENSIONS AND LUMINAIRE LOCATIONS SHOWN REPRESENT RECOMMENDED POSITIONS. THE ENGINEER AND/OR ARCHITECT MUST DETERMINE APPLICABILITY OF THE LAYOUT TO EXISTING OR FUTURE FIELD CONDITIONS.

THE LIGHTING PATTERN REPRESENTS ILLUMINATION LEVELS CALCULATED FROM LABORATORY DATA TAKEN UNDER THE CONTROLLED CONDITIONS UTILIZING CURRENT INDUSTRY STANDARD LAMP RATINGS IN ACCORDANCE WITH ILLUMINATING ENGINEERING SOCIETY APPROVED METHODS. ACTUAL PERFORMANCE OF ANY MANUFACTURER'S LUMINAIRE MAY VARY DUE TO VARIATION IN ELECTRICAL VOLTAGE, TOLERANCE IN LAMPS, AND OTHER VARIABLE FIELD CONDITIONS.

FOR ADDITIONAL LIGHTING INFORMATION CONTACT:  
**On-Site Lighting  
& Survey, LLC**  
PH: 763.684.1548

# WILTON CAMPUS PROPOSED BUILDING MOUNTS LEVEL 4

SCALE: NTS

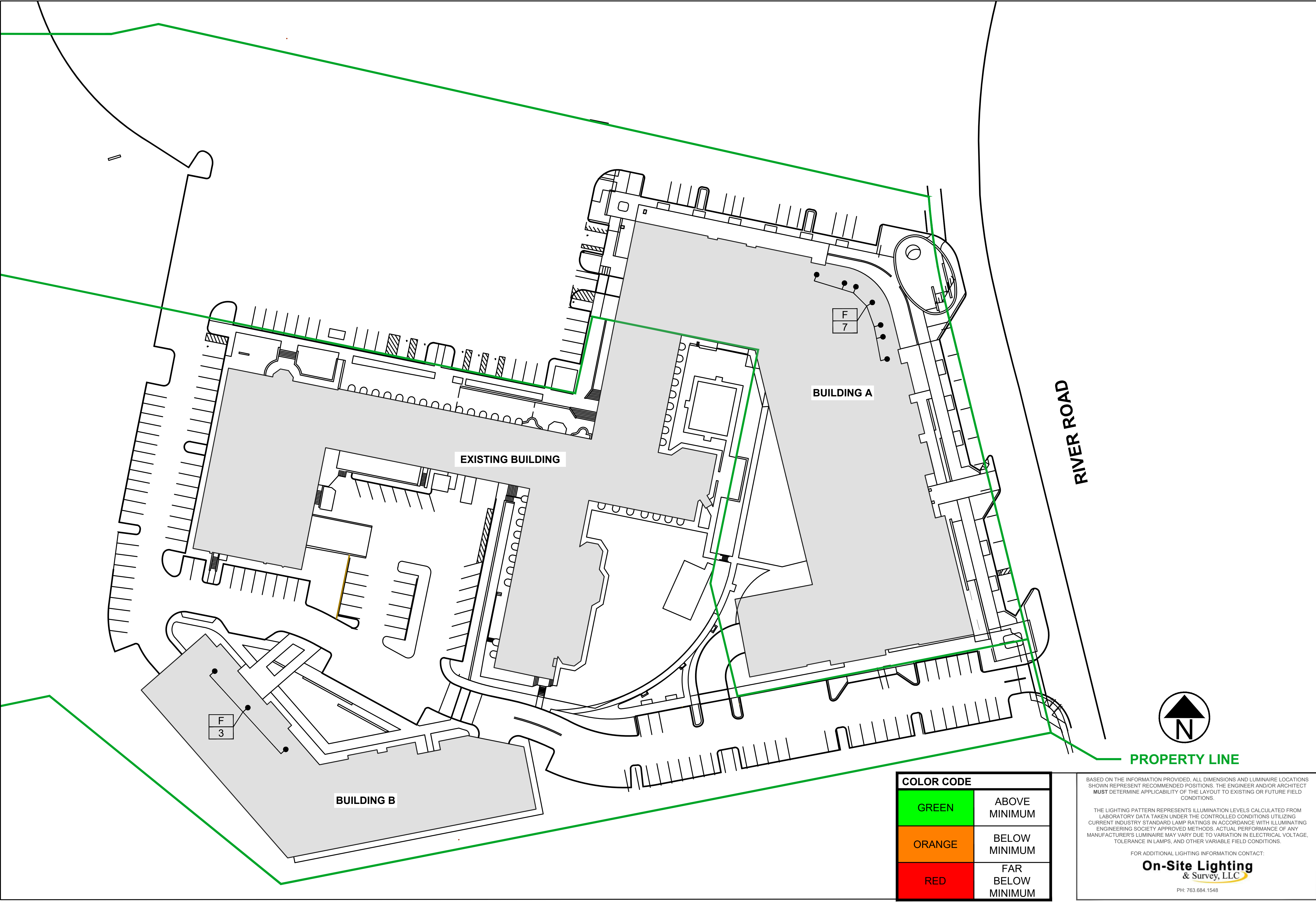

On-Site Lighting  
& Survey, LLC

1111 HIGHWAY 25 NORTH  
SUITE 201  
BUFFALO MN 55313  
  
PH:763.684.1548  
FAX:763.682.9048



WILTON  
CAMPUS  
  
15 RIVER ROAD  
WILTON, CT 06897

ENGINEER INFO

ENGINEER SEAL

#	DATE	INIT	DESCRIPTION
1	04.08.2024	DMW	ADDED BOLLARDS, POLE LOCATIONS
2	04.16.2024	DMW	SPECIFICATION CHANGE

PROPOSED  
BUILDING  
MOUNT PLAN

PROJECT #  
  
116910

04.04.2024

DESIGN  
LEVEL  
  
3

AGI  
  
D.M.WARZECKA

CAD  
  
D.M.WARZECKA

SHEET#:  
  
SL205

REV #:  
  
2

BASED ON THE INFORMATION PROVIDED, ALL DIMENSIONS AND LUMINAIRE LOCATIONS SHOWN REPRESENT RECOMMENDED POSITIONS. THE ENGINEER AND/OR ARCHITECT MUST DETERMINE APPLICABILITY OF THE LAYOUT TO EXISTING OR FUTURE FIELD CONDITIONS.

THE LIGHTING PATTERN REPRESENTS ILLUMINATION LEVELS CALCULATED FROM LABORATORY DATA TAKEN UNDER THE CONTROLLED CONDITIONS UTILIZING CURRENT INDUSTRY STANDARD LAMP RATINGS IN ACCORDANCE WITH ILLUMINATING ENGINEERING SOCIETY APPROVED METHODS. ACTUAL PERFORMANCE OF ANY MANUFACTURER'S LUMINAIRE MAY VARY DUE TO VARIATION IN ELECTRICAL VOLTAGE, TOLERANCE IN LAMPS, AND OTHER VARIABLE FIELD CONDITIONS.

FOR ADDITIONAL LIGHTING INFORMATION CONTACT:

On-Site Lighting  
& Survey, LLC

PH: 763.684.1548

# WILTON CAMPUS PROPOSED BUILDING MOUNTS LEVEL 5

SCALE: NTS

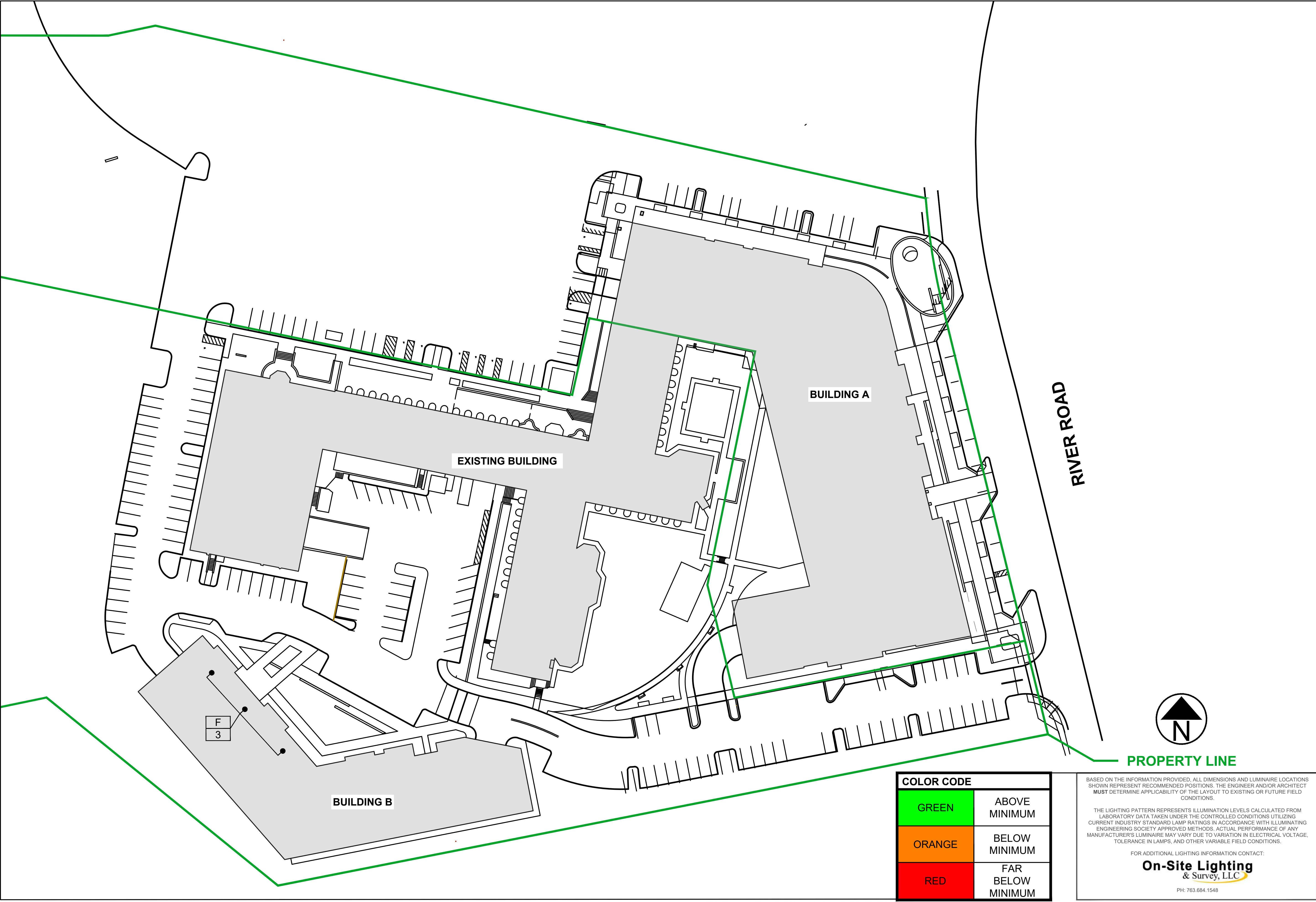

On-Site Lighting  
& Survey, LLC

1111 HIGHWAY 25 NORTH  
SUITE 201  
BUFFALO MN 55313  
PH:763.684.1548  
FAX:763.682.9048

**KIMCO**  
REALTY

**WILTON CAMPUS**  
15 RIVER ROAD  
WILTON, CT 06897

**ENGINEER INFO**

**ENGINEER SEAL**

#	DATE	INIT	DESCRIPTION
1	04.08.2024	DMW	ADDED BOLLARDS, POLE LOCATIONS
2	04.16.2024	DMW	SPECIFICATION CHANGE

**PROPOSED BUILDING MOUNT PLAN**

**PROJECT #**  
**116910**

**DESIGN LEVEL**  
**04.04.2024**

**AGI**  
**D.M.WARZECKA**

**CAD**  
**D.M.WARZECKA**

**SHEET#:** **SL206** **REV#:** **2**

# WILTON CAMPUS PROPOSED SCHEDULES

On-Site Lighting  
& Survey, LLC

1111 HIGHWAY 25 NORTH  
SUITE 201  
BUFFALO MN 55313  
  
PH:763.684.1548  
FAX:763.682.9048



WILTON  
CAMPUS  
  
15 RIVER ROAD  
WILTON, CT 06897







#	DATE	INIT	DESCRIPTION
1	04.08.2024	DMW	ADDED BOLLARDS, POLE LOCATIONS
2	04.16.2024	DMW	SPECIFICATION CHANGE

PROPOSED  
SCHEDULES

PROJECT #  
  
116910

DESIGN LEVEL	04.04.2024
AGI	3
CAD	D.M.WARZECKA
SHEET#:	D.M.WARZECKA
REV #:	SL207 2

BUILDING MOUNT SCHEDULE PROPOSED			
QTY	LABEL	MANUFACTURER	CATALOG NUMBER/ DESCRIPTION
88	A	COOPER LIGHTING	TCRS5S-BK
12	B	BL LIGHTING	BL flexFORM D1-4000k-IP68-2811
27	C	CONTECH LIGHTING	CYL6340K-X-WXPL-B
12	D	GREEN CREATIVE	LES9040-X-MD-WET-BL
5	E	CONTECH LIGHTING	CYL8240K-X-UDXWW-B
35	F	CONTECH LIGHTING	CY3T140K-X-AWXS-B

LUMINAIRE SCHEDULE						
Symbol	Qty	Label	Arrangement	LLF	Description	BUG Rating
	10	A-1	SINGLE	0.600	EXISTING 100W MH T-5 20'-0 MTG HT	B1-U3-G1
	30	L-1	SINGLE	0.900	NEW BASE, POLE, & AREA FIXT 191W LED T5W 20'-0 MTG HT (4000K/25984 LUMENS) LSI MPP-LED-25L-SIL-5W-40-70CRI	B5-U4-G3
	3	M-1	SINGLE	0.900	NEW BASE, POLE, & AREA FIXT 149W LED T5W 20'-0 MTG HT (4000K/10685 LUMENS) LSI MPP-LED-20L-SIL-5W-40-70CRI	B4-U4-G3
	11	N-1	SINGLE	0.900	NEW LOCATION BOLLARD 29W LED 3'-8 MTG HT (4000K/2320 LUMENS) LSI MRB-LED-30L-ACR-A-40	B1-U2-G1
	7	P-1	SINGLE	0.900	NEW BASE, POLE, & AREA FIXT 67W LED T2 20'-0 MTG HT (4000K/10685 LUMENS) LSI MPP-LED-10L-SIL-2-40-70CRI	B2-U3-G2

CALCULATION SUMMARY							
Label	Avg	Max	Min	Avg/Min	Max/Min	# Pts	%PtsRange
SITE AT GRADE	1.97	10.6	0.0	N.A.	N.A.	880	N.A.
BUILDING A PARKING	3.60	8.2	0.5	7.20	16.40	28	67.9
MAIN PARKING	4.99	10.3	2.2	2.27	4.68	93	92.5

LPD AREA SUMMARY				
Label	Area	Total Watts	LPD	Perimeter
SITE	362349	6607	0.018	2912

COLOR CODE	
GREEN	ABOVE MINIMUM
ORANGE	BELOW MINIMUM
RED	FAR BELOW MINIMUM

BASED ON THE INFORMATION PROVIDED, ALL DIMENSIONS AND LUMINAIRE LOCATIONS SHOWN REPRESENT RECOMMENDED POSITIONS. THE ENGINEER AND/OR ARCHITECT MUST DETERMINE APPLICABILITY OF THE LAYOUT TO EXISTING OR FUTURE FIELD CONDITIONS.

THE LIGHTING PATTERN REPRESENTS ILLUMINATION LEVELS CALCULATED FROM LABORATORY DATA TAKEN UNDER THE CONTROLLED CONDITIONS UTILIZING CURRENT INDUSTRY STANDARD LAMP RATINGS IN ACCORDANCE WITH ILLUMINATING ENGINEERING SOCIETY APPROVED METHODS. ACTUAL PERFORMANCE OF ANY MANUFACTURER'S LUMINAIRE MAY VARY DUE TO VARIATION IN ELECTRICAL VOLTAGE, TOLERANCE IN LAMPS, AND OTHER VARIABLE FIELD CONDITIONS.

FOR ADDITIONAL LIGHTING INFORMATION CONTACT:  
**On-Site Lighting  
& Survey, LLC**  
PH: 763.684.1548

0 1 2 3 4 5 6 7 8 9 10 11 12 13 14 15

A  
B  
C  
D  
E  
F  
G  
H  
I  
J

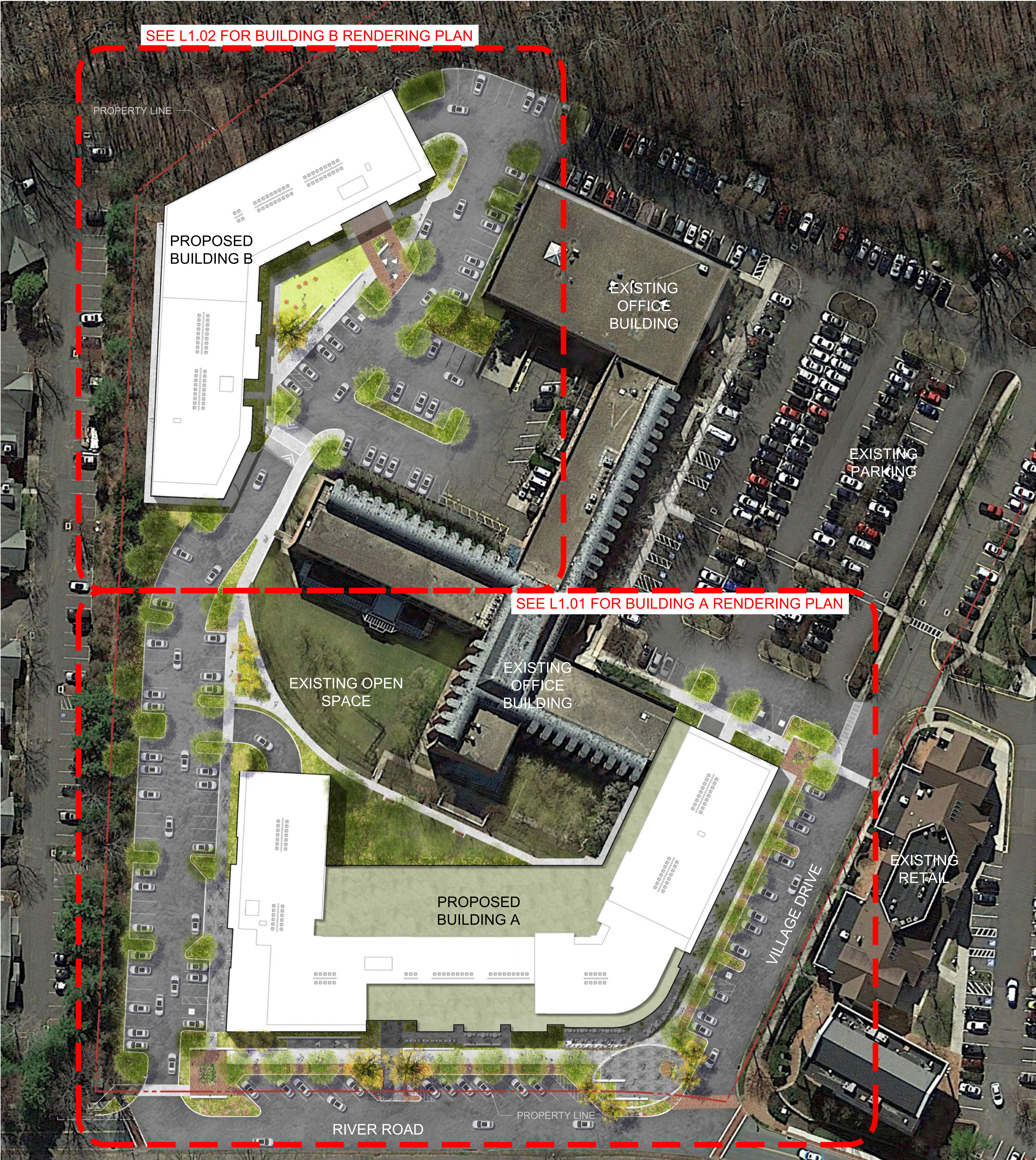

1

OVERALL SITE RENDERING

1"=40'-0"

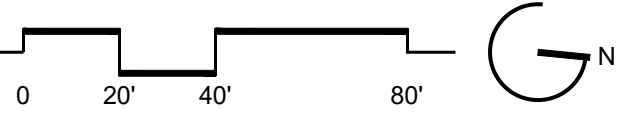

0 1 2 3 4 5 6 7 8 9 10 11 12 13 14 15

# Wilton Campus 1691

5-21 River Road, Wilton, CT

Client  
WILTON CAMPUS 1691, LLC  
15 River Road, Suite 15  
Wilton, CT 06897

Architect  
CUBE3  
56 High Street  
North Andover, MA 01845

Civil Engineer  
VHB  
1775 Greensboro Station Pl Ste 200  
McLean, VA 22102

SEAL

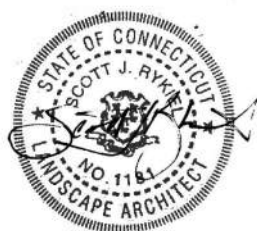

ISSUED FOR	DATE
1 VDDAC SUBMISSION	03/28/2024
2 LOCAL APPROVALS	04/23/2024

PROJECT NO.  
23018

SCALE :  
As Shown

DRAWN BY :  
SW

REVIEWED BY :  
MR

**L1.00**  
Overall Site Rendering

0 1 2 3 4 5 6 7 8 9 10 11 12 13 14 15

A  
B  
C  
D  
E  
F  
G  
H  
I  
J

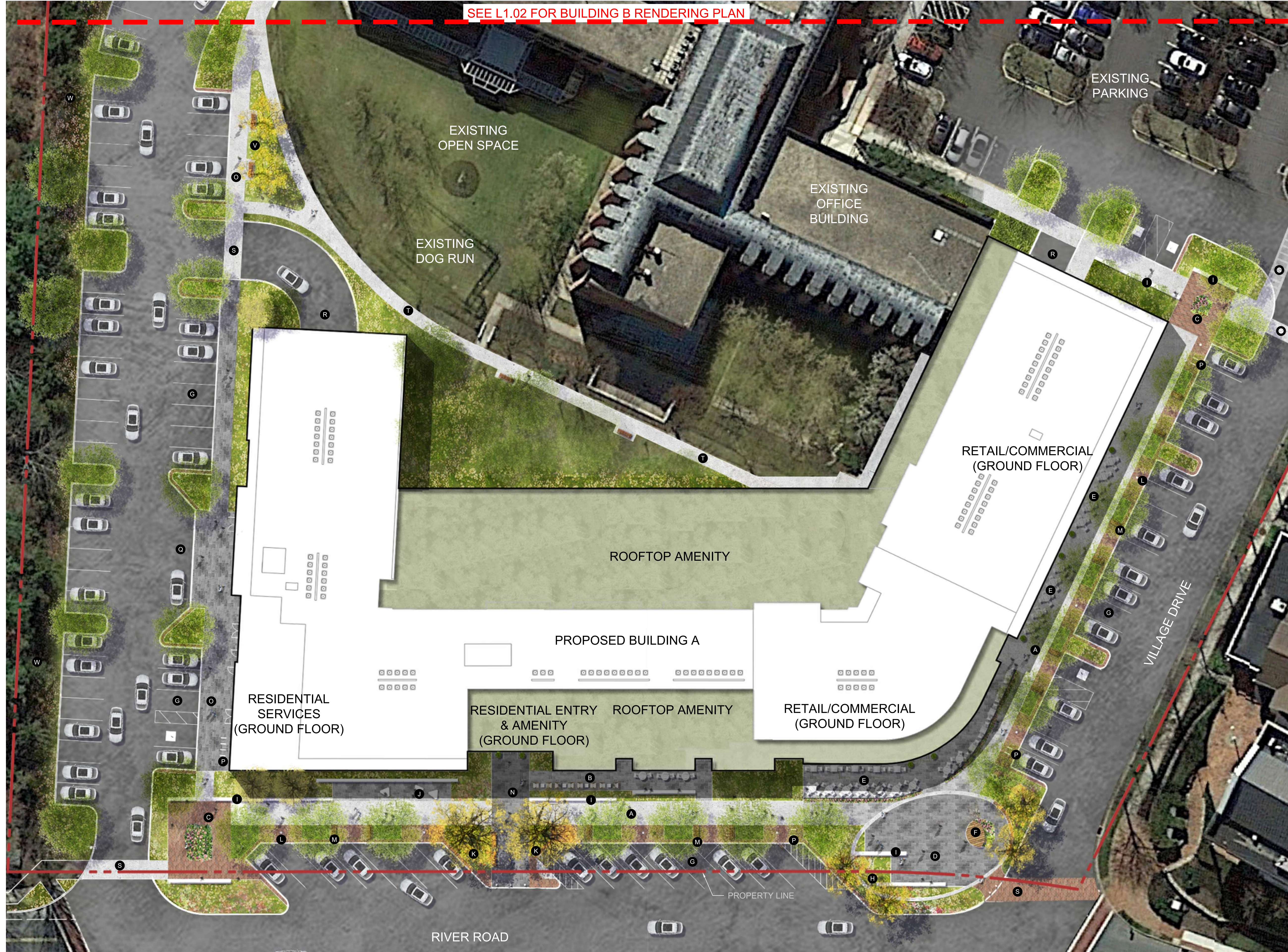

SEE L1.02 FOR BUILDING B RENDERING PLAN

EXISTING PARKING

EXISTING OFFICE BUILDING

EXISTING OPEN SPACE

EXISTING DOG RUN

RETAIL/COMMERCIAL (GROUND FLOOR)

ROOFTOP AMENITY

PROPOSED BUILDING A

RESIDENTIAL SERVICES (GROUND FLOOR)

RESIDENTIAL ENTRY & AMENITY (GROUND FLOOR)

ROOFTOP AMENITY

RETAIL/COMMERCIAL (GROUND FLOOR)

PROPERTY LINE

RIVER ROAD

VILLAGE DRIVE

1 BUILDING A RENDERING ENLARGEMENT PLAN - GROUND FLOOR

1"=20'-0"

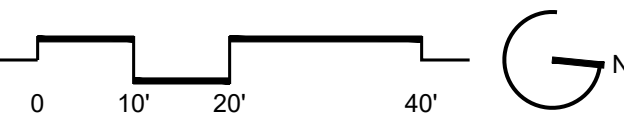

LEGEND

- A EXPANDED STREETSCAPE WITH TREES, SEATING AND AMENITIES
- B RESIDENTIAL AMENITY SPACES (PRIVATE)
- C GATEWAY COMMUNITY SPACE WITH FOCAL FEATURE & SEAT WALLS
- D PLAZA/EVENT SPACE
- E POTENTIAL OUTDOOR DINING AREAS
- F BENCH/STAGE FEATURE
- G PUBLIC PARKING
- H PLAZA ACCENT AREA
- I LINEAR SEAT WALLS/FEATURES
- J FOCAL POINT SEATING ELEMENTS
- K RIVER ROAD STREETSCAPE PLANTING
- L STREET LIGHTS (SEE LIGHTING)
- M BENCHES/CONVERSATION AREAS
- N RESIDENTIAL LOBBY ARRIVAL
- O OPEN SPACE WALK/CONNECTION TO BUILDING B
- P BIKE RACKS
- Q SERVICE/DROP-OFF AREA
- R PARKING ENTRY
- S CROSSWALK
- T OPEN SPACE WALK
- U LANDSCAPE AREA
- V PROPOSED BENCHES
- W EXISTING LANDSCAPE BUFFER TO REMAIN

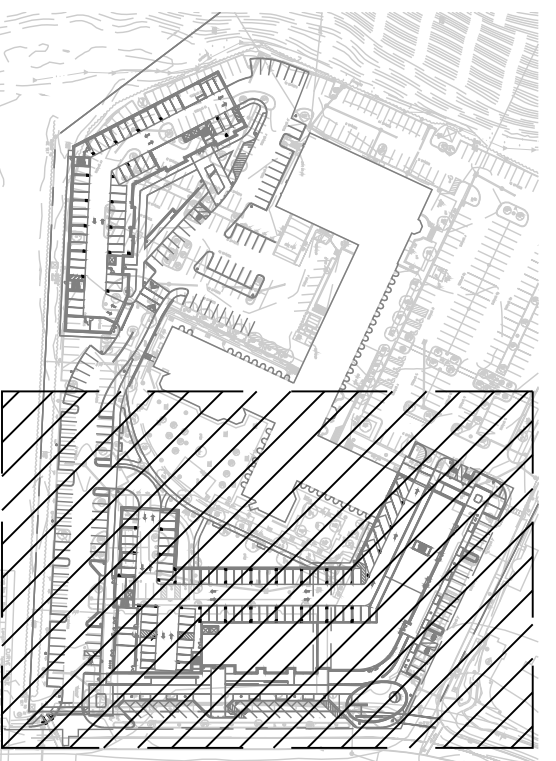

KEY PLAN

N.T.S.

Wilton Campus 1691  
5-21 River Road, Wilton, CT

Client  
WILTON CAMPUS 1691, LLC  
15 River Road, Suite 15  
Wilton, CT 06897

Architect  
CUBE3  
56 High Street  
North Andover, MA 01845

Civil Engineer  
VHB  
1775 Greensboro Station Pl Ste 200  
McLean, VA 22102

SEAL

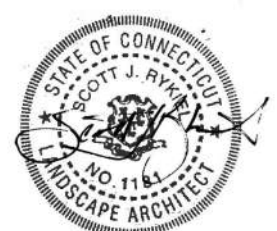

ISSUED FOR	DATE
1 VDDAC SUBMISSION	03/28/2024
2 LOCAL APPROVALS	04/23/2024

PROJECT NO.  
23018

SCALE :  
As Shown

DRAWN BY :  
SW

REVIEWED BY :  
MR

L1.01

Building A Rendering  
Plan

NOT FOR CONSTRUCTION

0 1 2 3 4 5 6 7 8 9 10 11 12 13 14 15

A  
B  
C  
D  
E  
F  
G  
H  
I  
J

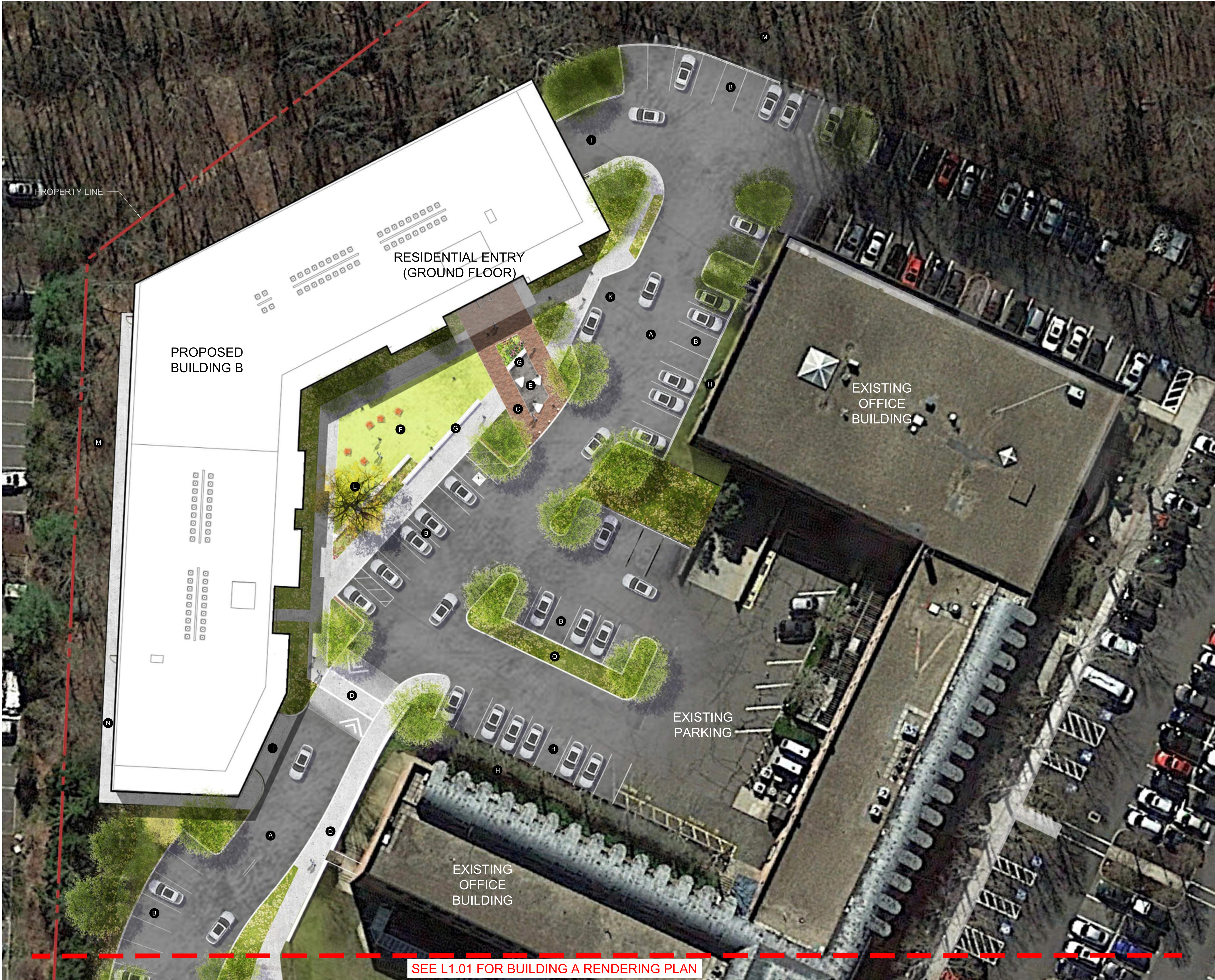

SEE L1.01 FOR BUILDING A RENDERING PLAN

1 BUILDING B RENDERING ENLARGEMENT PLAN - GROUND FLOOR  
1"=20'-0"

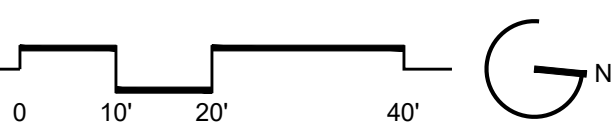

LEGEND

- A REALIGNED SITE DRIVEWAY
- B PROPOSED/REALIGNED PARKING
- C RESIDENTIAL ARRIVAL PLAZA
- D OPEN SPACE WALKWAY/CROSSWALK TO RIVER ROAD
- E SEATING ELEMENTS
- F LAWN AREA
- G LINEAR SEAT WALLS/FEATURES
- H EXISTING LANDSCAPE AREA
- I PARKING ENTRY
- J FOCAL POINT TREE
- K DELIVERY DROP-OFF ZONE
- L RAISED CROSSWALK
- M EXISTING LANDSCAPE BUFFER TO REMAIN
- N EGRESS PATHWAY
- O RAIN GARDEN



KEY PLAN

N.T.S.

Wilton Campus 1691  
5-21 River Road, Wilton, CT

Client  
WILTON CAMPUS 1691, LLC  
15 River Road, Suite 15  
Wilton, CT 06897

Architect  
CUBE3  
56 High Street  
North Andover, MA 01845

Civil Engineer  
VHB  
1775 Greensboro Station Pl Ste 200  
McLean, VA 22102

SEAL



ISSUED FOR	DATE
1 VDDAC SUBMISSION	03/28/2024
2 LOCAL APPROVALS	04/23/2024

PROJECT NO. 23018	SCALE : As Shown
DRAWN BY : SW	REVIEWED BY : MR

L1.02  
Building B Rendering  
Plan

NOT FOR CONSTRUCTION

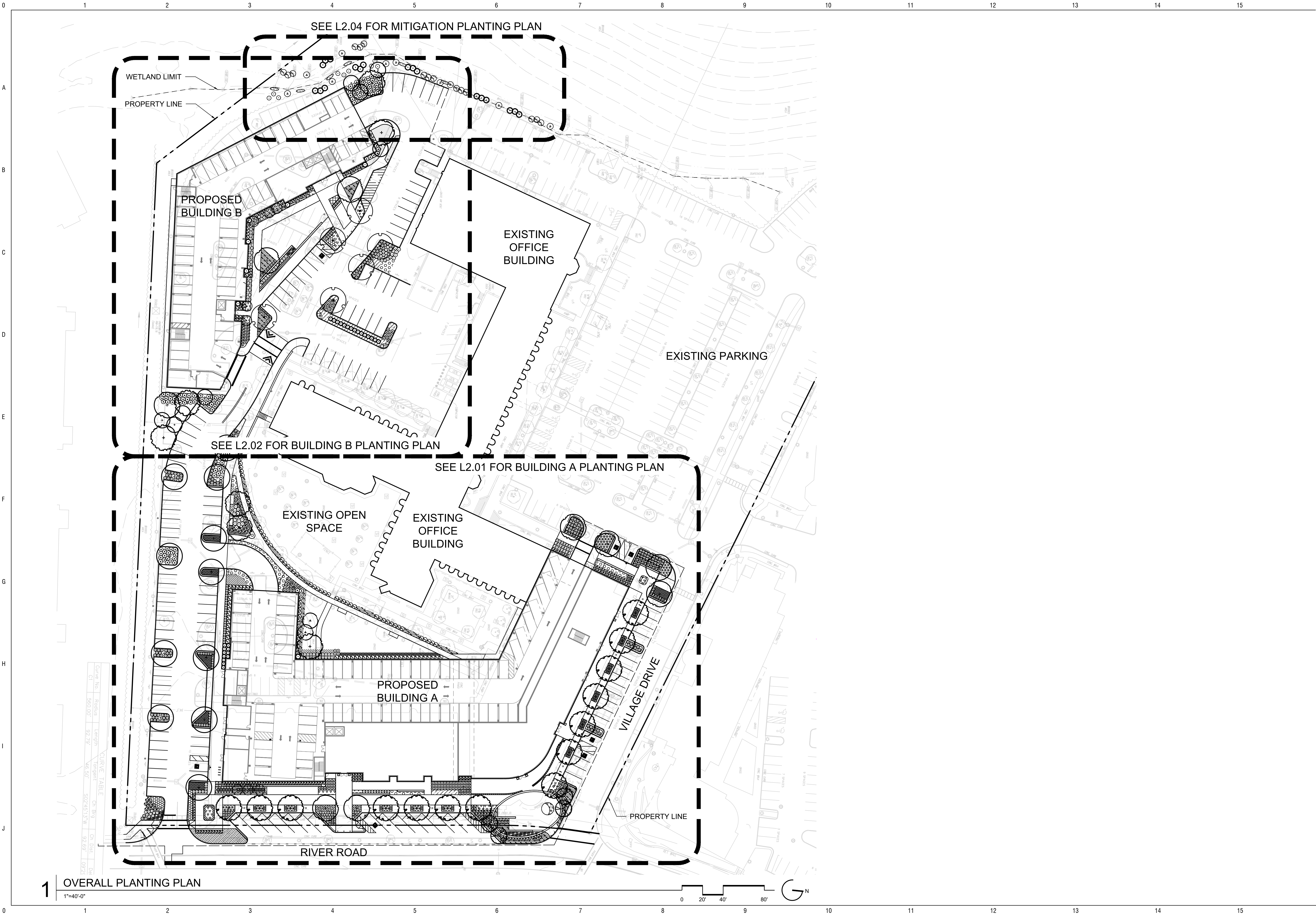

Wilton Campus 1691  
5-21 River Road, Wilton, CT

Client  
WILTON CAMPUS 1691, LLC  
15 River Road, Suite 15  
Wilton, CT 06897

Architect  
CUBE3  
56 High Street  
North Andover, MA 01845

Civil Engineer  
VHB  
1775 Greensboro Station Pl Ste 200  
McLean, VA 22102

SEAL



ISSUED FOR	DATE
1 VDDAC SUBMISSION	03/28/2024
2 LOCAL APPROVALS	04/23/2024

PROJECT NO.  
23018

SCALE :  
As Shown

DRAWN BY :  
SW

REVIEWED BY :  
MR

L2.00  
Overall Planting Plan

0 1 2 3 4 5 6 7 8 9 10 11 12 13 14 15

A  
B  
C  
D  
E  
F  
G  
H  
I  
J

SEE L2.02 FOR BUILDING B PLANTING PLAN

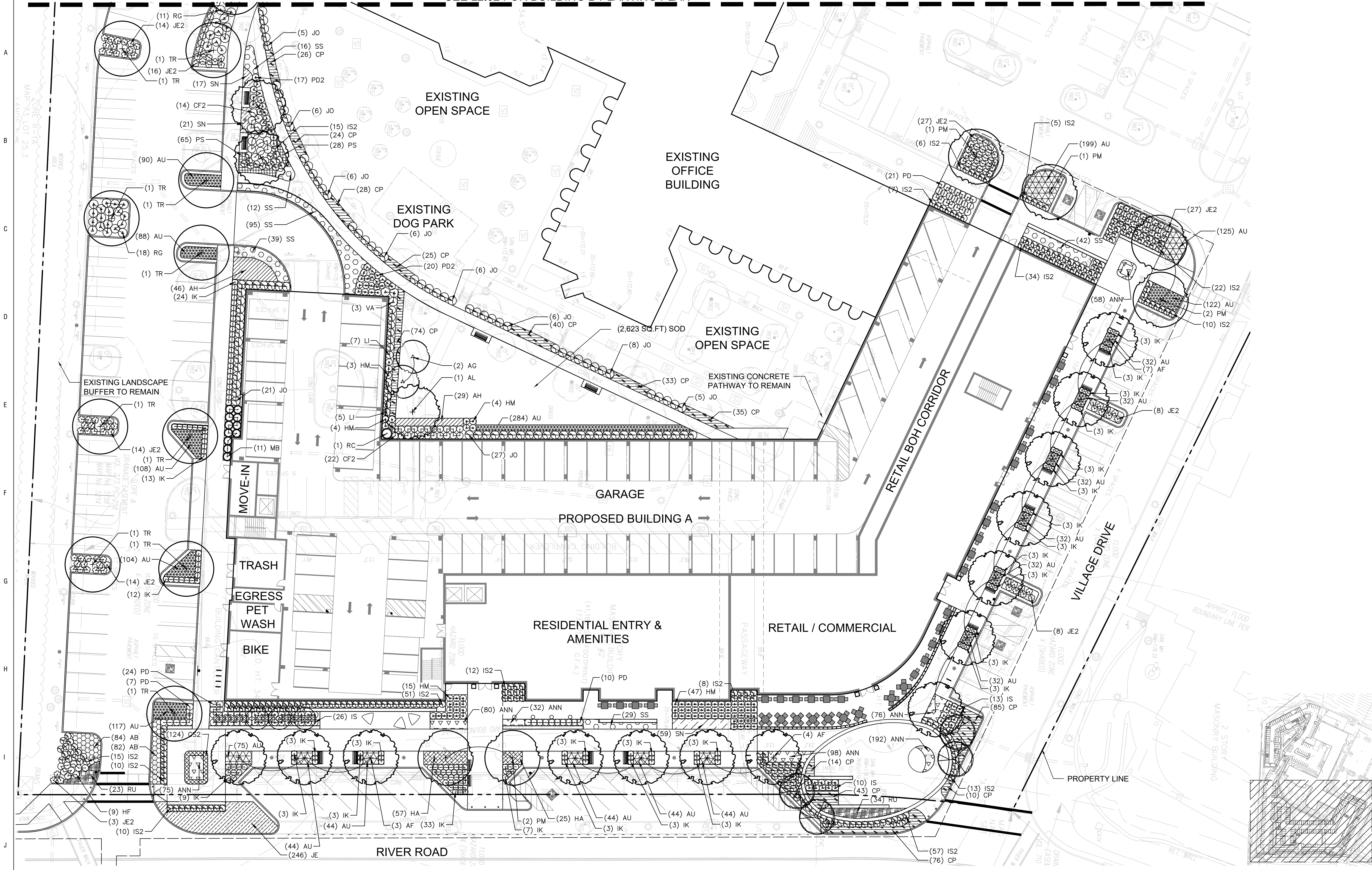

1 BUILDING A PLANTING ENLARGEMENT PLAN - GROUND FLOOR

KEY PLAN

N.T.S.

MAHAN RYKIEL  
ASSOCIATES INC.  
Whitetail Mill 3300 Clipper Mill Road  
Suite 200 Baltimore, MD 21211 410.235.6001

Wilton Campus 1691  
5-21 River Road, Wilton, CT

Client  
WILTON CAMPUS 1691, LLC  
15 River Road, Suite 15  
Wilton, CT 06897

Architect  
CUBE3  
56 High Street  
North Andover, MA 01845

Civil Engineer  
VHB  
1775 Greensboro Station Pl Ste 200  
McLean, VA 22102

SEAL



ISSUED FOR	DATE
1 VDDAC SUBMISSION	03/28/2024
2 LOCAL APPROVALS	04/23/2024

PROJECT NO.  
23018

SCALE:  
As Shown

DRAWN BY:  
SW

REVIEWED BY:  
MR

L2.01

Building A Planting Plan

NOT FOR CONSTRUCTION

0 1 2 3 4 5 6 7 8 9 10 11 12 13 14 15

A

B

C

D

E

F

G

H

I

J

WETLAND LIMITS,  
SEE MITIGATION PLANTING PLAN  
IN SHEET L2.04

EXISTING LANDSCAPE  
TO REMAIN  
PROPERTY LINE

PROPOSED  
BUILDING B

RESIDENTIAL  
ENTRY

GARAGE

MOVE  
IN

MECH

BIKE

EXISTING OFFICE  
BUILDING

EXISTING PARKING

EXISTING OFFICE  
BUILDING

SEE L2.01 FOR BUILDING A PLANTING PLAN

WETLAND LIMITS,  
SEE MITIGATION PLANTING PLAN  
IN SHEET L2.04

EXISTING LANDSCAPE  
TO REMAIN

1

BUILDING B PLANTING ENLARGEMENT PLAN - GROUND FLOOR

1"=20'-0"

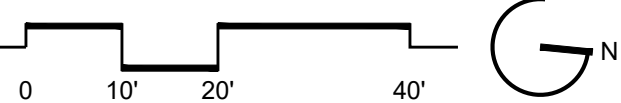

KEY PLAN

N.T.S.

MAHAN RYKIEL  
ASSOCIATES INC  
Whitetail Mill 3300 Clipper Mill Road  
Suite 200 Baltimore, MD 21211 410.235.6031

Wilton Campus 1691  
5-21 River Road, Wilton, CT

Client  
WILTON CAMPUS 1691, LLC  
15 River Road, Suite 15  
Wilton, CT 06897

Architect  
CUBE3  
56 High Street  
North Andover, MA 01845

Civil Engineer  
VHB  
1775 Greensboro Station Pl Ste 200  
McLean, VA 22102

SEAL

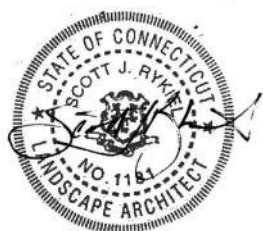

ISSUED FOR	DATE
1 VDDAC SUBMISSION	03/28/2024
2 LOCAL APPROVALS	04/23/2024

PROJECT NO.  
23018

SCALE:  
As Shown

DRAWN BY:  
SW

REVIEWED BY:  
MR

L2.02

Building B Planting Plan

NOT FOR CONSTRUCTION

LANDSCAPE SHEET INDEX

A

PLANT SCHEDULE

CODE	QTY	BOTANICAL / COMMON NAME	SIZE	CONTAINER
------	-----	-------------------------	------	-----------

ORNAMENTAL TREES

AG	2	Amelanchier x grandiflora 'Autumn Brilliance Autumn Brilliance Apple Serviceberry	8'-10' Ht.	B&B
CF	5	Cornus florida Flowering Dogwood	2"-2.5" Cal.	B&B
OV	3	Ostrya virginiana American Hophornbeam	2.0"-2.5" Cal.	B&B

SHADE TREES

AF	14	Acer rubrum 'Frank Jr.' Redpointe® Maple	3"-3.5" Cal.	B&B
AL	5	Acer saccharum 'Legacy' Legacy Sugar Maple	3"-3.5" Cal.	B&B
GI	6	Gleditsia triacanthos inermis 'Skycolor' Skyline® Honey Locust	3"-3.5" Cal.	B&B
PM	8	Platanus x acerifolia 'Morton Circle' Exclamation!™ London Plane Tree	3"-3.5" Cal.	B&B
QR	1	Quercus rubra Northern Red Oak	3"-3.5" Cal.	B&B
TR	11	Tilia americana 'Redmond' Redmond American Linden	3"-3.5" Cal.	B&B

SHRUBS

CS	12	Clethra alnifolia 'Sixteen Candles' Sixteen Candles Summersweet	2'-3' Ht.	B&B/Cont.
CF2	63	Cornus sericea 'Farrow' Arctic Fire® Red Twig Dogwood	2'-3' Ht.	B&B/Cont.
HM	79	Hydrangea quercifolia 'Munchkin' Munchkin Oakleaf Hydrangea	3'-4' Ht.	B&B/Cont.
HF	43	Hypericum frondosum 'Sunburst' Sunburst St. John's Wort	2'-3' Ht.	B&B/Cont.
IK	175	Ilex glabra 'Gem Box' Gem Box Inkberry Holly	18" - 24" Spd.	Cont.
IS2	320	Ilex glabra 'Shamrock' Shamrock Inkberry Holly	2'-3' Ht.	B&B/Cont.
IS	87	Itea virginica 'Sprich' Little Henry® Sweetspire	2'-3' Ht.	B&B/Cont.
JE2	173	Juniperus communis 'Effusa' Effusa Common Juniper	18" - 24" Spd.	Cont.
JO	98	Juniperus virginiana 'Grey Owl' Grey Owl Eastern Redcedar	2'-3' Ht.	B&B/Cont.
LI	37	Leucothoe axillaris 'Sarah's Choice' Sarah's Choice Dog-Hobble	2'-3' Ht.	B&B/Cont.
MB	26	Myrica pensylvanica 'Bobzam' Bobee™ Northern Bayberry	3'-4' Ht.	B&B/Cont.
PD2	49	Physocarpus opulifolius 'Donna May' Little Devil™ Dwarf Ninebark	2'-3' Ht.	B&B/Cont.
PD	68	Potentilla fruticosa 'Fargo' Dakota Sunspot® Bush Cinquefoil	2'-3' Ht.	B&B/Cont.
RC	7	Rhododendron carolinianum Carolina Rhododendron	3'-4' Ht.	B&B/Cont.
RG	126	Rhus aromatica 'Gro-Low' Gro-Low Fragrant Sumac	2'-3' Spd.	B&B/Cont.
VA	13	Viburnum dentatum 'Christom' Blue Muffin® Arrowwood Viburnum	3'-4' Ht.	B&B/Cont.

CODE	QTY	BOTANICAL / COMMON NAME	SIZE	CONTAINER	SPACING
------	-----	-------------------------	------	-----------	---------

GROUND COVERS

AH	96	Amsonia hubrichtii Arkansas Bluestar	#1	Cont.	24" o.c.
AB	212	Amsonia x 'Blue Ice' Blue Ice Bluestar	#1	Cont.	15" o.c.
ANN	2,998	Annua Annua Plants	#1	Cont.	6" o.c.
AU	1,724	Arostaphylos uva-ursi Kinnikinnick	#1	Cont.	12" o.c.
CP	781	Carex pensylvanica Pennsylvania Sedge	#1	Cont.	18" o.c.
CS2	311	Chrysogonum virginianum 'Superstar' Superstar Green-and-Gold	#SP4	Cont.	10" o.c.
HA	106	Heuchera villosa 'Autumn Bride' Autumn Bride Hairy Alumroot	#1	Cont.	18" o.c.
JE	474	Juncus effusus Soft Rush	#1	Cont.	18" o.c.
LC	26	Lobelia cardinalis Cardinal Flower	#1	Cont.	18" o.c.
PS	147	Phlox subulata Creeping Phlox	#1	Cont.	12" o.c.
RU	69	Rudbeckia x 'American Gold Rush' American Gold Rush Coneflower	#1	Cont.	24" o.c.
SS	270	Schizachyrium scoparium 'The Blues' The Blues Little Bluestem	#1	Cont.	24" o.c.
SN	119	Symphoricarum novae-angliae New England Aster	#1	Cont.	18" o.c.

LANDSCAPE NOTES:

1. CONTACT 'CALL BEFORE YOU DIG' AT 1-800-922-4455 TO HAVE UNDERGROUND UTILITY LINES MARKED BY THEM PRIOR TO START OF ANY EXCAVATION WORK.
2. EXACT LOCATION OF PROPOSED PLANTINGS AND SPECIES TYPES MAY VARY FROM THE PLAN BASED ON ACTUAL FIELD CONDITIONS.
3. SPRAY NEW PLANTINGS IMMEDIATELY AFTER INSTALLATION WITH A WHITE-TAILED DEER REPELLENT AND CONTINUE AS NEEDED TO MAINTAIN PLANTS FREE OF SIGNIFICANT DEER BROWSING.
4. PLANT SPECIES SEBTITUITIONS MAY BE MADE WITH THE APPROVAL OF THE PROJECT LANDSCAPE ARCHITECT AND TOWN OF WILTON PRIOR TO PLANTING. SUBSTITUTED PLANTS SHALL BE AT AN EQUAL OR GREATER SIZE AS NOTED USING A SIMILAR TYPE PLANT.
5. MULCH AREAS AROUND NEW TREES AND SHRUBS WITH A 3" THICK LAYER OF SHREDDED CEDAR BARK MULCH. NEW TREES SHALL EACH HAVE A 5' MIN. DIA. MULCHED BED AND NEW SHRUBS SHALL EACH HAVE A MINIMUM 3' DIAMETER MULCHED BED. AREAS WITHIN 4" OF TREE TRUNKS SHALL BE MINTAINED FREE OF MULCH.
6. PLANTING METHODS SHALL BE IN ACCORDANCE WITH THE 'AMERICAN STANDARDS FOR NURSERY STOCK', LATEST EDITION, AS PUBLISHED BY THE AMERICAN NURSERY & LANDSCAPE ASSOCIATION.
7. THE CONTRACTOR SHALL VERIFY WITH THE PROJECT ENGINEER THAT THE NEW PLANTINGS DO NOT INTERFERE WITH EXISTING AND/OR PROPOSED UTILITIES, SIGHT LINES, AND/OR STRUCTURES.
8. THE PLAN FOR PLANTING PURPOSES ONLY. SEE PLANS BY OTHERS FOR ADDITIONAL INFORMATION.
9. SEED LAWN AREAS WITH A HIGH-QUALITY TRIPLE FESCUE TURF MIX. SEED AREAS AT THE METHODS AND RATE RECOMMENDED BY THE MANUFACTURER. LIGHTLY MULCH SEEDED AREA WITH WEEK-FREE CLEAN HAY. A NURSE CROP SHALL BE ADDED TO THE SEED MIX ON SLOPES OF EXCESS OF 10%. LIGHTLY RAKE OR ROLL GROUND SURFACE ATER SOWING.

H

I

J

Wilton Campus 1691  
5-21 River Road, Wilton, CT

Client  
WILTON CAMPUS 1691, LLC  
15 River Road, Suite 15  
Wilton, CT 06897

Architect  
CUBE3  
56 High Street  
North Andover, MA 01845

Civil Engineer  
VHB  
1775 Greensboro Station Pl Ste 200  
McLean, VA 22102

SEAL



ISSUED FOR	DATE
1 VDDAC SUBMISSION	03/28/2024
2 LOCAL APPROVALS	04/23/2024

PROJECT NO. 23018	SCALE : As Shown
DRAWN BY : SW	REVIEWED BY : MR

L2.03  
Plant Schedule

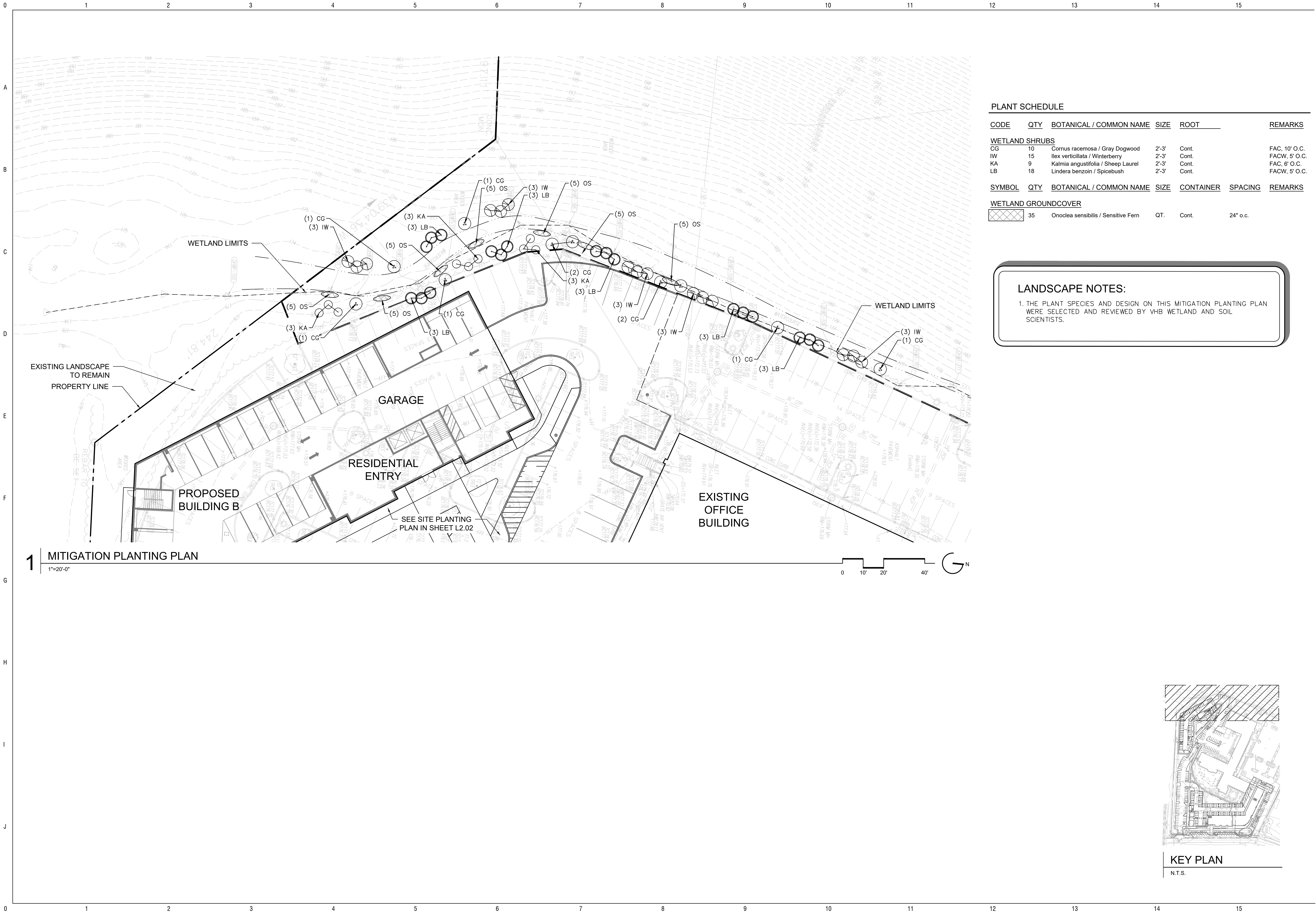

1 MITIGATION PLANTING PLAN  
1"=20'-0"

PLANT SCHEDULE						
<u>CODE</u>	<u>QTY</u>	<u>BOTANICAL / COMMON NAME</u>	<u>SIZE</u>	<u>ROOT</u>	<u>REMARKS</u>	
<u>WETLAND SHRUBS</u>						
CG	10	Cornus racemosa / Gray Dogwood	2'-3'	Cont.	FAC, 10' O.C.	
IW	15	Ilex verticillata / Winterberry	2'-3'	Cont.	FACW, 5' O.C.	
KA	9	Kalmia angustifolia / Sheep Laurel	2'-3'	Cont.	FAC, 6' O.C.	
LB	18	Lindera benzoin / Spicebush	2'-3'	Cont.	FACW, 5' O.C.	
<u>SYMBOL</u>	<u>QTY</u>	<u>BOTANICAL / COMMON NAME</u>	<u>SIZE</u>	<u>CONTAINER</u>	<u>SPACING</u>	<u>REMARKS</u>
<u>WETLAND GROUNDCOVER</u>						
	35	Onoclea sensibilis / Sensitive Fern	QT.	Cont.	24" o.c.	

LANDSCAPE NOTES:  
1. THE PLANT SPECIES AND DESIGN ON THIS MITIGATION PLANTING PLAN WERE SELECTED AND REVIEWED BY VHB WETLAND AND SOIL SCIENTISTS.

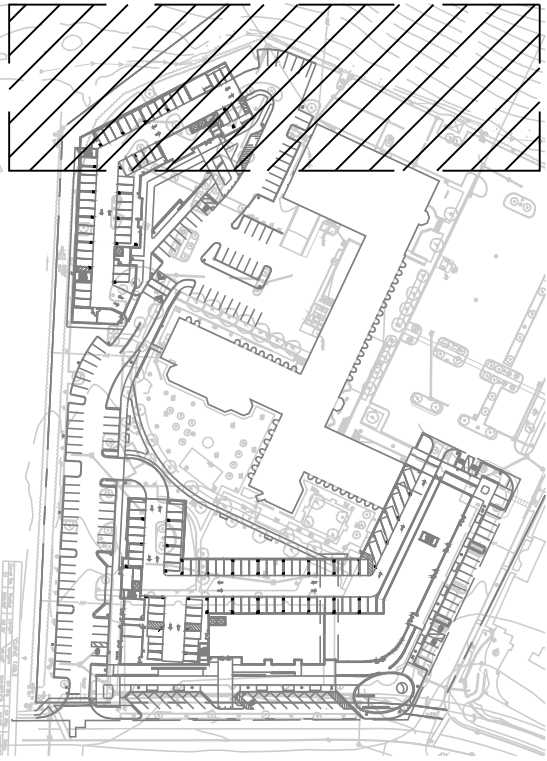

KEY PLAN  
N.T.S.

Wilton Campus 1691  
5-21 River Road, Wilton, CT

Client  
WILTON CAMPUS 1691, LLC  
15 River Road, Suite 15  
Wilton, CT 06897  
Architect  
CUBE3  
56 High Street  
North Andover, MA 01845  
Civil Engineer  
VHB  
1775 Greensboro Station Pl Ste 200  
McLean, VA 22102



ISSUED FOR	DATE
1 VDDAC SUBMISSION	03/28/2024
2 LOCAL APPROVALS	04/23/2024

PROJECT NO.  
23018  
SCALE :  
As Shown  
DRAWN BY :  
SW  
REVIEWED BY :  
MR