

CONSTRUCTION SEQUENCE (GENERAL):

- THE CONTRACTOR SHALL READ AND COMPLY WITH ALL REQUIRED PRE-CONSTRUCTION PERMIT CONDITIONS PRIOR TO THE START OF CONSTRUCTION.
 - THE CONTRACTOR SHALL VERIFYING THE LOCATION OF THE PROPERTY LINE BEFORE START OF WORK.
 - INSTALL A DOUBLE ROW OF SILT FENCE (EROSION CONTROLS) AS NOTED AT LIMITS OF SITE WORK PER SITE PLAN. CHECK EROSION CONTROL MEASURES WEEKLY. REPAIR AS NEEDED.
 - WALL DECONSTRUCTION AND SOIL REMOVAL IS EXPECTED TO BEGIN IN THE NORTHWEST CORNER AND PROGRESS SOUTH.
 - FOLLOW CONSTRUCTION SEQUENCE AND SPECIFICATIONS FOR WALL DECONSTRUCTION BY STRUCTURAL CONSULTING SERVICES, P.C.
 - TEMPORARY SOIL STOCK PILES SHALL BE CONTINUED TO EXISTING AREAS ON MAP. ALL STOCK PILES SHALL BE SURROUNDED BY SILT FENCE. ANY EXCESS MATERIAL SHALL BE REMOVED FROM SITE. EXISTING STOCK PILES MAY BE REMOVED TO ADD DECONSTRUCTION SEQUENCE.
 - ESTABLISH THE NEW BOULDER ROW IN ACCORDANCE WITH GRADING PLAN BY PEAK ENGINEERS, LLC AND DETAIL BY STRUCTURAL CONSULTING SERVICES, P.C.
 - REMOVAL ALL EXCESS STONE OFF SITE.
 - ESTABLISH NEW 1:2 (V:H) SLOPE (MAXIMUM) AS NOTED ON GRADING PLAN BY PEAK ENGINEERS, LLC.
 - INSTALL GRAVEL TRENCH ALONG TOP OF SLOPE, AS NOTED ON PLAN PREPARED BY PEAK ENGINEERS, LLC.
 - SPREAD TOPSOIL AND FINE GRADE SITE.
 - PROVIDE STRAW FABRIC (EROSION CONTROL BLANKET) TO FINISHED SLOPE TO ENHANCE GERMINATION VEGETATION GROWTH FOR FINAL STABILIZATION.
 - REMOVE EROSION CONTROLS WHEN SITE SOILS ARE STABLE.
 - SITE CLEAN-UP.
- EROSION CONTROL NOTES:
- LAND DISTURBANCE SHALL BE KEPT TO A MINIMUM. RESTABILIZATION OF DISTURBED SOILS SHALL BE COMPLETED AS SOON AS POSSIBLE.
 - ALL EROSION CONTROL MEASURES SHALL BE IN ACCORDANCE WITH THE STANDARDS AND SPECIFICATIONS NOTED IN THE "CONNECTICUT GUIDELINES FOR SOIL EROSION AND SEDIMENT CONTROL", DEP BULLETIN 34, 2002.
 - ADDITIONAL EROSION CONTROL MEASURES SHALL BE INSTALLED DURING THE CONSTRUCTION PERIOD AS NEEDED AT THE CONTRACTOR'S EXPENSE. THE TOWN WETLAND DEPARTMENT STAFF AND THE PROJECT LANDSCAPE ARCHITECT SHALL HAVE THE AUTHORITY IN DETERMINING THE NEED FOR ADDITIONAL CONTROLS.
 - DISTURBED AREAS TO BE LEFT EXPOSED FOR MORE THAN 21 DAYS SHALL BE SEEDED WITH RYEGRASS AT THE RATE OF 1 LBS. PER 1000 SQUARE FEET WITHIN SEVEN DAYS OF THE OCCURRENCE OF THE DISTURBANCE. APPLY SOIL AMENDMENTS AND MULCH AS NEEDED TO ESTABLISH A DENSE, UNIFORM AND HEALTHY VEGETATION STAND OVER SEEDED AREAS.
 - THE SITE CONTRACTOR SHALL UTILIZE METHODS AND MATERIALS FOR THE PREVENTING OF DUST (SOIL) BLOWING ONTO OFFSITE AREAS.
 - THE SITE CONTRACTOR SHALL MAINTAIN AN EXTRA SUPPLY OF SILT FENCE (50' MIN.) ON THE SITE FOR EMERGENCY REPAIRS.
 - EROSION CONTROLS SHALL BE MAINTAINED IN PROPER WORKING ORDER DURING THE CONSTRUCTION PERIOD AND UNTIL THE SITE SOILS ARE STABILIZED. EROSION CONTROLS SHALL BE INSPECTED WEEKLY AND AFTER EACH RAINFALL AND REPAIRED WITHIN 24 HOURS.
 - WHEN POSSIBLE, EROSION CONTROLS SHALL BE INSTALLED PRIOR TO CONSTRUCTION.
 - IF CONSTRUCTION OPERATIONS ARE DELAYED FOR ANY REASON ONCE SITE DISTURBANCE HAS OCCURRED THE SITE CONTRACTOR SHALL BE RESPONSIBLE FOR THE PROPER ROUTINE MAINTENANCE AND INSPECTION OF THE EROSION CONTROL MEASURES DURING THIS PERIOD.
 - SWEEP SITE AND ADJACENT ROADWAYS AS NEEDED TO KEEP THEM CLEAN OF ACCUMULATED SITE SEDIMENTS THROUGHOUT THE PROJECT PERIOD.
 - SEEDED AREAS THAT ARE ON SLOPES ON OR GREATER THAN 10% SHALL BE COVERED WITH AN EROSION CONTROL BLANKET (INCLUDING ANCHOR STAPLES) THAT IS PLASTIC-FREE AND 100% BIODEGRADABLE OR PHOTODEGRADABLE WITHIN TWO YEARS.

SLOPE STABILIZATION SPECIFICATIONS

- REGRADE SLOPE TO A MAXIMUM GRADE OF 1:2 (V:H) SLOPE.
- PROVIDE A MINIMUM OF 4" OF TOPSOIL OVER ENTIRE SLOPE THAT IS TO BE STABILIZED.
- SOIL TEST AND LIME AND FERTILIZER AS RECOMMENDED BY SOIL ANALYSIS. INCORPORATE ANY AMENDMENTS INTO THE SOIL. ALL INCORPORATING ACTIVITIES SHOULD BE DONE IN A MANNER THAT WILL LEAVE THE SOIL ROUGH, WHICH WILL MINIMIZE SOIL EROSION AND RAPID RUN-OFF.
- FINISH GRADE SHALL BE COMPACTED AND WITH A SMALL TRACK MACHINE TO PROVIDE A SECURE AND ROUGHED SURFACE FOR SEEDING PRIOR TO HAND FINISHING.
- SEEDING METHOD: AREA SHALL BE HAND SEEDED. ONCE THE SEED HAS BEEN BROADCAST, LIGHTLY RAKE TO COVER THE SEED (APPROX. 1/4" DEEP). SEED ENTIRE AREA WITH EQUAL PARTS OF THE FOLLOWING TWO SEEDS: BARNYARD SEED (ERNNAX-104) AND SEASON SEASON GRASS MIX (ERNNAX-117).
- SEED APPLICATION SHALL INCLUDE A STRAW EROSION CONTROL BLANKET. PROVIDE "EC/SC2" STRAW & COIR BLANKET PROVIDED BY PINELANDS NURSERY & SUPPLY (800-667-2729 OR WWW.PINELANDSNURSERY.COM) OR APPROVED EQUAL.

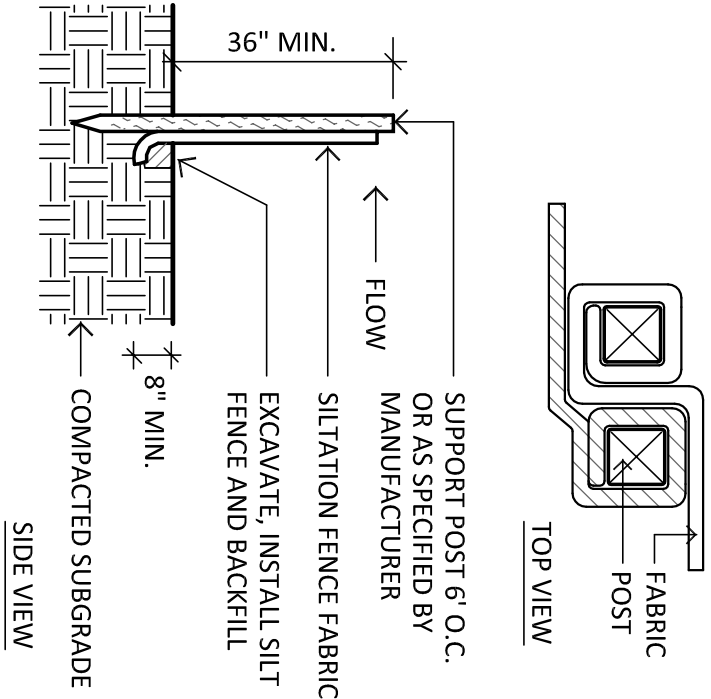
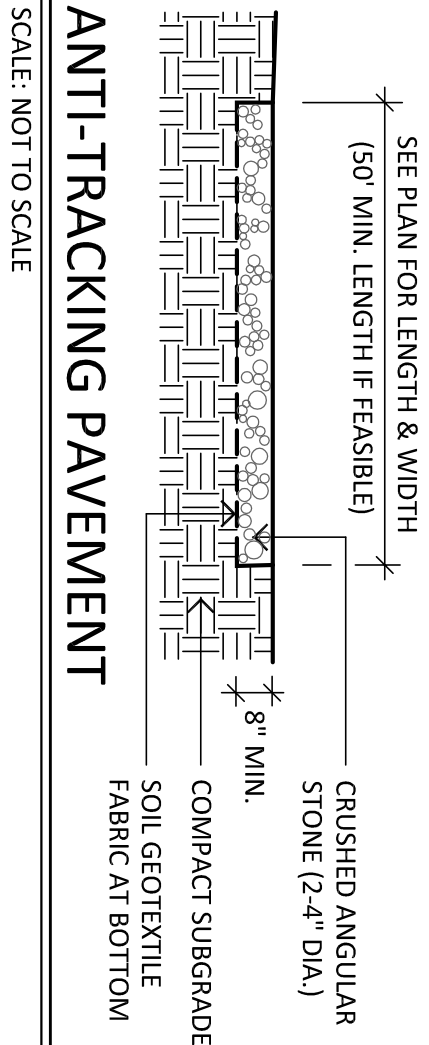

SILT FENCE-SINGLE (AREAS AT TOP OF SLOPE)

SCALE: NOT TO SCALE

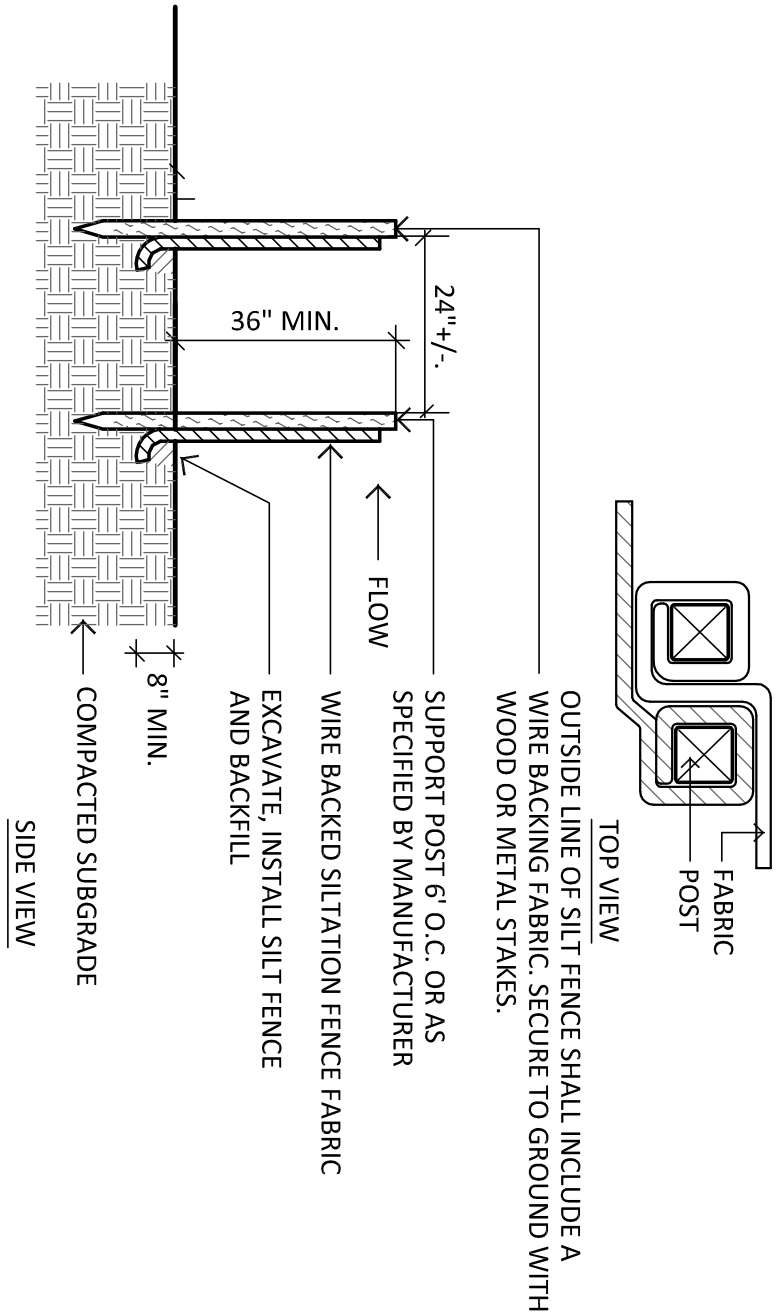

SILT FENCE-DOUBLE ROW (BOTTOM OF SLOPE)

SCALE: NOT TO SCALE

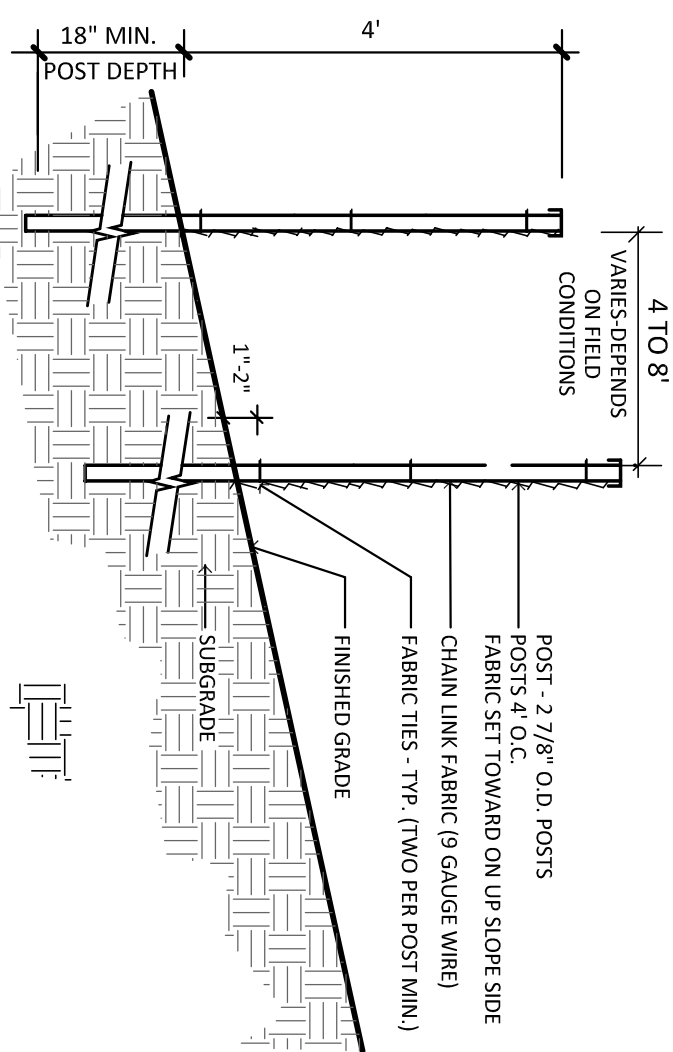

LEGEND

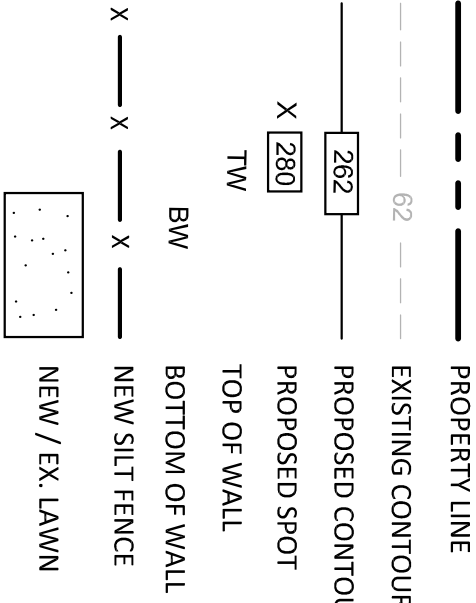

GENERAL NOTES:

- SURVEY INFORMATION TAKEN FROM A PLAN ENTITLED "TOPOGRAPHIC/LOCATION SURVEY", PREPARED BY WALTER SAIDLO LAND SURVEYOR, LLC. REVISED TO MARCH 17, 2023. SEE THIS PLAN FOR ADDITIONAL INFORMATION AND NOTES PRIOR TO THE START OF SITE WORK.
- THE CONTRACTOR SHALL CONTACT "CALL BEFORE YOU DIG" (1-800-322-4455) AND HAVE THE EXISTING UTILITIES LOCATED PRIOR TO THE START OF SITE WORK.
- PITCH ALL AREAS TO DRAIN.
- THE CONTRACTOR SHALL VERIFY THE EXISTING CONDITIONS OF THE SITE. NOTIFY THE PROJECT LANDSCAPE ARCHITECT OF ANY DIFFERENCE WITH THAT NOTED ON THE SITE PLANS.

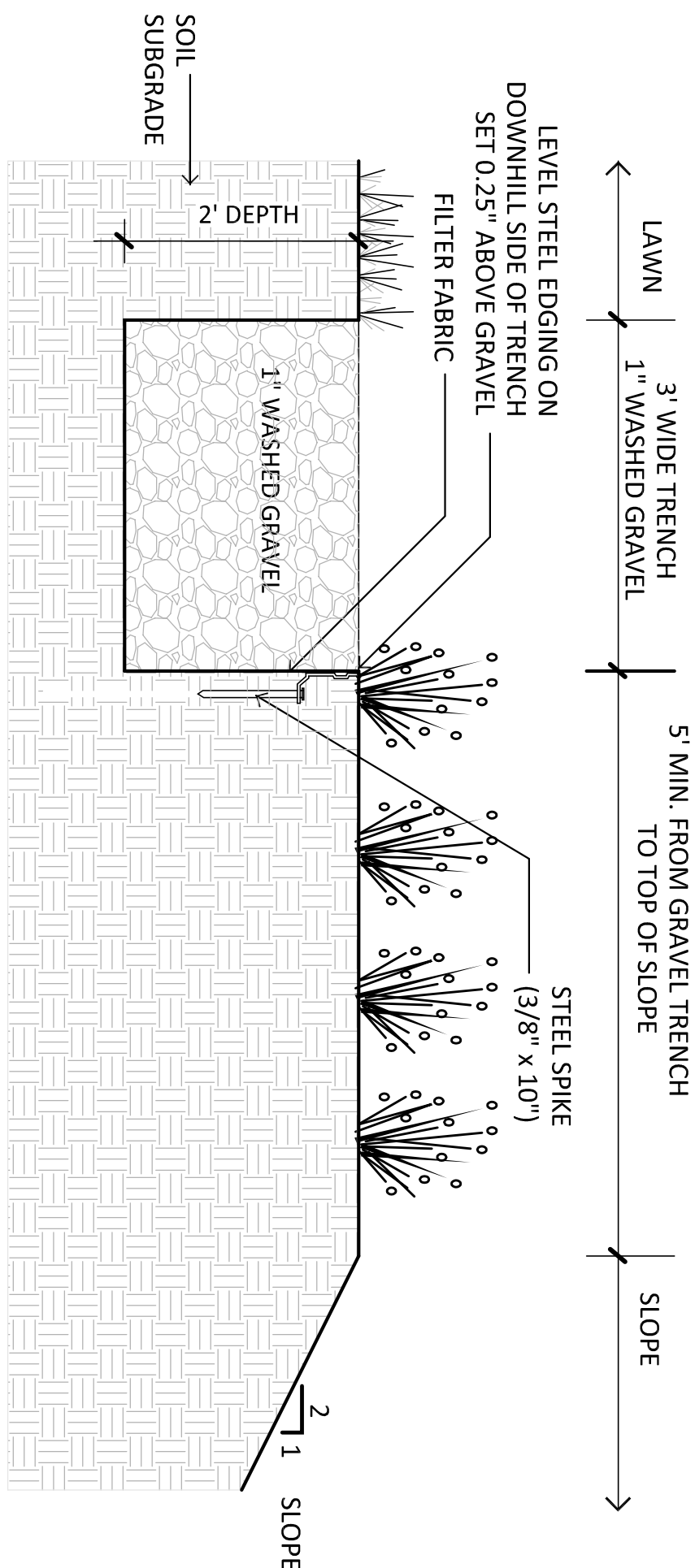

GRAVEL TRENCH (AT TOP OF NEW SLOPE)

SCALE: NOT TO SCALE

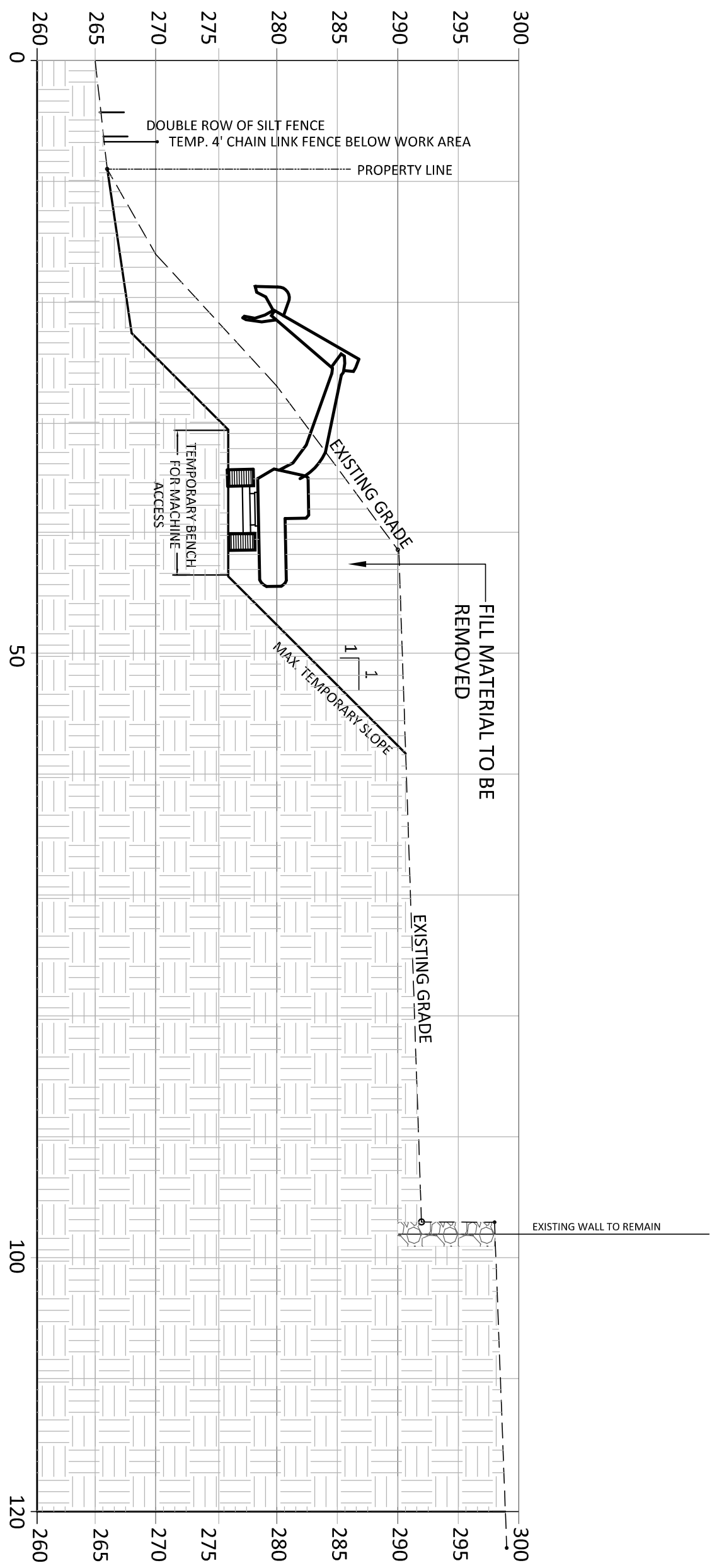

SECTION B-B"

NOTE: THIS SECTION IS ILLUSTRATIVE. REFER TO STRUCTURAL ENGINEER PLANS FOR ALL LATERAL SLOPE LOADS BENEATH MACHINE WORK AREA.

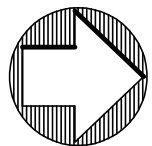

PROJECT NORTH

GRAPHIC SCALE

0' 10' 20' 40'

REVISIONS		DRAWING TITLE	
		NOTES AND DETAILS	
		PROJECT	
		LUPINSKI RESIDENCE	
		53 SUGAR LOAF DRIVE	
		WILTON, CONNECTICUT	
		DATE: MARCH 12, 2024	
		SCALE: 1"=20'	
		DRAWING NO.: SE-2	

ENVIRONMENTAL LANDSCAPE ARCHITECTURE

ELSA

ENVIRONMENTAL LANDSCAPE ARCHITECTURE

ENVIRONMENTAL LAND SOLUTIONS, LLC

Landscape Architecture and Environmental Planning

8 KNIGHT STREET, SUITE 203

NORWALK, CONNECTICUT 06851

Tel: (203) 855-7879 Fax: (203) 855-7836

info@elsa.net www.elsa.net

SEAL

PLANNING