



THIS DOCUMENT IS INCOMPLETE AND IS RELEASED TEMPORARILY FOR PROGRESS REVIEW ONLY. IT IS NOT INTENDED FOR BIDDING OR CONSTRUCTION PURPOSES.

## Fuller Development LLC

64 Danbury Road

Wilton,  
Connecticut

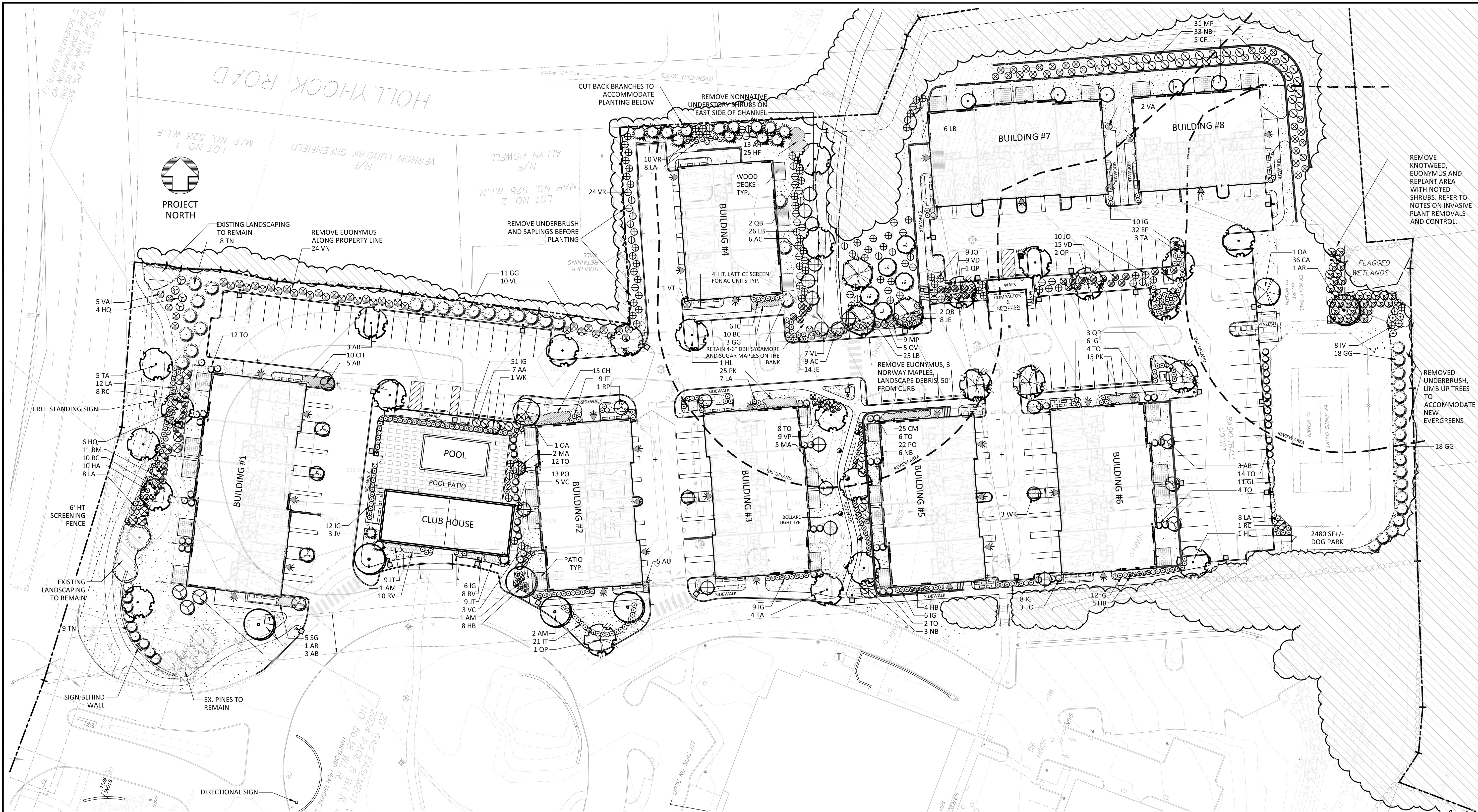

### PLANT LIST

QTY	KEY	BOTANICAL NAME	COMMON NAME	SIZE	ROOT	REMARKS
6	AR	ACER RUBRUM	RED MAPLE	3-3.5" CAL.	B&B	FULL
4	AM	ACER RUBRUM 'ARMSTRONG'	ARMSTRONG MAPLE	3-3.5" CAL.	B&B	
2	HL	GLEDITSIA TRIACANTHOS 'SHADEMASTER'	SHADEMASTER HONEY LOCUST	3-3.5" CAL.	B&B	FULL, MATCHING
5	QB	QUERCUS BICOLOR	SWAMP WHITE OAK	3-3.5" CAL.	B&B	
7	QP	QUERCUS PALUSTRIS 'PACIFIC BRILLIANCE'	PIN OAK	3-3.5" CAL.	B&B	FULL12
12	TA	TILIA AMERICANA 'REDMOND'	REDMOND LINDEN	3-3.5" CAL.	B&B	FULL
8	AB	AMELANCHIER 'AUTUMN BRILLIANCE'	AUTUMN BRILLIANCE SHAD	8-10" HT.	B&B	
1	RP	AMELANCHIER CANADENSIS 'RAINBOW PILLAR'	RAINBOW PILLAR SHAD	8-10" HT.	B&B	LIMBED TO 6'
9	AC	AMELANCHIER CANADENSIS	SHAD	5-6" HT.	B&B	MULTI-STEM
5	CF	CORNUS FLORIDA 'CLOUDE NINE'	FLOWERING DOGWOOD	2-2.5" CAL.	B&B	WHITE
7	VK	CRATAEGUS 'WINTER KING'	WINTER KING HAWTHORN	2-2.5" CAL.	B&B	LIMBED TO 6'
7	MA	MALUS X 'ADIRONACK'	ADIRONACK CRAB APPLE	2-2.5" CAL.	B&B	LIMBED TO 6'
3	OA	OXYDENDRUM ARBOREUM	SOURWOOD	2-2.5" CAL.	B&B	
5	OV	OSTRYA VIRGINIANA	AMERICAN HOPHORNBEAM	2-2.5" CAL.	B&B	
EVERGREENS						
13	AH	ILEX OPACA 'SATYR HILL'	SATYR HILL HOLLY	7-8" HT.	B&B	FEMALE
3	JV	JUNIPERUS VIRGINIANA 'EMERALD SENTINEL'	RED CEDAR	7-8" HT.	B&B	FULL
32	GG	THUJA 'GREEN GIANT'	GREEN GIANT ARBORVITAE	8-9" HT.	B&B	
17	TN	THUGA OCCIDENTALIS 'NIGRA'	DARK ARBORVITAE	7-8" HT.	b&b	
54	TO	THUJA OCCIDENTALIS 'DEGROOT'S SPIRE'	DEGROOT'S SPIRE ARBORVITAE	6-7" HT.	B&B	

QTY	KEY	BOTANICAL NAME	COMMON NAME	SIZE	ROOT
SHRUBS					
7	AA	ARONIA ARBUTIFOLIA 'BRILLIANTISSIMA'	RED CHOCBERRY	2-3" HT.	CONT.
18	JT	CEANOTHUS AMERICANUS	JERSEY TEA	18-24" HT.	CONT.
36	CA	CLETHRA ALNIFOLIA	CLETHRA	3-4" HT.	CONT.
12	HB	CLETHRA 'HUMMINGBIRD'	HUMMINGBIRD CLETHRA	2-3" HT.	CONT.
10	HA	HYDRANGEA ARBORESCENS 'ANNABELLE'	ANNABELLE HYDRANGEA	2-3" HT.	CONT.
10	HQ	HYDRANGEA QUERCIFOLIA	OAKLEAF HYDRANGEA	2-3" HT.	CONT.
120	IG	ILEX GLABRA 'SHAMROCK'	COMPACT INKBERRY	2-3" HT.	CONT.
8	IV	ILEX VERTICILLATA 'WINTER RED'	WINTER RED WINTERBERRY	2-3" HT.	CONT.
30	IT	ITEA VIRGINICA	VIRGINIA SWEETSPICE	2-3" HT.	CONT.
32	JE	JUNIPERUS COMMUNIS 'EFFUSA'	COMMON JUNIPER	18-24" SPR.	CONT.
19	JO	JUNIPERUS 'GREY OWL'	GREY OWL JUNIPER	24-30" HT.	CONT.
35	LA	LEUCOTHOE AXILLARIS 'SARAH'S CHOICE'	LEUCOTHOE	15-18" HT.	CONT.
57	LB	LINDERA BENZON	SPICEBUSH	2-3" HT.	CONT.
40	MP	MYRTICA PENNSYLVANICA	NORTHERN BAYBERRY	2-3" HT.	CONT.
47	NB	PHYSCARPUS OPULIFOLIS 'AMBER JUBILEE'	AMBER JUBILEE NINEBARK	3-4" HT.	CONT.
22	PO	POTENTILLA 'DAKOTA SUNSPOT'	DAKOTA SUNSPOT CINQUEFOIL	2-3" HT.	CONT.
19	RC	RHODODENDRON CAROLINIANUM	CAROLINA RHODODENDRON	2-3" HT.	CONT.
11	RM	RHODODENDRON MAXIMUM	ROSEBAY RHODODENDRON	3-4" HT.	B&B
11	GL	RHUS AROMATICA 'GRO-LOW'	GRO-LOW SUMAC	2-3" SPR.	CONT.
18	RV	ROSA VIRGINIANA	VIRGINIA ROSE	2-3" HT.	CONT.
7	VA	VIBURNUM ACERFOLIA	MAPLELEAF VIBURNUM	3-4" HT.	B&B
8	VC	VIBURNUM CASSINOIDES	WILD RAISIN	3-4" HT.	B&B
24	VD	VIBURNUM DENTATUM 'BLUE MUFFIN'	BLUE MUFFIN ARROWWOOD	36-42" HT.	CONT.
7	VL	VIBURNUM LENTAGO	NANNYBERRY	3-4" HT.	B&B
24	VN	VIBURNUM NUDEM 'WINTERHUR'	SMOOTH WITHEROD	3-4" HT.	B&B
34	VR	VIBURNUM RHYTIDOPHYLLUM	LEATHERLEAF VIBURNUM	3-4" HT.	B&B

QTY	KEY	BOTANICAL NAME	COMMON NAME	ROOT
GROUNDCOVERS & PERENNIALS				
5	AU	ARCOTOPHYLOS UVA-URSI	BEARBERRY	1 GAL.
10	BC	AMSONIA 'BLUE ICE' OR 'SHORT STACK'	BLUE ICE AMSONIA	1 QT.
25	CM	CIMIFUGA RACEMOSA	FAIRLYCANDLES	1 GAL.
25	HF	DENNSTAEDIA PUNCTILOBA	HAYSCENTED FERN	1 QT.
25	PA	PACKERA AUREA	GOLDEN GROUNDSEL	1 QRT.
5	SG	PANICUM VIRGATUM 'HEAVY METAL'	HEAVY METAL SWITCHGRASS	1 GAL.
25	CF	POLYSTICHUM ACROSTICHOIDES	CHRISTMAS FERN	1 GAL.

### LEGEND

	PROPERTY LINE
	WETLAND LINE
	WATERCOURSE LINE
	100' UPLAND REVIEW AREA
	EXISTING CONTOUR
	PROPOSED CONTOUR (BY OTHERS)
	EX. EVERGREEN/DECIDUOUS TREE TO REMAIN (APPROX. LOCATION)
	NEW EVERGREEN TREE
	NEW DECIDUOUS SHADE TREE
	NEW SMALL FLOWERING TREE
	NEW SHRUB
	NEW / EX. LAWN
	PROPOSED SINGLE HEAD LIGHT POLE
	PROPOSED WALL MOUNTED LIGHT
	PROPOSED BOLLARD LIGHT

#### REVISIONS:

1-25-24 REVISIONS PER ARB

PROJECT NO: G5081-001

DATE: 1/2/2024

FILE: Drawing1.dwg

DRAWN BY: KET

DESIGNED/CHECKED BY: MEP

APPROVED BY: KET

### LANDSCAPING & LIGHTING PLAN

SCALE: 1"=30'

LP-1



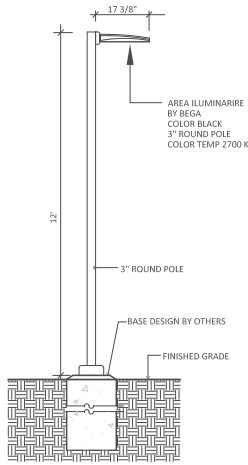

**BEGA**



- NOTE:
1. LIGHT FIXTURE & POLE BY BEGA PRODUCTS.
  2. POLE AND FIXTURE COLOR SHALL BE BLACK.
  3. INSTALL LIGHT POLE AND FOOTING PER MANUFACTURER'S RECOMMENDATIONS.

#### POLE LIGHT (TYP.)

SCALE: NOT TO SCALE

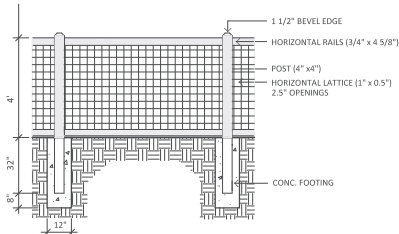

- NOTE:
1. FENCE SHALL BE MADE OF VINYL.
  2. COLOR SHALL MATCH BUILDING COLOR, "ANTHRACITE GREY".

#### LATTICE SCREENING FENCE (4' HT.) FOR AIR HANDLERS

SCALE: NOT TO SCALE

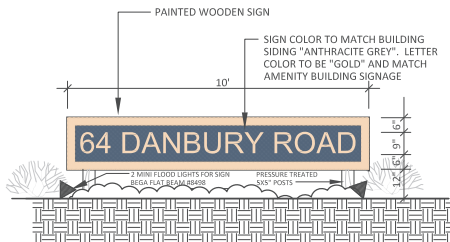

#### FREE STANDING SIGN (SIGN AREA 17.5 SF)

SCALE: NTS

#### LANDSCAPE LIGHTING NOTES (TYP.):

1. FOOTCANDLE LIGHTING LEVELS FOR THIS PROJECT WERE PREPARED BY OTHERS.
2. SITE LIGHTING INFORMATION AND LIGHTING PLANS PREPARED BY ENVIRONMENTAL LAND SOLUTIONS, LLC ARE DESIGNED FOR GENERAL LANDSCAPE AESTHETIC PURPOSES ONLY. LIGHTING INFORMATION SHOWN ON THIS PLAN SHALL NOT BE USED FOR SECURITY OR SAFETY PURPOSES.
3. THIS PLAN ASSUMES THAT THE BUILDING WILL HAVE WALL MOUNTED FIXTURES (BY OTHERS) TO LIGHT THE FACADE AND ADJACENT LANDSCAPE AREAS (INCLUDING WALKS AND DOORS).
4. INSTALL LIGHT FIXTURES AS RECOMMENDED BY THE MANUFACTURER.
5. LIGHT POLES LOCATED WITHIN LANDSCAPE AND PEDESTRIAN AREAS SHALL BE ON A BASE FLUSH WITH GRADE LOCATED A MINIMUM OF 3' FROM THE EDGE OF VEHICLE PAVEMENT IF FEASIBLE.

- NOTE:
1. PROVIDE LIGHT # 84510 BY BEGA PRODUCTS.
  2. FIXTURE COLOR SHALL BE BLACK.
  3. INSTALL LIGHT PER MANUFACTURER'S RECOMMENDATIONS.



#### SIGN LIGHT (TYP.)

SCALE: NOT TO SCALE

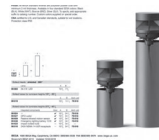

- NOTE:
1. LIGHT FIXTURE BY BEGA PRODUCTS # 9986/K3/99619.
  2. FIXTURE COLOR SHALL BE BLACK.
  3. INSTALL PER MANUFACTURER'S RECOMMENDATIONS.

#### BOLLARD LIGHT (TYP.)

SCALE: NOT TO SCALE

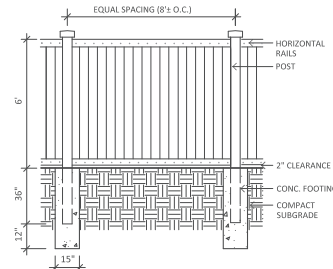

- NOTE:
1. FENCE COLOR SHALL MATCH BUILDINGS. "ANTHRACITE GREY".

#### VINYL SCREENING FENCE (TYP.)

SCALE: NOT TO SCALE

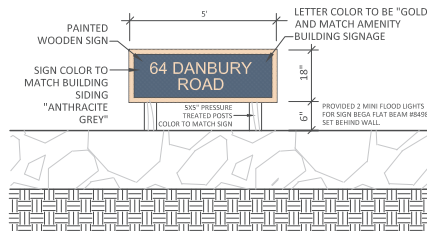

#### SIGN BEHIND EXISTING ENTRANCE WALL

SCALE: NTS

#### NOTES:

1. EXISTING AND PROPOSED SITE INFORMATION TAKEN FROM A DIGITAL AUTOCADD SITE PLAN SUPPLIED BY TIGHE&BOND. REFER TO THESE SITE PLANS FOR ADDITIONAL INFORMATION.
2. CONTACT "CALL BEFORE YOU DIG" AT 1-800-922-4455 TO HAVE UNDERGROUND UTILITY LINES MARKED BY THEM PRIOR TO START OF ANY EXCAVATION WORK.
3. SEED AREAS AT THE METHODS AND 125% THE APPLICATION RATE RECOMMENDED BY THE MANUFACTURER. THE SEED SHALL BE SPREAD ON THE PREPARED SOIL, LIGHTLY RAKED TO ESTABLISH GOOD SOIL CONTACT AFTER SOWING, AND MULCHED WITH A 2 INCH LOOSE LAYER OF CLEAN OAT STRAW OR COMMERCIAL WOOD FIBER PRODUCTS APPLIED BY HAND OR BY HYDROSEEDING ON SLOPES LESS THAN 10%. SEED AREAS ON SLOPES ON OR GREATER THAN 10% SHALL BE COVERED WITH A PLASTIC-FREE AND 100% BIODEGRADABLE (INCLUDING ANCHOR STAPLES) EROSION CONTROL BLANKET. A NURSE CROP OF PERENNIAL RYE GRASS AT THE RATE OF 40 LBS./ACRE SHALL BE ADDED TO THE SEED MIX ON SLOPES OF EXCESS OF 10% AND AS SPECIFIED. SEED MIX SUBSTITUTIONS SHALL BE EQUIVALENT TO THAT SPECIFIED AND APPROVED BY THE PROJECT LANDSCAPE ARCHITECT PRIOR TO USE. UNLESS OTHERWISE SPECIFIED, MAINTAIN SEED AREAS AS RECOMMENDED BY THE MANUFACTURER. EXCEPT FOR LAWN AREAS, DO NOT FERTILIZE AREAS TO BE SEED UNLESS SPECIFIED BY THE MANUFACTURER. SEED AREAS AS PER THE FOLLOWING SCHEDULE:
- A. LAWN- SEED LAWN AREAS WITH "SMART SEED NORTHEAST" MIX BY PENNINGTON SEED, INC. OR APPROVED EQUIVALENT. APPLY SOIL AMENDMENTS AS RECOMMENDED BY THE MANUFACTURER.
- B. WETLAND BUFFERS (UPLAND AREAS): SEED THIS AREA WITH "NEW ENGLAND CONSERVATION / WILDLIFE SEED MIX" BY FROM NEW ENGLAND WETLAND PLANTS, INC. (413-848-8000).
4. IF SPECIFIED SEEDING CAN NOT OCCUR DUE TO SEASONAL AND WEATHER CONDITIONS, TEMPORARY SEED DISTURBED UPLAND AREAS WITH A MIXTURE OF ANNUAL RYE AT 20 LBS./ACRE, PERENNIAL RYE AT 20 LBS./ACRE, AND REDTOP AT 2 LBS./ACRE AND DISTURBED WETLAND AREAS WITH ANNUAL RYE AT THE RATE OF 30 LBS./ACRE. MULCHING, WITHOUT SEEDING, MAY BE USED DURING THE NON-GROWING SEASON IN ACCORDANCE WITH THE THE "CONNECTICUT GUIDELINES FOR SOIL EROSION AND SEDIMENT CONTROL (2002)".
5. EXACT LOCATION OF PROPOSED PLANTINGS AND SPECIES TYPES MAY VARY FROM THIS PLAN BASED ON ACTUAL FIELD CONDITIONS.
6. SPRAY NEW PLANTINGS IMMEDIATELY AFTER INSTALLATION WITH A WHITE-TAILED DEER REPELLENT AND CONTINUE AS NEEDED TO MAINTAIN PLANTS FREE OF SIGNIFICANT DEER BROWSING.
7. PLANT SPECIES SUBSTITUTIONS MAY BE MADE WITH THE APPROVAL OF THE PROJECT LANDSCAPE ARCHITECT AND TOWN OF WILTON PRIOR TO PLANTING. SUBSTITUTED PLANTS SHALL BE AT AN EQUAL OR GREATER SIZE AS NOTED USING A SIMILAR TYPE PLANT.
8. MULCH AREAS AROUND NEW TREES AND SHRUBS WITH A 3" THICK LAYER OF SHREDDED CEDAR BARK MULCH. NEW TREES SHALL EACH HAVE A 9" MIN. DIA. MULCHED BED AND NEW SHRUBS SHALL EACH HAVE A MINIMUM 3" DIAMETER MULCHED BED. AREAS WITHIN 4" OF TREE TRUNKS SHALL BE MAINTAINED FREE OF MULCH.
9. PLANTING METHODS SHALL BE IN ACCORDANCE WITH THE "AMERICAN STANDARDS FOR NURSERY STOCK," LATEST EDITION, AS PUBLISHED BY THE AMERICAN NURSERY & LANDSCAPE ASSOCIATION.
10. THE CONTRACTOR SHALL VERIFY WITH THE PROJECT ENGINEER THAT THE NEW PLANTINGS DO NOT INTERFERE WITH EXISTING AND/OR PROPOSED UTILITIES, SIGHT LINES, AND/OR STRUCTURES.
11. THIS PLAN FOR PLANTING PURPOSES ONLY. SEE PLANS BY OTHERS FOR ADDITIONAL INFORMATION.
12. NONNATIVE INVASIVE MANAGEMENT- REMOVE JAPANESE BARBERRY, BURNINGBUSH, ASIATIC BITTERSWEET, MULTIFLORA ROSE AND NOTED NORWAY MAPLES UNDER 3" CALIPER FROM WETLAND AND ADJACENT UPLAND AREAS BY HAND PULLING, OR IF NOT PRACTICAL, CUTTING THE PLANTS DOWN TO JUST ABOVE GRADE AND APPLYING AN APPROPRIATE HERBICIDE, SUCH AS ROUNDUP IN UPLAND AREAS AND IMAZAPHR (TRADE NAME: HABITAT) IN WET CONDITIONS, INTO THE STEM WELLS. SEVERAL TREATMENT MAY BE REQUIRED. THE PERIOD BETWEEN JULY AND OCTOBER IS THE PREFERRED TIMING TO APPLY HERBICIDE. NONNATIVE INVASIVE PLANTS SHALL BE MANAGED FOR A MINIMUM OF FIVE YEARS.

#### NONNATIVE INVASIVE SPECIES CONTROL NOTES:

1. CONTROL PERIOD OF NONNATIVE INVASIVE PLANTS TO BE ONGOING OVER A FIVE (5) YEAR PERIOD (OR LONGER).
2. THE LANDSCAPE CONTRACTOR SHALL CONTACT THE PROJECT ENVIRONMENTAL CONSULTANT WITH ANY QUESTIONS REGARDING THE CONTROL OR IDENTIFICATION OF INVASIVE NONNATIVE SPECIES.
3. THE LANDSCAPE CONTRACTOR SHALL FOLLOW THE METHODS AND RECOMMENDATIONS RECOMMENDED BY THE HERBICIDE MANUFACTURER AND COMPLY WITH ALL FEDERAL, STATE AND LOCAL LAWS. A PERMIT FROM DEEP IS REQUIRED FOR ANY PESTICIDE APPLICATION TO A BODY OF WATER.
4. ALL CUT OR PULLED INVASIVE NONNATIVE PLANT MATERIALS SHALL BE DISPOSED APPROPRIATELY AND COMPLY WITH THE 2004 DEEP / UCONN "GUIDELINES FOR DISPOSAL OF TERRESTRIAL INVASIVE PLANTS." ALL CUTTINGS SHALL BE COLLECTED AND PLACED ONSITE ON A PLASTIC TARP (OR ON AN ASPHALT PAVEMENT AREA) AND SUN DRIED UNTIL DEAD. AVOID CUTTINGS FROM BEING IN CONTACT WITH ANY SOIL. DEAD PLANTS SHALL BE BAGGED AND DEPOSITED AT AN INCINERATOR WASTE FACILITY (NOT A COMPOSTING FACILITY).
5. START CONTROL OF INVASIVE PLANT SPECIES PRIOR TO THE START OF EARTH MOVING ACTIVITIES. CONTROL NONNATIVE INVASIVE SPECIES AS FOLLOWS:
  - A. FOR JAPANESE KNOTWEED, EUONYMUS, ASIATIC BITTERSWEET, AND NORWAY MAPLES CONTROL.
    - STEP #1 (PRIOR TO HERBICIDE TREATMENT): CUT PLANT DOWN TO GRADE LEVEL DURING THE GROWING SEASON (LATE SUMMER OR EARLY FALL IS PREFERABLE). REMOVE ASIATIC BITTERSWEET ROOTS IF FEASIBLE. DISPOSE OF CUT PLANT MATERIAL AS OUTLINED ABOVE.
    - STEP #2: IMMEDIATELY AFTER CUTTING, TREAT CUT STEMS WITH AN APPROPRIATE HERBICIDE (SUCH AS ROUND-UP) AT THE RATE AND METHODS RECOMMENDED BY THE MANUFACTURER. CARE SHALL BE TAKEN TO AVOID HERBICIDE CONTACT WITH NATIVE OR OTHER DESIRABLE VEGETATION.
    - STEP #3: CHECK CONTROL AREA MONTHLY DURING THE GROWING SEASON FOR NEW GROWTH. SPOT TREAT NEW GROWTH WITH AN APPROPRIATE HERBICIDE AS NEEDED FOR CONTROL.
  6. CARE SHALL BE TAKEN TO AVOID HERBICIDE CONTACT WITH NATIVE OR OTHER DESIRABLE VEGETATION. IN AREAS WHERE NATIVE PLANTS ARE GROWING NEAR PLANTS TO BE CONTROLLED, THE HERBICIDE SHALL NOT BE SPRAYED ONTO THE TARGET PLANTS. IN THESE AREAS THE HERBICIDE SHALL BE APPLIED WITH A BRUSH OR CLOTH.

#### NONNATIVE INVASIVE DISPOSAL:

##### PLANT DISPOSAL

1. ALL CUT OR PULLED INVASIVE NONNATIVE PLANT MATERIALS SHALL BE DISPOSED APPROPRIATELY AND COMPLY WITH THE 2004 DEEP / UCONN "GUIDELINES FOR DISPOSAL OF TERRESTRIAL INVASIVE PLANTS." ALL CUTTINGS SHALL BE COLLECTED AND PLACED ONSITE ON A PLASTIC TARP (OR ON AN ASPHALT PAVEMENT AREA) AND SUN DRIED UNTIL DEAD. AVOID CUTTINGS FROM BEING IN CONTACT WITH ANY SOIL. IF FEASIBLE, DO NOT REMOVE PULLED OR CUT NONNATIVE INVASIVE PLANTS FROM THE SITE UNTIL DEAD. EXCEPT FOR TUBEROUS PLANTS, SUCH AS JAPANESE KNOTWEED AND PHORADENDRA, NONNATIVE INVASIVE PLANTS PULLED OR CUT SHALL BE LEFT ON THE GROUND SURFACE IN A SUNNY LOCATION FOR THEIR ROOTS TO DRY. TUBEROUS WEED PLANTS SHALL BE LEFT SOIL FREE IN THE SUN ON AN IMPERVIOUS BARRIER (SUCH AS BLACK PLASTIC, DRIVEWAYS AND WALKS) UNTIL DEAD SO THAT THEY DO NOT RE-SPROUT.
2. IF PLANTS HAVE TO BE REMOVED FROM THE SITE BEFORE THEY ARE DEAD, THEY SHALL BE BAGGED AND DEPOSITED AT AN INCINERATOR WASTE FACILITY (NOT A COMPOSTING FACILITY).

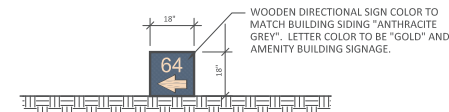

#### DIRECTIONAL SIGN (SIGN AREA 2.25 SF)

SCALE: NTS

**Tighe&Bond**  
1000 Bridgeport Avenue  
Suite 320  
Shelton, CT 06484  
(203) 712-1100

ENVIRONMENTAL LAND SOLUTIONS, LLC  
LANDSCAPE ARCHITECTURE  
1000 BRIDGEPORT AVENUE  
SUITE 320  
SHELTON, CT 06484  
(203) 712-1100

THIS DOCUMENT IS INCOMPLETE AND IS RELEASED TEMPORARILY FOR PROCESS REVIEW ONLY. IT IS NOT INTENDED FOR BIDDING OR CONSTRUCTION PURPOSES.

**Fuller Development LLC**

64 Danbury Road

Wilton, Connecticut

PROJECT NO: G081-001  
DATE: 1-2-24  
FILE: ELS PROJECT # 2130  
DRAWN BY: KET  
DESIGNED/CHECKED BY: NEP  
APPROVED BY: KET

#### DETAILS AND NOTES

SCALE: AS NOTED

LP-2





Luminaire Schedule					
Qty	Label	Watts	Arrangement	LLF	Description
6	BL	34	Single	0.900	BEGA 99865+K27 / 99619 / 22" BOLLARD
32	SL	41	Single	0.900	BEGA 99515+K27 / MTD 12FT AFG
31	WP	35	Single	0.900	Bega 66457+K27 / Mounted at 11FT AFG

Calculation Summary							
Label	Units	Avg	Max	Min	Avg/Min	Max/Min	Grid Height
CalcPts_1	Fc	1.08	43.5	0.0	N.A.	N.A.	0
PARKING AND DRIVE LANES	Fc	1.87	10.5	0.1	18.70	105.00	

Project:  
23290 - 64 Danbury Road, Wilton

Contact:  
Cliff Gilbert  
Specifications - Southern CT  
(203) 788-0814  
cgilbert@illuminatene.com

**illuminate**  
263 Winn Street  
Burlington, MA 01803  
(781) 935-8500  
333 Pleasant Valley Road  
South Windsor, CT 06074  
(860) 282-0597

Detail: Photometric Calculation  
Date: 1/23/2024  
Revision: C  
Scale: 1" = 30'-0"  
Drawn By: AJS

Drawing Number:

L-1





Luminaire Schedule					
Qty	Label	Watts	Arrangement	LLF	Description
6	BL	34	Single	0.900	BEGA 99865+K3 / 99619 / 22" BOLLARD
56	SL	56.8	Single	0.900	BEACON VP-ST-1-36L-55-3K7-4W / MTD 12FT AFG
43	WP	45.1	Single	0.900	BEACON TRP2-36L-39-3K7-4W / MTD 11FT AFG

Calculation Summary							
Label	Units	Avg	Max	Min	Avg/Min	Max/Min	Grid Height
CalcPts_1	Fc	2.72	41.7	0.0	N.A.	N.A.	0
PARKING AND DRIVE LANES	Fc	5.13	10.6	2.5	2.05	4.24	

Project:  
23290 - 64 Danbury Road, Wilton  
Alternative

Contact:  
Cliff Gilbert  
Specifications - Southern CT  
(203) 788-0814  
cgilbert@illuminatene.com

Detail: Photometric Calculation  
Date: 1/2/2024  
Revision: ----  
Scale: 1" = 30'-0"  
Drawn By: AJS

**illuminate**  
263 Winn Street  
Burlington, MA 01803  
(781) 935-8500

333 Pleasant Valley Road  
South Windsor, CT 06074  
(860) 282-0597

Drawing Number:

L-1

Sheet 1 of 1



Application

LED pole-top luminaire with asymmetrical light distribution designed for the illumination of parking areas and roadways. Tool-less entry with hinged door for ease of maintenance. Provided with slip fitter to fit 3" O.D. poles.

Materials

Luminaire housing and pole fitter constructed of die-cast marine grade, copper free ( $\leq 0.3\%$  copper content) A360.0 aluminum alloy  
Clear safety glass with anti-reflective coating for increased transmission  
Reflector made of pure anodized aluminum  
Silicone applied robotically to casting, plasma treated for increased adhesion  
High temperature silicone gasket  
Mechanically captive stainless steel fasteners

NRTL listed to North American Standards, suitable for wet locations  
Protection class IP 66

Weight: 9.7 lbs.

EPA (Effective projection area): 0.32 sq. ft.

Electrical

Operating voltage	120-277V AC
Minimum start temperature	-30° C
LED module wattage	33.6 W
System wattage	41.0 W
Controllability	0-10V dimmable
Color rendering index	Ra > 80
Luminaire lumens	3,559 lumens (3000K)
Lifetime at Ta = 15° C	> 500,000 h (L70)
Lifetime at Ta = 55° C	181,000 h (L70)

LED color temperature

4000K - Product number + **K4**  
3500K - Product number + **K35**  
3000K - Product number + **K3**  
2700K - Product number + **K27**

BEGA can supply you with suitable LED replacement modules for up to 20 years after the purchase of LED luminaires - see website for details

Finish

All BEGA standard finishes are matte, textured polyester powder coat with minimum 3 mil thickness.

Available colors	Black (BLK)	White (WHT)	RAL:
	Bronze (BRZ)	Silver (SLV)	CUS :

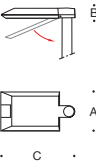

Pole-top luminaire · Asymmetrical light distribution				
	LED	A	B	C
99515	33.6 W	10	2 3⁄8	17 3⁄8

Recommended for use with 20' to 30' poles

BEGA 1000 BEGA Way, Carpinteria, CA 93013 (805) 684-0533 info@bega-us.com

Due to the dynamic nature of lighting products and the associated technologies, luminaire data on this sheet is subject to change at the discretion of BEGA North America. For the most current technical data, please refer to bega-us.com  
© copyright BEGA 2018 Updated 01/17/19

Type:  
BEGA Product:  
Project:  
Modified:





LED wall mount luminaires - Asymmetrical flat beam light distribution

BEGA

Application

LED wall mount luminaire with asymmetrical flat beam light distribution designed for the illumination of parking areas and roadways.

Materials

Luminaire housing and mounting canopy constructed of die-cast marine grade, copper free ( $\leq 0.3\%$  copper content) A360.0 aluminum alloy  
Clear safety glass with anti-reflective coating for increased transmission  
Reflector made of pure anodized aluminum  
Silicone applied robotically to casting, plasma treated for increased adhesion  
High temperature silicone gasket  
Mechanically captive stainless steel fasteners

**NRTL** listed to North American Standards, suitable for wet locations  
Protection class IP 66  
Weight: 9.3lbs

Electrical

Operating voltage	120-277VAC
Minimum start temperature	-30°C
LED module wattage	31.4 W
System wattage	35.0 W
Controllability	0-10V, TRIAC, and ELV dimmable
Color rendering index	Ra > 80
Luminaire lumens	4,555 lumens (3000K)
LED service life (L70)	60,000 hours

LED color temperature

4000K - Product number + **K4**  
3500K - Product number + **K35**  
3000K - Product number + **K3**  
2700K - Product number + **K27**  
Amber - Product number + **AMB**

Wildlife friendly amber LED - Optional

Luminaire is optionally available with a narrow bandwidth, amber LED source (585-600nm) approved by the FWC. This light output is suggested for use within close proximity to sea turtle nesting and hatching habitats. Electrical and control information may vary from standard luminaire.

LED module wattage	35.2 W (Amber)
System wattage	41.1 W (Amber)
Luminaire lumens	1,285 lumens (Amber)

**BEGA** can supply you with suitable LED replacement modules for up to 20 years after the purchase of LED luminaires - see website for details

Finish

All BEGA standard finishes are matte, textured polyester powder coat with minimum 3 mil thickness.

Available colors	Black (BLK)	White (WHT)	RAL:
	Bronze (BRZ)	Silver (SLV)	CUS:

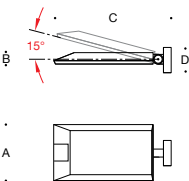

Wall mount luminaire - Asymmetrical flat beam

	LED	A	B	C	D
<b>66 457</b>	31.4 W	10	2 <sup>3</sup> / <sub>8</sub>	16 <sup>1</sup> / <sub>8</sub>	5 <sup>1</sup> / <sub>8</sub>

Type:

BEGA Product:

Project:

Modified:





BEGA LED system bollard - luminaire head  
with shielded light - 360°

**Enclosure:** Housing constructed of die-cast aluminum. Die-castings are marine grade, copper free (≤ 0.3% copper content) A360.0 aluminum alloy. Glass diffuser, inside white. Fully gasketed for weather tight operation using molded silicone gasket.

**Installation:** BEGA LED system bollards are designed for easy attachment to system bollard tubes using an interlocking stainless steel mechanism and stainless steel set screw threaded into stainless steel insert. An accompanying bollard tube must be selected for proper installation, see below chart for compatible tube options.

**Electrical:** 29.4W LED luminaire, 34 total system watts, -30°C start temperature. Integral 120V through 277V electronic LED driver, 0-10V dimming. LED module(s) are available from factory for easy replacement. Standard LED color temperature is 3000K with a >80 CRI. Available in 4000K (>80 CRI); add suffix K4 to order.z

**Note:** LEDs supplied with luminaire. Due to the dynamic nature of LED technology, LED luminaire data on this sheet is subject to change at the discretion of BEGA-US. For the most current technical data, please refer to [www.bega-us.com](http://www.bega-us.com).

**Finish:** All BEGA standard finishes are polyester powder coat with minimum 3 mil thickness. Available in four standard BEGA colors: Black (BLK); White (WHT); Bronze (BRZ); Silver (SLV). To specify, add appropriate suffix to catalog number. Custom colors supplied on special order.

**CSA** certified to U.S. and Canadian standards, suitable for wet locations. Protection class IP65

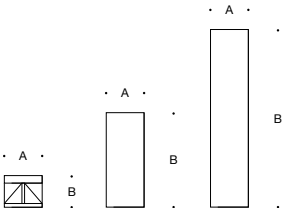

Bollard heads · shielded · 360°

Lamp	A	B
99 865 29.4 W LED	10 3⁄8	7 5⁄8

Bollard tubes for luminaire heights 19 3⁄4 · 22 1⁄2

	A	B	Anch. unit
99 619	10 1⁄2	14 1⁄2	79 818

Bollard tubes for luminaire heights 37 5⁄8 · 42 1⁄4

Integrated components	Door	A	B	Anch. unit
99 624 —	✓	10 3⁄8	34 1⁄2	79 818
99 627 GFCI outlet	✓	10 3⁄8	34 1⁄2	79 818
99 659 Passive infrared motion sensor	✓	10 3⁄8	34 1⁄2	79 818
99 636 Emergency lighting battery 10 W	✓	10 3⁄8	34 1⁄2	79 818
84 623 Impact bollard tube	—	10 3⁄8	34 1⁄2	—
98 010 240V NEMA 14-50R receptacle	—	10 3⁄8	34 1⁄2	79 818

Type:  
BEGA Product:  
Project:  
Voltage:  
Color:  
Options:  
Modified:







#### Floodlights

with mounting canopy or 1/2" I.P.S. nipple

A series of compact rectangular floodlights with mounting canopy or 1/2" I.P.S. nipple. Available in various sizes and distributions this family of luminaires sets the floodlighting standard with regards to cost effectiveness, compactness and efficiency.

Die-cast aluminum · Safety glass · Reflector made of pure anodized aluminum  
LED color temperatures: 2700 K, 3000 K, 3500 K, 4000 K

BEGA luminaires offer a minimum service life of 60,000 hours, with suitable LED replacement modules guaranteed for up to 20 years after date of purchase. Further LED technical data including luminous flux, CRI, dimming and electrical characteristics are provided on the individual luminaire specification sheets, available at [www.bega-us.com](http://www.bega-us.com)

All BEGA standard finishes are matte, textured powder coat with minimum 3 mil thickness. BEGA Unidure® finish, a fluoropolymer technology, provides superior fade protection in Black, Bronze, and Silver. BEGA standard White, as well as optionally available RAL and custom colors, are a polyester powder.

NRTL listed to North American standards · Suitable for wet locations  
Protection class IP 65

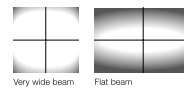

#### Floodlights with mounting canopy · very wide

	LED	β	A	B	C	D	
<b>84 507</b>	9.8 W	78/90°	6 1/2	7 1/4	3 1/2	4	<b>70 500</b>
<b>77 538</b>	17.6 W	75/88°	6 1/2	7 1/4	3 1/2	4	<b>70 500</b>
<b>77 539</b>	23.6 W	87/93°	9	8 1/4	4	4	<b>70 502</b>
<b>77 582</b>	65.6 W	82/93°	11 1/2	10 1/2	5	4	<b>70 525</b>

#### Floodlights with mounting canopy · flat beam

	LED	β	A	B	C	D	
<b>84 510</b>	9.8 W	29/87°	6 1/2	7 1/4	3 1/2	4	<b>70 500</b>
<b>77 536</b>	17.6 W	29/86°	6 1/2	7 1/4	3 1/2	4	<b>70 500</b>
<b>77 537</b>	23.6 W	39/94°	9	8 1/4	4	4	<b>70 502</b>
<b>77 584</b>	65.6 W	32/88°	11 1/2	10 1/2	5	4	<b>70 525</b>



#### Floodlights with 1/2" I.P.S. nipple · very wide

	LED	β	A	B	C	
<b>84 506</b>	9.8 W	78/90°	6 1/2	7	3 1/2	<b>70 500</b>
<b>77 479</b>	17.6 W	75/88°	6 1/2	7	3 1/2	<b>70 500</b>
<b>77 486</b>	23.6 W	87/93°	9	8 1/4	4	<b>70 502</b>
<b>77 427</b>	65.6 W	82/93°	11 1/2	10 1/2	5	<b>70 525</b>

#### Floodlights with 1/2" I.P.S. nipple · flat beam

	LED	β	A	B	C	
<b>84 511</b>	9.8 W	29/87°	6 1/2	7	3 1/2	<b>70 500</b>
<b>77 478</b>	17.6 W	29/86°	6 1/2	7	3 1/2	<b>70 500</b>
<b>77 485</b>	27.6 W	39/94°	9	8 1/4	4	<b>70 502</b>
<b>77 434</b>	65.6 W	32/94°	11 1/2	10 1/4	5	<b>70 525</b>

180° glare shield β = Beam angle

Page 400



1/2" I.P.S. nipple  
accessories 19 583  
(surface mounted conduit  
wiring box) and 19 584  
(direct burial wiring box)  
available.

Page 184



Outrigger arm and mounting box

