

GREGORY AND ADAMS, P.C.

PAUL H. BURNHAM
DANIEL L. CONANT*
TREVOR CONLOW§
SUSAN L. GOLDMAN
J. VANCE HANCOCK

J. CASEY HEALY
MICHAEL LAMAGNA*
DERREL M. MASON*
MATTHEW C. MASON*

JAMES D'ALTON MURPHY*⊗
KATHLEEN L. ROYLE *
RALPH E. SLATER
ROGER R. VALKENBURGH *

ATTORNEYS AT LAW
190 OLD RIDGEFIELD ROAD
WILTON, CT 06897
(203) 762-9000
FAX: (203) 834-1628

ESTABLISHED 1964

NEW YORK OFFICE:
399 KNOLLWOOD ROAD - SUITE 201
WHITE PLAINS, NY 10603
(914) 848-5000

WWW.GREGORYANDADAMS.COM

JULIAN A. GREGORY
(1912 - 2002)

THOMAS T. ADAMS
(1929 - 2015)

PLEASE REPLY TO SENDER:
DANIEL CONANT
DIRECT DIAL: 203-571-6317
dconant@gregoryandadams.com

* ALSO ADMITTED IN NEW YORK

⊗ ALSO ADMITTED IN VERMONT

§ ADMITTED IN NY AND NJ ONLY

May 25, 2023

By E-mail and Hand Delivery

Planning and Zoning Commission

Town Hall Annex

238 Danbury Road

Wilton, CT 06897

Attn: Mr. Michael E. Wrinn – Director of Planning and Land Use Management

Re: ASML US, LLC – Application for Alternative Signage Program for Large Developments

Dear Mr. Chairman and Members of the Commission:

As attorneys for ASML US, LLC (ASML), we hereby submit the attached application to add the proposed Parking Guidance System (System) to the Premises pursuant to the Alternative Signage Program for Large Developments and our concurrent application to amend Section 29-8.A.2.b.10, titled Functional Types of Signs, of the Zoning Regulations of the Town of Wilton.

In support of ASML's application, we hereby submit one copy of each of the following:

1. Letter signed by Jason Domena on behalf of ASML as owner and applicant, authorizing Gregory and Adams to act as its Agent on all aspects of this project.
2. Application for Site Development Plan.
3. Letter from Gregory and Adams dated May 25, 2023.
4. Vicinity Sketch.
5. Zoning Location Survey (ZLS.1), prepared by Arthur H. Howland & Associates, dated November 11, 2021.
6. Existing Conditions plan (EX-01), prepared by Tighe & Bond, dated October 21, 2022.
7. Electronic Parking Guidance Signage Plan (C-801), prepared by Tighe & Bond.
8. Electronic Parking Guidance Signage Plan Enlargement (C-802), prepared by Tighe & Bond.
9. Data Sheet for Stackable Full-Matrix Display, prepared by Indect.
10. Data Sheet for Profile Sign IP65, prepared by Indect.

May 25, 2023

Page 2 of 2

11. Data Sheet for UMS – Ultrasonic Mini Sensor, prepared by Indect.
12. Photographs of 77 Danbury Road.
13. Copy of Resolution #1113-4Z, dated November 25, 2013, approving ASML's previous application under the alternative signage program.
14. List of Project Professionals.
15. Letter of Title.
16. Proof of Applicant's Legal Interest.

I also enclose my firm's check in the amount of \$460.00 in payment of the application fee.

Respectfully submitted,
Gregory and Adams, P.C.

By 
Daniel Conant

DC/ko

Enclosures

cc: Mr. Jason Domena – ASML US, LLC
Ms. Marilee Beebe, P.E. – WSP US
Mr. Joseph Canas, P.E. – Tighe & Bond
Mr. Matthew Valera - Parking Garage Systems, Inc.
Mr. James Murphy, Esq. – Gregory and Adams

GREGORY AND ADAMS, P.C.

PAUL H. BURNHAM
SUSAN L. GOLDMAN
J. VANCE HANCOCK
J. CASEY HEALY
MICHAEL LAMAGNA*
DERREL M. MASON*
MATTHEW C. MASON*
JAMES D'ALTON MURPHY*
KATHLEEN L. ROYLE *
RALPH E. SLATER
ROGER R. VALKENBURGH *

* ALSO ADMITTED IN NEW YORK
⊗ ALSO ADMITTED IN VERMONT

ATTORNEYS AT LAW
190 OLD RIDGEFIELD ROAD
WILTON, CT 06897
(203) 762-9000
FAX: (203) 834-1628

ESTABLISHED 1964

NEW YORK OFFICE:
399 KNOLLWOOD ROAD - SUITE 201
WHITE PLAINS, NY 10603
(914) 848-5000

WWW.GREGORYANDADAMS.COM

JULIAN A. GREGORY
(1912 - 2002)

THOMAS T. ADAMS
(1929 - 2015)

PLEASE REPLY TO SENDER:
JAMES D'ALTON MURPHY
DIRECT DIAL: 203-571-6309
jmurphy@gregoryandadams.com

October 28, 2021

By E-Mail Only

ASML US, LLC

Attn: Mr. Jason Domena, Senior Project Leader AM CRE Facility Management

Re: ASML US, LLC- Land Use Applications
Premises: 77 Danbury Road, Wilton, Connecticut

Dear Mr. Domena:

As you know, we are in the process of preparing land use applications to various Town of Wilton and State of Connecticut and other government agencies, if applicable. These agencies require written authorization from the applicant and the property owner authorizing Gregory and Adams, P.C. to act as its agent in connection with any and all land use matters involving the subject property. Please sign a copy of this letter as applicant and owner and return it to me by email.

Very truly yours,

James D'Alton Murphy

James D'Alton Murphy

JD'AM/ko

The undersigned hereby authorizes Gregory and Adams, P.C. to act as its agent in connection with the above-referenced matters.

ASML US, LLC

By:

Jason Domena

Its: Senior Project Leader

AM CRE Facility Management

Duly Authorized

**WILTON PLANNING AND
ZONING COMMISSION****SITE DEVELOPMENT
PLAN****SDP#**

SITE DEVELOPMENT PLAN: Cite specific section(s) of the Zoning Regulations and provide a detailed description of the proposed development. Attach additional sheets as required.

Section 29 -

The Applicant proposes the installation of signs and displays as part of a parking guidance system pursuant to the Alternative Signage Program for Large Developments in section 29-8.A.8. At present, the proposed signs and displays are not permitted under the regulations; the Applicant has submitted a concurrent application to amend the Zoning Regulations to permit parking guidance systems.

For additional information, please see the enclosed letter from Gregory and Adams dated May 25, 2023.

APPLICANT'S NAME**ADDRESS****OWNER'S NAME****ADDRESS****PROPERTY LOCATION****ZONING DISTRICT****WLR****VOLUME****PAGE****TAX MAP #****LOT #****ACREAGE*****THE FOLLOWING MATERIALS ARE REQUIRED:***

* Please see **SPECIAL INSTRUCTIONS FOR SUBMISSION DURING COVID** at:

[Application Forms / Materials | Wilton CT](#)

* All submitted plans and documents shall bear an **original signature, seal, and license number** of the professional responsible for preparing each item. Maps should be **folded, not rolled**.

_____ **VICINITY SKETCH** at a scale of 1"=100' or 1"=200'. Said map shall show all existing zone boundaries, existing buildings and parcels, labeled by their corresponding Tax Map and Lot Number, within 500' of the subject property.

_____ **CLASS A-2 SURVEY MAP** of the subject property.

_____ **SITE DEVELOPMENT PLAN** pursuant to Section 29-11 of the Zoning Regulations.

n/a **FORM B – ZONING DATA.**

_____ **LIST OF PROJECT PROFESSIONALS** including name, firm, address and telephone.

_____ **LETTER OF TITLE** certifying owner of record as of date of the application.

_____ **PROOF OF APPLICANT'S LEGAL INTEREST** in property.

_____ **ANY OTHER PLAN OR DOCUMENT** as required by Zoning Regulations.

_____ **ELECTRONIC SUBMISSION** of all materials, **consolidated into 1 or 2 PDFs maximum**, emailed to michael.wrinn@wiltonct.org and daphne.white@wiltonct.org

_____ **\$360 FILING FEE + \$50/Unit or \$50/2000 sq. ft.** payable to: **Town of Wilton.**

THE APPLICANT understands that this application is to be considered complete only when all information and documents required by the Commission have been submitted and is responsible for the payment of all legal notices incurred.

THE UNDERSIGNED WARRANTS the truth of all statements contained herein and in all supporting documents according to the best of his or her knowledge and belief; and hereby grants visitation and inspection of the subject property as described herein.

ASML US, LLC by its Agent Gregory and Adams, P.C.

Daniel Conant

APPLICANT'S SIGNATURE DATE EMAIL ADDRESS TELEPHONE

Daniel Conant

OWNER'S SIGNATURE DATE EMAIL ADDRESS TELEPHONE

For Planning and Zoning Department Use Only:

Mandatory Referrals - Jurisdiction/Agency		
	Yes	No
Village District Design Advisory Committee (VDDAC):		
Architectural Review Board (ARB):		
Western Connecticut Council of Governments (WestCOG):		
South Norwalk Electric and Water Company (SNEW) Designated Public Watershed:		
First Taxing District Water Department Designated Public Watershed:		
State-Designated Aquifer Protection Area:		
Adjoining Community Notification:		

GREGORY AND ADAMS, P.C.

ATTORNEYS AT LAW
190 OLD RIDGEFIELD ROAD
WILTON, CT 06897
(203) 762-9000
FAX: (203) 834-1628

ESTABLISHED 1964

NEW YORK OFFICE:
399 KNOLLWOOD ROAD - SUITE 201
WHITE PLAINS, NY 10603
(914) 848-5000

WWW.GREGORYANDADAMS.COM

JULIAN A. GREGORY
(1912 - 2002)

THOMAS T. ADAMS
(1929 - 2015)

PLEASE REPLY TO SENDER:
DANIEL L. CONANT
DIRECT DIAL: 203-571-6317
dconant@gregoryandadams.com

PAUL H. BURNHAM
DANIEL L. CONANT*
TREVOR CONLOW§
SUSAN L. GOLDMAN
J. VANCE HANCOCK
J. CASEY HEALY
MICHAEL LAMAGNA*
DERREL M. MASON*
MATTHEW C. MASON*
JAMES D'ALTON MURPHY*
KATHLEEN L. ROYLE*
RALPH E. SLATER
ROGER R. VALKENBURGH*

* ALSO ADMITTED IN NEW YORK
⊗ ALSO ADMITTED IN VERMONT
§ ADMITTED IN NY & NJ ONLY

May 25, 2023

Via Email and Hand Delivery

Planning and Zoning Commission

Town Hall Annex

238 Danbury Road

Wilton, CT 06897

Attn: Mr. Michael E. Wrinn – Director of Planning and Land Use Management

Re: ASML US, LLC – Alternative Signage Program; Project Narrative
Premises: 77 Danbury Road, Wilton, Connecticut

Dear Mr. Chairman and Members of the Commission,

As you may recall, you previously approved ASML's driveway project in August of 2022. In furtherance of ASML's efforts to improve the safety of the Premises, the Applicant seeks to install signs and displays as part of their proposed parking guidance system (System). The purpose of the proposed System is to direct drivers to the nearest available parking space, or indicate that the parking areas are full, therefore reducing vehicular traffic in the parking garage and northwestern surface lot.

The sign and display components of the proposed System are as follows:

1. "Electronic Entry Monument Sign" – A freestanding monument sign, facing south and prior to the new driveway on the northeastern portion of the property, with an integrated Light Emitting Diode (LED) panel. The LED panel, which measures 18" by 6" (0.75 sf), will display the number of available parking spaces in the parking garage and northwestern surface lot or inform drivers that the parking areas are full. The sign will also include static lettering that instructs drivers to turn around at the next left if the parking areas are full. The sign will be supported by 56" steel tubes finished in black, and the total area of the sign and integrated LED panel is 50" wide by 30" tall (8.33 sf). Details of this sign are found on the enclosed Tighe and Bond drawings, plans C-801 and C-802.

2. "Electronic Matrix Sign" – A freestanding monument sign, facing northeast and located prior to the new driveway's entry to the third floor of the parking garage, consisting of a 40" by 60" programmable display (16.67 sf). The display will indicate the number of available spaces on a floor-by-floor basis and state "Parking Spaces Open" in white letters on a blue background. The sign will be mounted on black, 3 1/8" wide steel tubes that measure 56" tall. The steel tubes will also serve as a frame for the 40" x 60" sign. A data sheet from Indect, the vendor of the Stackable Full-Matrix Display, has been enclosed for your reference.

3. "Ceiling Mounted Electronic Wayfinding Signage" – A ceiling-mounted display, consisting of several LED modules wrapped in a black aluminum frame, facing north and located inside of the entry to the garage from the new driveway. This display will measure 50" x 10" (3.46 sf). The purpose of this sign is to assist drivers in their decision to drive up or down upon entry to the garage. The Profile Sign also indicates the number and location of available accessible parking spaces. A data sheet from Indect, the vendor of the Profile Sign IP65, has been enclosed for your reference.

Details of the aforementioned, including their proposed locations, are found on the enclosed Tighe and Bond plans (C-801, C-802). In addition to the three signs, the proposed System requires the installation of Ultrasonic Mini Sensors (Sensors) above every parking space within the parking garage. The Sensors are connected to the System, and they allow the signs to reflect the current number of available parking spaces. The proposed Sensors will contain an integrated LED that will either be Red or Green, indicating whether the space is occupied or not, and the Sensors and their LEDs will face the interior of the garage. Each Sensor is approximately 4.45" wide and 5.75" long and will be connected to the ceiling of the parking garage. A data sheet from Indect, the vendor of the Sensor, has been enclosed for your reference.

Thank you for your time and consideration. We look forward to presenting the application.

Respectfully submitted,
Gregory and Adams, P.C.

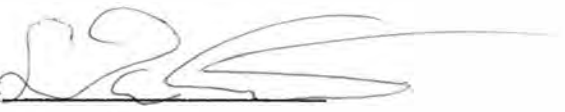
By: 
Daniel Conant

DC/ko
Enclosures

Town of Wilton

Geographic Information System (GIS)



Date Printed: 5/24/2023

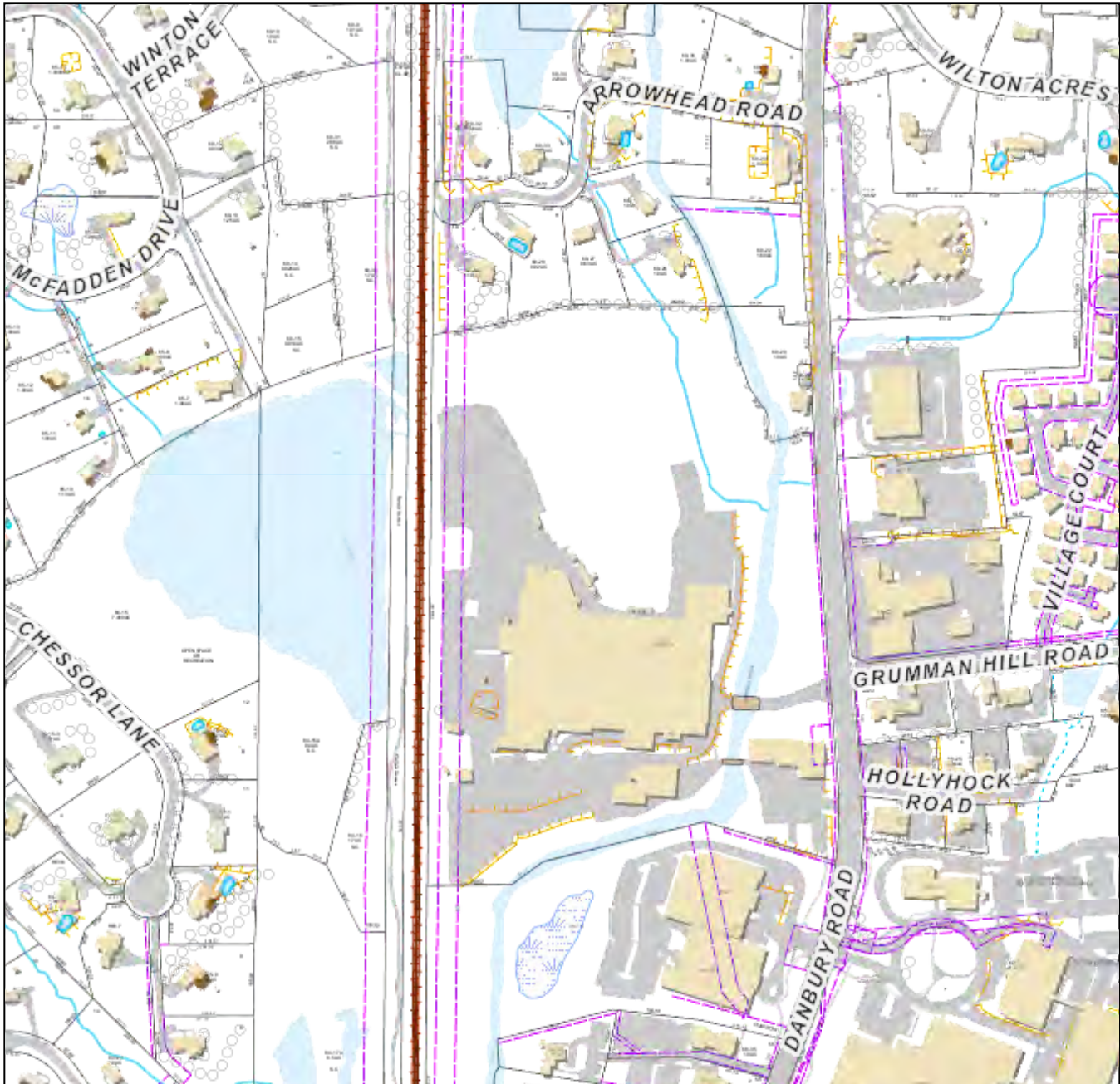

MAP DISCLAIMER - NOTICE OF LIABILITY

This map is for assessment purposes only. It is not for legal description or conveyances. All information is subject to verification by any user. The Town of Wilton and its mapping contractors assume no legal responsibility for the information contained herein.

Zoning Effective: July 28, 2017

Planimetrics Updated: 2014

Approximate Scale: 1 inch = 400 feet

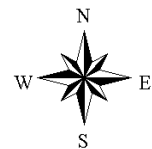

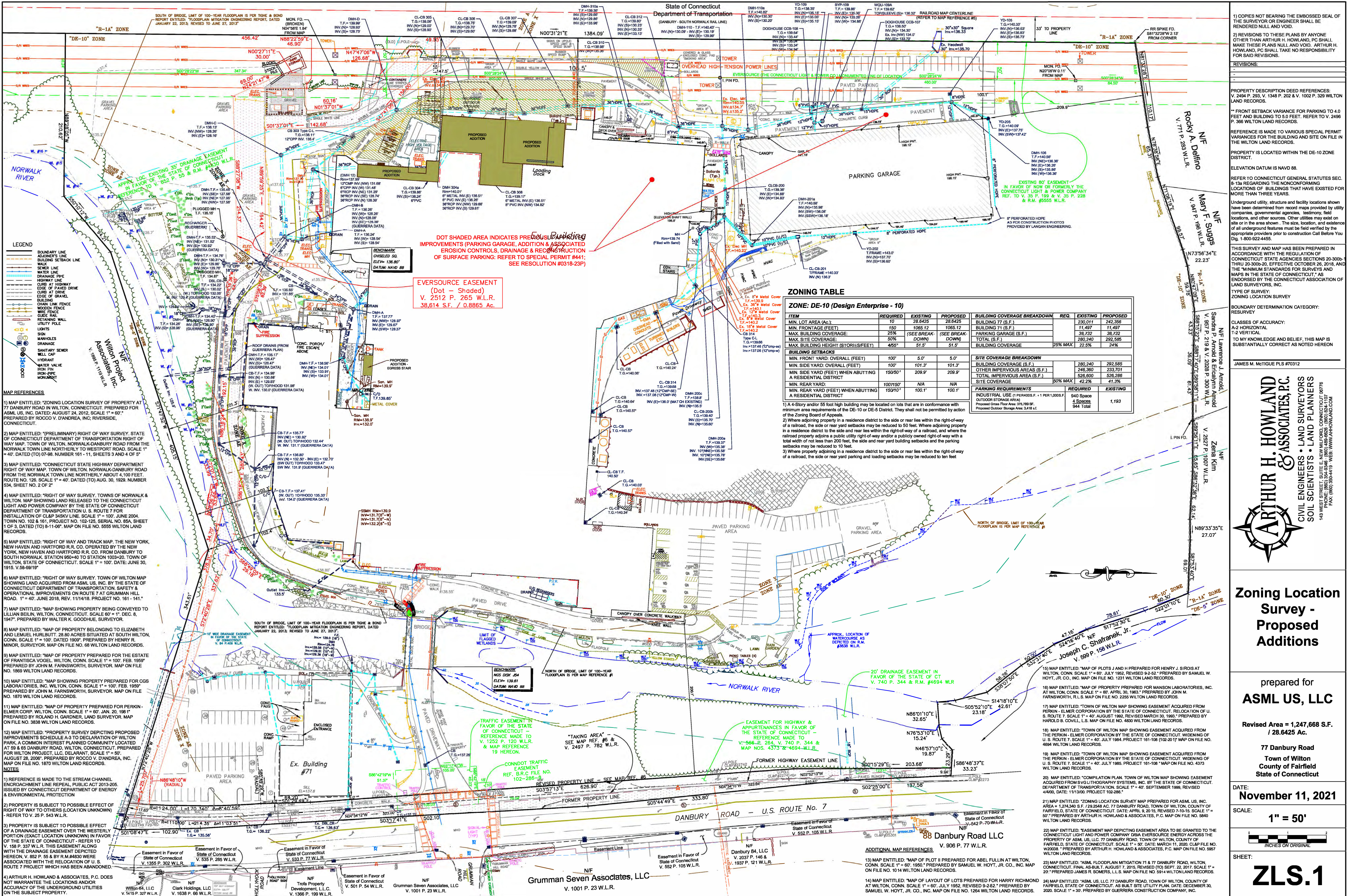

1) COPIES NOT BEARING THE EMBOSSED SEAL OF THE SURVEYOR OR ENGINEER SHALL BE RENDERED NULL AND VOID.

2) REVISIONS TO THESE PLANS BY ANYONE OTHER THAN ARTHUR H. HOWLAND, P.C. SHALL MAKE THESE PLANS NULL AND VOID. ARTHUR H. HOWLAND, P.C. SHALL TAKE NO RESPONSIBILITY FOR SAID REVISIONS.

REVISIONS:

PROPERTY DESCRIPTION DEED REFERENCES: V. 2494 P. 283, V. 1348 P. 202 & V. 1002 P. 329 WILTON LAND RECORDS.

** FRONT SETBACK VARIANCE FOR PARKING TO 4.0 FEET AND BUILDING TO 5.0 FEET. REFER TO V. 2496 P. 366 WILTON LAND RECORDS.

REFERENCE IS MADE TO VARIOUS SPECIAL PERMIT VARIANCES FOR THE BUILDING AND SITE ON FILE IN THE WILTON LAND RECORDS.

PROPERTY IS LOCATED WITHIN THE DE-10 ZONE DISTRICT.

ELEVATION DATUM IS NAVD 88.

REFER TO CONNECTICUT GENERAL STATUTES SEC. 13-13 REGARDING THE NONCONFORMING LOCATIONS OF BUILDINGS THAT HAVE EXISTED FOR MORE THAN THREE YEARS.

Underground utility, structure and facility locations shown have been determined from record maps provided by utility companies, governmental agencies, testimony, field locations, and other sources. Other utilities may exist on site or in the area shown. The size, location, and existence of all underground features must be field verified by the appropriate providers prior to construction Call Before You Dig. 1-800-922-4455.

THIS SURVEY AND MAP HAS BEEN PREPARED IN ACCORDANCE WITH THE REGULATION OF CONNECTICUT STATE AGENCIES SECTIONS 20-300b-1 THRU 20-300b-20, EFFECTIVE OCTOBER 28, 2017, AND THE "MINIMUM STANDARDS FOR SURVEYS AND MAPS IN THE STATE OF CONNECTICUT," AS ENDORSED BY THE CONNECTICUT ASSOCIATION OF LAND SURVEYORS, INC.

TYPE OF SURVEY: ZONING LOCATION SURVEY

BOUNDARY DETERMINATION CATEGORY: RESURVEY

CLASSES OF ACCURACY: A-2 HORIZONTAL 1/2 VERTICAL

TO MY KNOWLEDGE AND BELIEF, THIS MAP IS SUBSTANTIALLY CORRECT AS NOTED HEREON

JAMES M. MCTIGUE PL# 07312

ARTHUR H. HOWLAND & ASSOCIATES, P.C.
CIVIL ENGINEERS • LAND SURVEYORS
SOIL SCIENTISTS • LAND PLANNERS
143 WEST STREET, SUITE 100, NEW HAVEN, CONNECTICUT 06510
PHONE: (860) 364-6546 • (860) 458-6606 • (860) 824-1107
FAX: (860) 350-4419 • WEB: WWW.AHHOWLAND.COM



Zoning Location Survey - Proposed Additions

prepared for
ASML US, LLC

Revised Area = 1,247,668 S.F.
/ 28,6425 Ac.

77 Danbury Road
Town of Wilton
State of Connecticut

DATE:
November 11, 2021

SCALE:
1" = 50'

SHEET:

INCHES ON ORIGINAL

ZLS.1

Last Saved: 10/21/2022
Plotted On: Mar 20, 2023 3:39pm By: SansoneM
Tighe & Bond: 1:VA0969 ASML 020 Campus Master Plan Drawings AutoCAD Sheet A0969-020-C-000-REND-EXCN.dwg



Tighe&Bond
1000 Bridgeport Avenue
Suite 320
Shelton, CT 06484
(203) 712-1100

ASML

Campus
Master Plan

77 Danbury Road
Wilton, Connecticut

MARK	DATE	DESCRIPTION
PROJECT NO:	A0969-020	
DATE:	10/21/2022	
FILE:	A0969-020-C-000-REND-EXCN.dwg	
DRAWN BY:	MDS	
DESIGNED/CHECKED BY:	JAC	
APPROVED BY:	JWB	

EXISTING
CONDITIONS

SCALE: 1" = 50'

EX-01

Last Saved: 5/16/2023
Plotted On: May 23, 2023 11:11am By: CanasJ
Tighe & Bond: 1:VA0969 ASML 015 - Driveway Improvements Drawings Figures AutoCAD Sheet: A0969-015-C-801-PARKING GUIDANCE.dwg

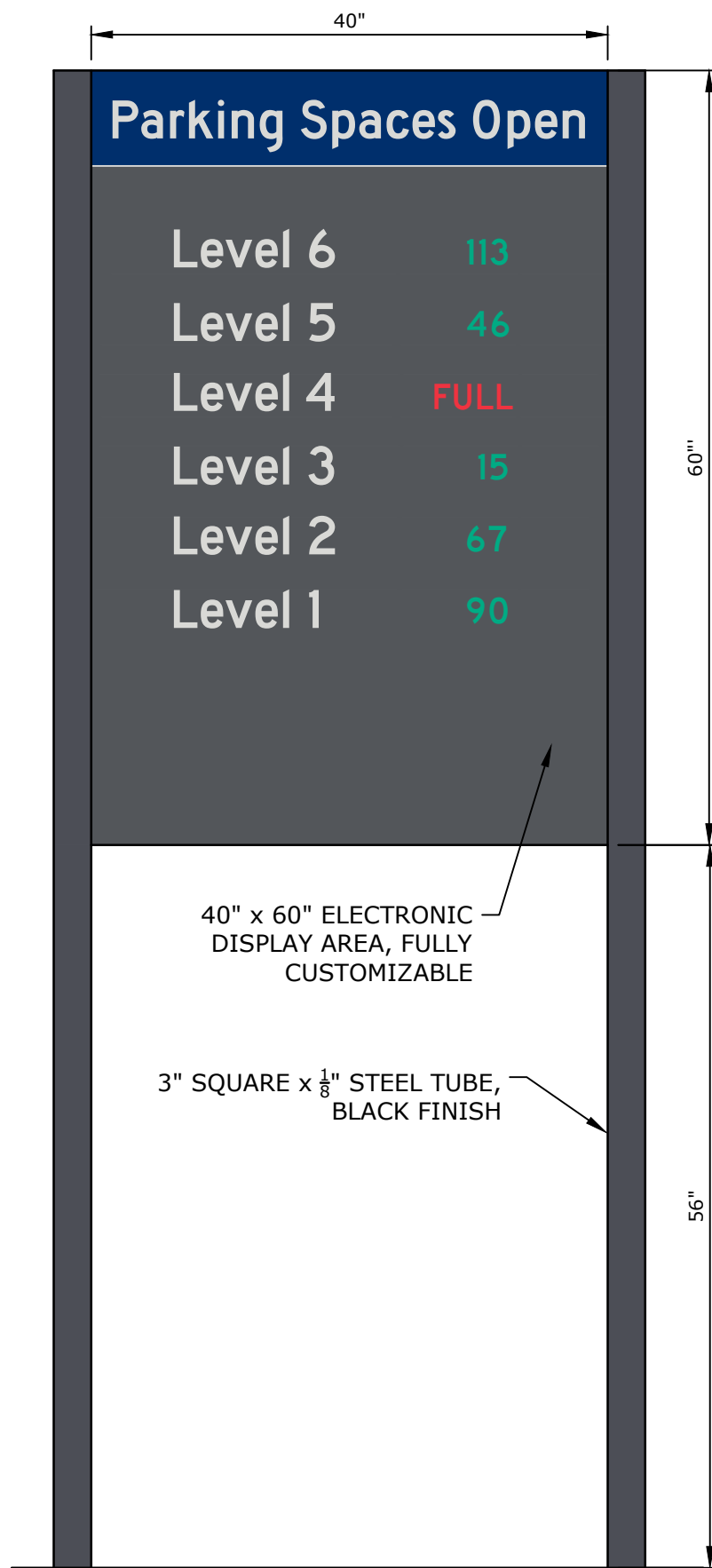
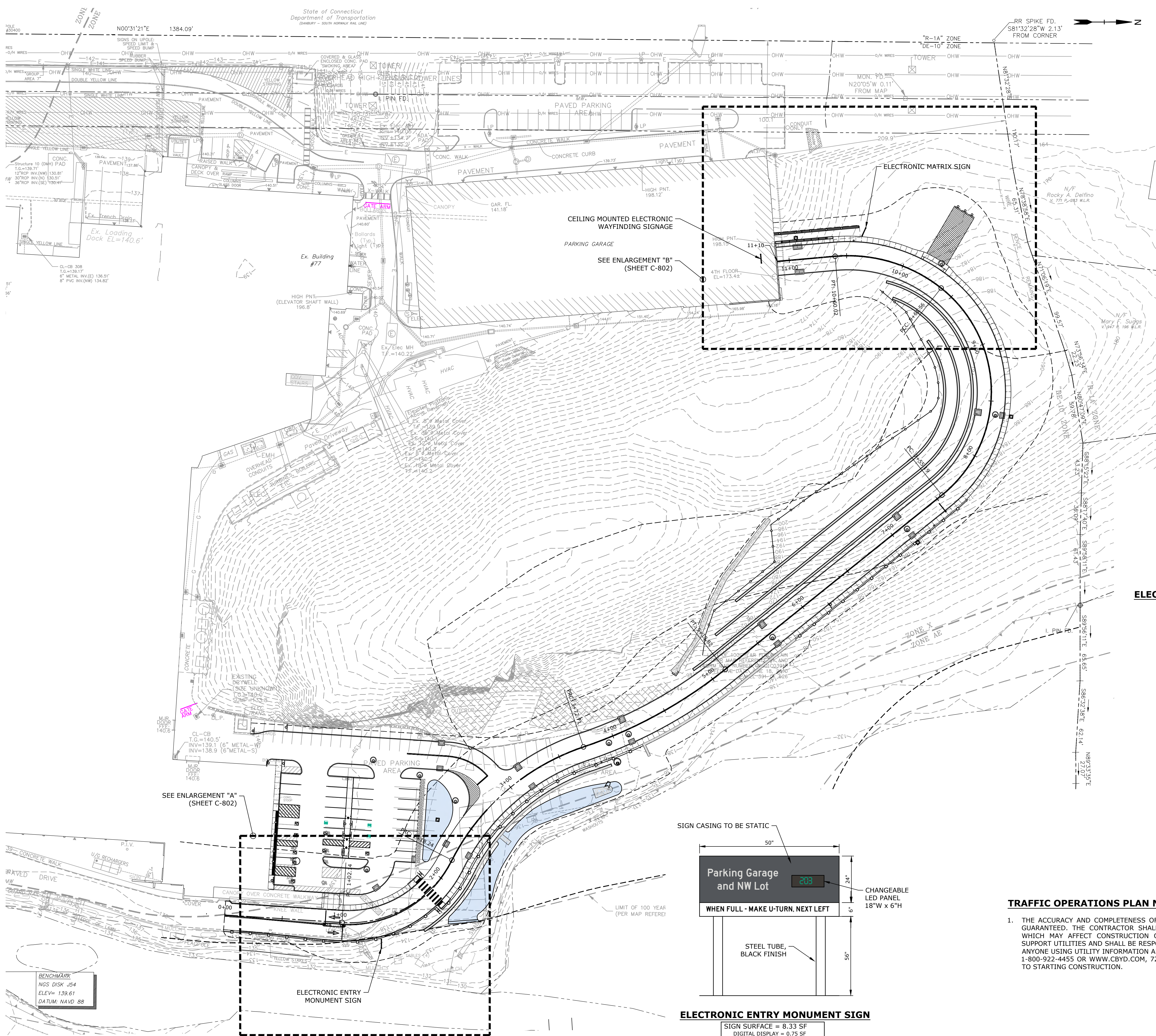

ELECTRONIC MATRIX SIGN

SIGN SURFACE = 16.67 SF
DIGITAL DISPLAY = 16.67 SF
STATIC DISPLAY = 0.00 SF

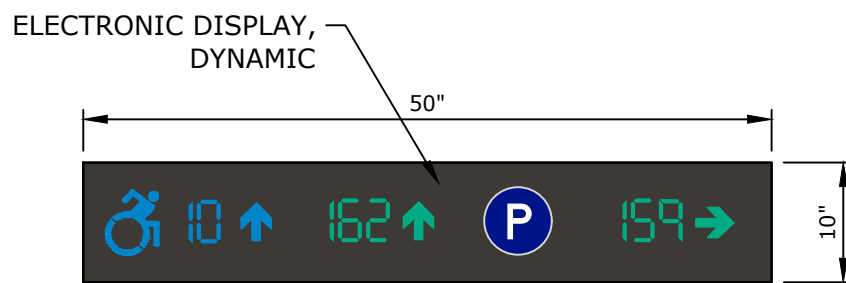

ELECTRONIC CEILING MOUNTED WAYFINDING SIGN

SIGN SURFACE = 3.47 SF
DIGITAL DISPLAY = 3.47 SF
STATIC DISPLAY = 0.00 SF

TRAFFIC OPERATION PLAN LEGEND

- - - - - 100 FT UPLAND REVIEW AREA
- - - - - PROPERTY LINE
- - - - - EASEMENT LINE
- ===== PROPOSED CURB
- ===== PROPOSED RETAINING WALL
- ===== PROPOSED BUILDING
- ===== PROPOSED GUIDE RAIL
- PROPOSED SIGN
- PROPOSED ACCESSIBLE SYMBOL
- ===== DOUBLE YELLOW CENTERLINE
- ===== GATE CONTROL
- ||||| PAINTED CROSSWALK

TRAFFIC OPERATIONS PLAN NOTES

1. THE ACCURACY AND COMPLETENESS OF SUBSURFACE INFORMATION SHOWN ON THESE DRAWINGS IS NOT GUARANTEED. THE CONTRACTOR SHALL DETERMINE THE LOCATIONS AND ELEVATIONS OF ALL UTILITIES WHICH MAY AFFECT CONSTRUCTION OPERATIONS. THE CONTRACTOR MUST ADEQUATELY PROTECT AND SUPPORT UTILITIES AND SHALL BE RESPONSIBLE FOR ALL DAMAGE INCURRED AT NO EXPENSE TO THE OWNER. ANYONE USING UTILITY INFORMATION AND DATA PROVIDED HEREIN SHALL CONTACT "CALL BEFORE YOU DIG", 1-800-922-4455 OR WWW.CBYD.COM, 72 HOURS IN ADVANCE TO VERIFY THE LOCATION OF UTILITIES PRIOR TO STARTING CONSTRUCTION.

SIGN CASING TO BE STATIC

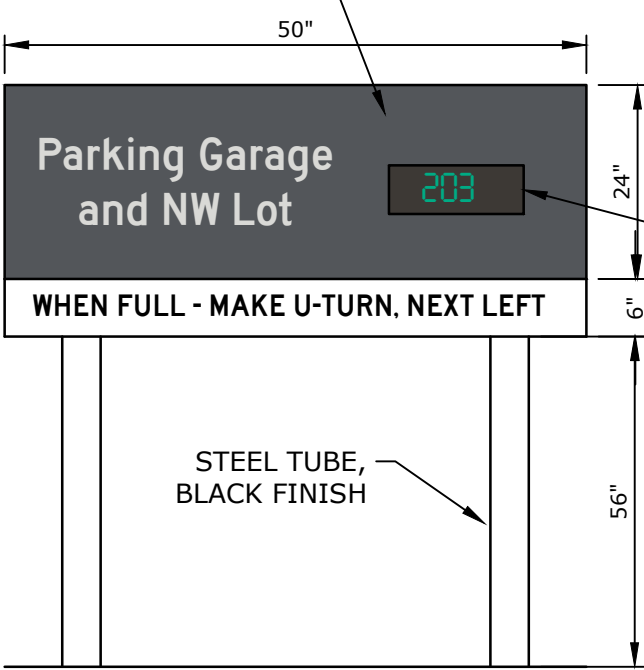

ELECTRONIC ENTRY MONUMENT SIGN

SIGN SURFACE = 8.33 SF
DIGITAL DISPLAY = 0.75 SF
STATIC DISPLAY = 7.58 SF

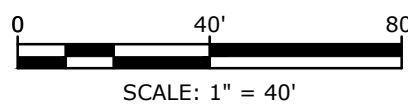

ZONING PERMIT NOTICE

- Pursuant to Section 8-3.(l) of the Connecticut General Statutes, all work in connection with this Special Permit shall be completed within five years after the 3 approval of the plan. Said five-year period shall expire on September 6, 2027.
- "For conditions of approval for Special Permit SP#492, see Resolution #0822- 492SP

SITE/CIVIL GMP PRICING SET

ASML

Campus Traffic Flow Safety Improvements

77 Danbury Road
Wilton, Connecticut

MARK	DATE	DESCRIPTION
------	------	-------------

PROJECT NO:	A0969-015
DATE:	08/08/2022
FILE:	A0969-015-C-801-PARKINGGUIDANCE.dwg
DRAWN BY:	MDS
DESIGNED/CHECKED BY:	JAC
APPROVED BY:	JWB

ELECTRONIC PARKING GUIDANCE SIGNAGE PLAN

SCALE: 1" = 40'

C-801

ZONING PERMIT NOTICE

a. Pursuant to Section 8-3.(l) of the Connecticut General Statutes, all work in connection with this Special Permit shall be completed within five years after the 3 approval of the plan. Said five-year period shall expire on September 6, 2027."

b. "For conditions of approval for Special Permit SP#492, see Resolution #0822- 492SP

**SITE/CIVIL GMP
PRICING SET**

ASML

**Campus Traffic
Flow Safety
Improvements**

77 Danbury Road
Wilton, Connecticut

MARK	DATE	DESCRIPTION
PROJECT NO:	A0969-015	
DATE:	08/08/2022	
FILE:	A0969-015-C-801-PARKINGGUIDANCE.dwg	
DRAWN BY:	MDS	
DESIGNED/CHECKED BY:	JAC	
APPROVED BY:	JWB	

**ELECTRONIC PARKING
GUIDANCE SIGNAGE PLAN
ENLARGEMENT**

SCALE: 1" = 40'

C-802

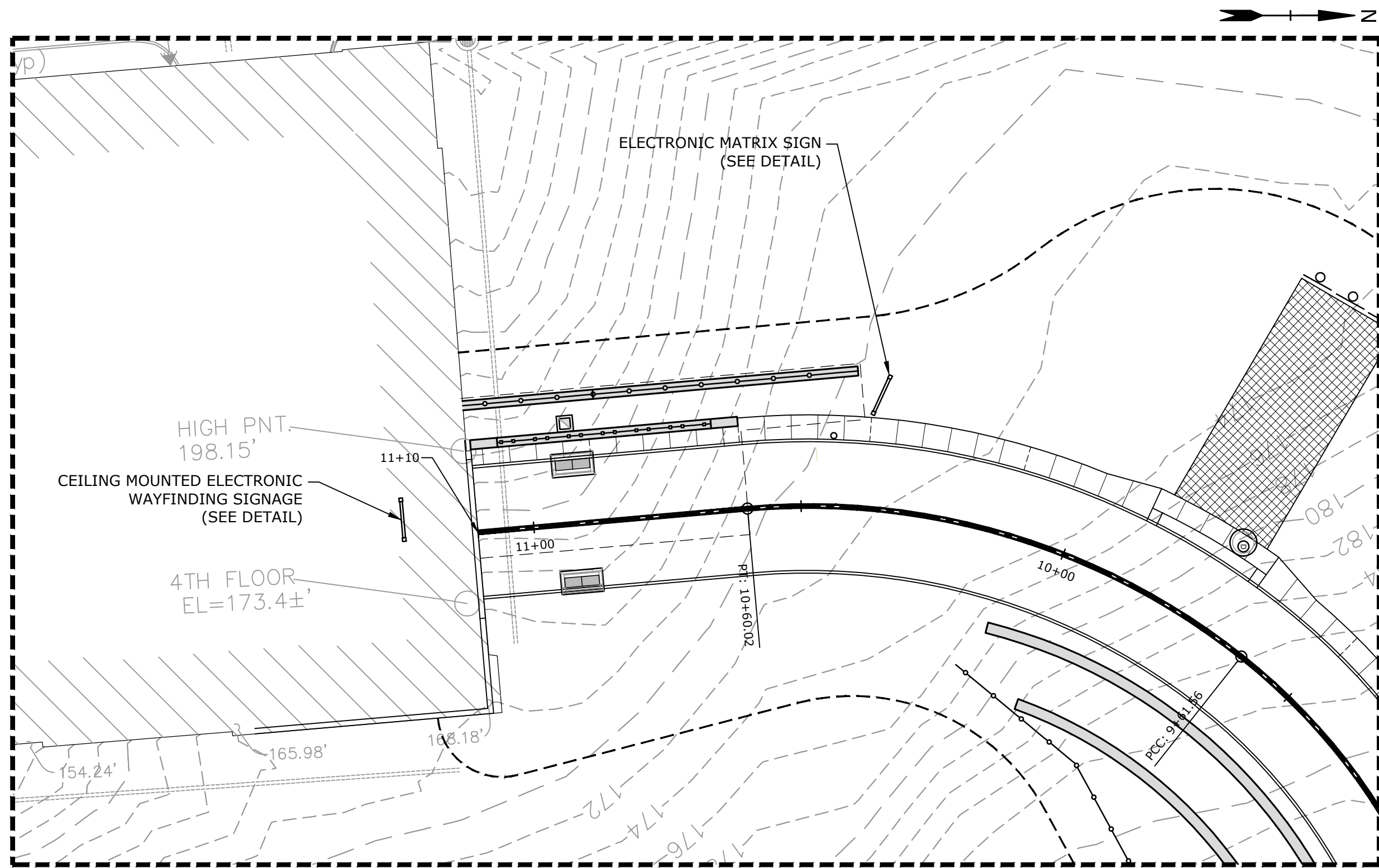
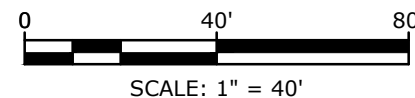

Stackable Full-Matrix Display



Picture: Full-matrix LED display,
pitch 3.91, 4 by 3 panels
(actual item may differ from photo)

Client to provide 120V power and data to sign locations, per
provided PGS drawings.
Material of wall and wall mounting bracket to be provided to PGS
for sign frame design. PGS MT

Description

INDECT provides stackable full-matrix RGB LED displays in pitch 3.91 and pitch 4.81 for manifold purposes and for indoor or outdoor use.

The self-supporting panels can be stacked easily by one person to build the entire sign. At the back side there is a fully sealed and watertight connection box which holds the receiving card per panel and the power and Ethernet jacks for power and data connection.



Advantages

Ease of installation and commissioning	<ul style="list-style-type: none"> • Easy stacking of panels without tools • Easy power and data connection with prefab cables
Easy maintenance	<ul style="list-style-type: none"> • Damaged modules can be easily replaced due to the stacking
Flexible contents	<ul style="list-style-type: none"> • Space availability information • Text • Pictures and guidance symbols, such as arrows, wheelchair symbols etc. • Advertising • Messages • Building guidance • MPG videos
Visibility	<ul style="list-style-type: none"> • Panels with integrated sun shade • Brightness adjustable

INDECT Electronics & Distribution GmbH

Ricoweg 1
 2351 Wiener Neudorf
 AUSTRIA

T: +43/2236/32 01 99
 F: +43/2236/32 01 99-99
office@indect.com
www.indect.com



All rights reserved.

No part of this document may be reproduced, stored in a retrieval system, or transmitted in any form or by any means, electronic, mechanical, photocopying, microfilming, or otherwise, without written permission from Indect Electronics & Distribution GmbH.

Indect Electronics & Distribution GmbH assumes no liability whatsoever for the contents of this document. Indect Electronics & Distribution GmbH reserves the right to change the contents of this document, in its own estimation and without notice. This document is delivered in an "as is" state, and Indect Electronics & Distribution GmbH assumes no liability for its use.

Technical Data / Functional Overview

The matrix panels are connected to an external sending box, connected to a USB and a DVI or HDMI port (HDMI-DVI adapter required) on the computer.

For more information see the respective connection layouts.

Pitch:	3.91	5.95
Brightness:	4500 nits	4500 nits
Dimensions (W x H x D)	<ul style="list-style-type: none"> 500 x 500 x 78 mm 19.69 x 19.69 x 3.07 in 	<ul style="list-style-type: none"> 500 x 500 x 78 mm 19.69 x 19.69 x 3.07 in
Weight per panel	<ul style="list-style-type: none"> 7.8 kg 17.19 lbs 	<ul style="list-style-type: none"> 7.7 kg 16.97 lbs
Resolution per panel	128 x 128 px	104 x 104 px
Maximum size per sending card port:	<ul style="list-style-type: none"> If 2 ports are used: 2048 x 320 px 9.5 x 1.5 m 31.17 x 4.92 ft If one port is used: 650,000 px in total 	<ul style="list-style-type: none"> If 2 ports are used: 2048 x 320 px 12 x 1.5 m 31.17 x 4.92 ft If one port is used: 650,000 px in total
Voltage supply:	110-220 VAC / 50-60 Hz	110-220 VAC / 50-60 Hz
Power consumption:	<ul style="list-style-type: none"> Average: 200 W/sqm Maximum: 640 W/sqm 	<ul style="list-style-type: none"> Average: 200 W/sqm Maximum: 680 W/sqm
Protection rate:	<ul style="list-style-type: none"> Front: IP65 Back: IP65 	<ul style="list-style-type: none"> Front: IP65 Back: IP65
Operating temperature:	<ul style="list-style-type: none"> -20 to 60 °C -4 to 140 °F 	<ul style="list-style-type: none"> -20 to 60 °C -4 to 140 °F
Operating humidity (RH):	10 to 95%	10 to 95%
Sign rack:	Self-supporting construction	Self-supporting construction

Contents

Fonts for text:	Standard Windows fonts
Font size:	Unlimited
Text contents:	<ul style="list-style-type: none"> Static text Running text Spacecount placeholders
Running Text:	<ul style="list-style-type: none"> Right to left Left to right
Characters:	Unicode
Alternating contents:	Yes
Graphics format:	<ul style="list-style-type: none"> BMP JPG PNG GIF

Video format: • MPG

Brightness control: • Manually for all connected displays
• Automatically by function card installed in one sign

Communication and Connections

Communication: Nova protocol (over Ethernet / fiber cable)¹

Connection: 2 options:
• Separate mini PC for sign control, connected to, sending box, connection to INDECT server by TCP/IP

Operation: BrightSign Matrix displays set up on the coordinate system of an extended screen, mirror the contents placed there.
Separate BrightSign configuration software to create scenes with different contents (graphics, text, space availability placeholders, videos).
Scenes triggered according to space availability/manually/in loop.

Control: Via INDECT system for space counting

1. **Note:** no active or passive network components (such as switches, routers, range extenders) must be used. With regard to fiber converters, only such that understand the LINSN protocol must be used.

Applications

The stackable full matrix displays are also perfectly suitable for gantry constructions, since they can be easily stacked to combine to huge surfaces.

The example below consists of a 5 m wide gantry equipped with 8 horizontal and 6 vertical rows of P3.91 stackable matrix panels, resulting in a total LED matrix surface of 4,000 x 3,000 mm, equaling 157.4 x 118.1 inch.

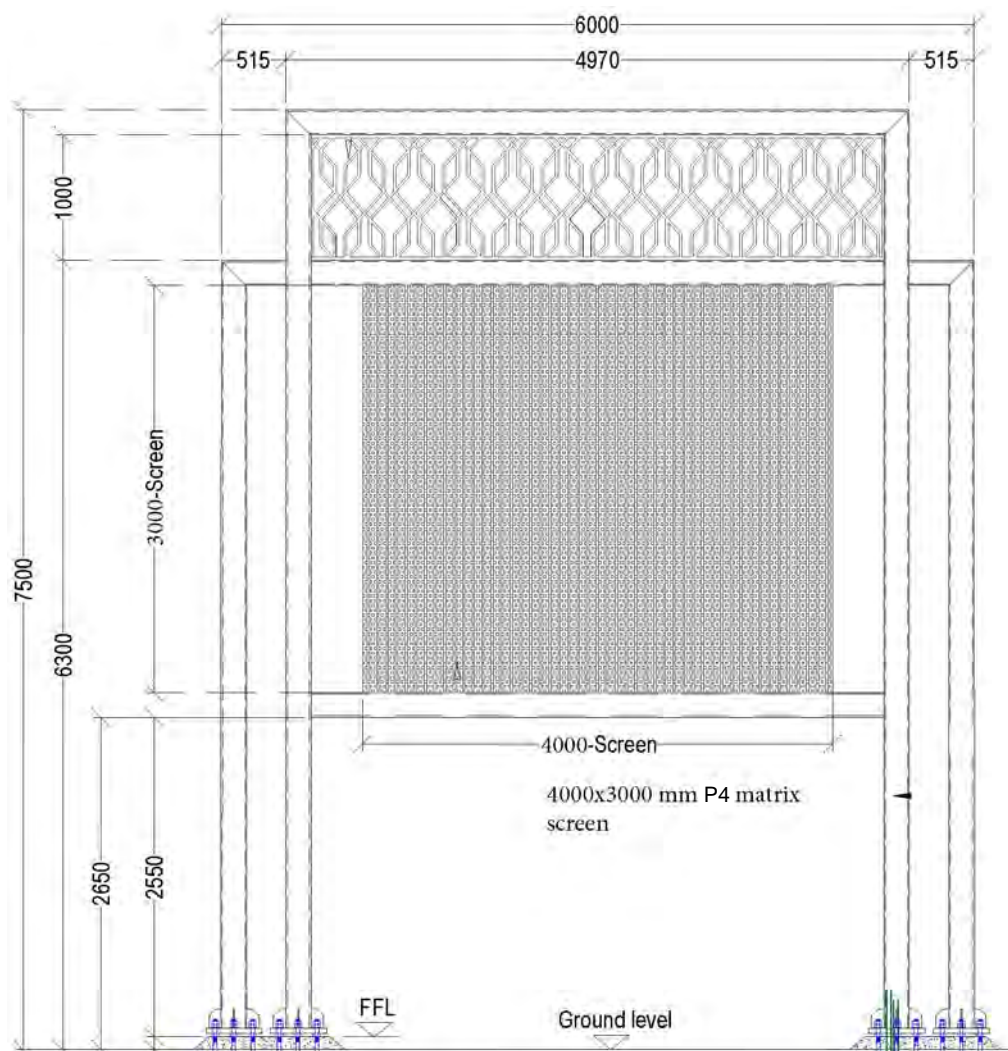

At the back side of the sign the matrix panels can be covered with back panels to permit air circulation there.

For maintenance, access from the front and the back side must be provided. We recommend to use scissor lifts for this work. Module replacement is carried out by removing the individual panels top-down until the module to be replaced is reached.

At the foot of the gantry a connection box provides connections for power and data.

Further discussion on mounting style and location is needed. PGS MT

Pictures

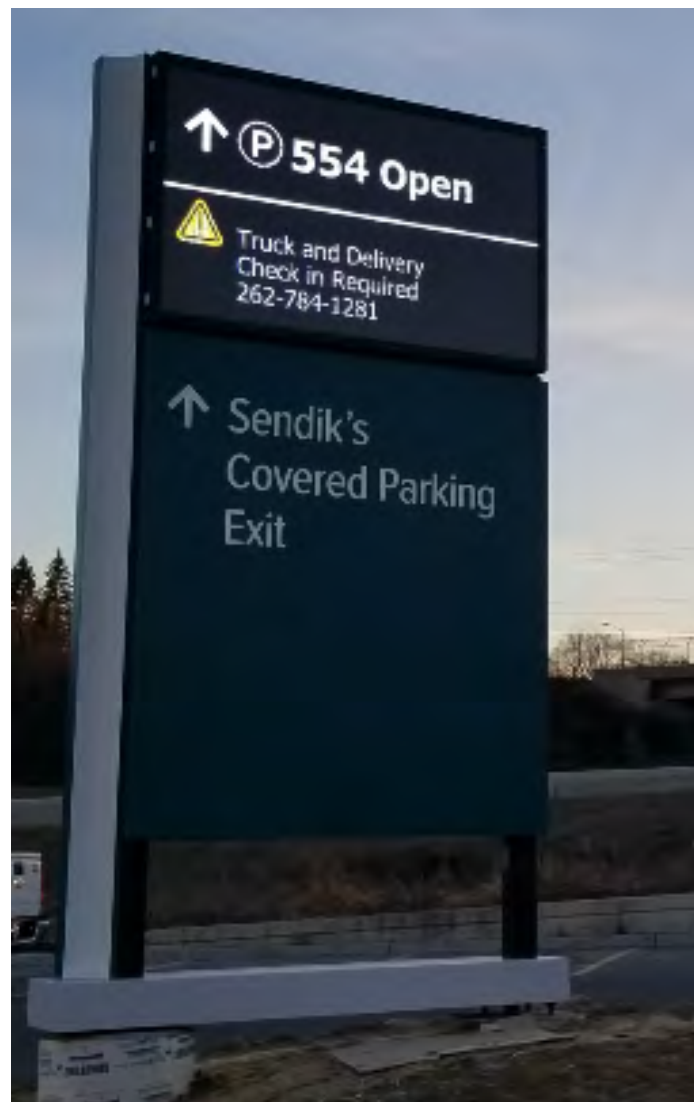
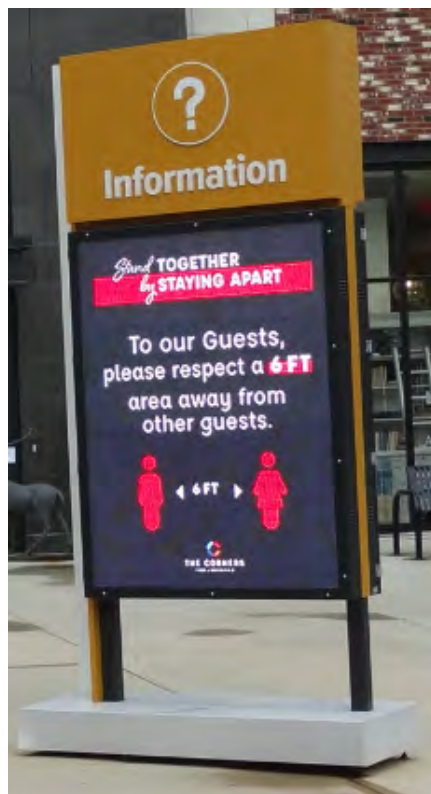
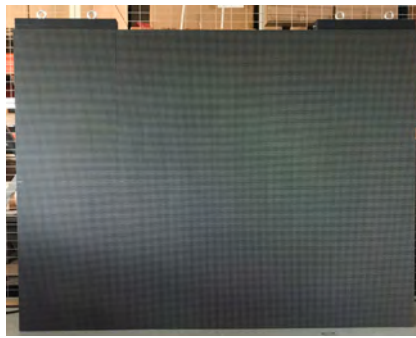

Profile Sign IP65

Picture: Sample sign
 (actual item may differ from photo)



Location of signs
 on PGS drawings

Description

INDECT signs make parking guidance an easy task in multistorey car parks and open air parking. Our new profile sign concept is based on a flat and sturdy IP65 sign profile that can be equipped with manifold modules.

For **customer-specific signs**, INDECT provides a great variety of LED modules (arrows, digits, symbols, LED matrix etc.) that can be combined with backlit plexiglass text panels and installed in the high-quality aluminium frame profile of the sign to cope with any possible guidance task, ranging from main entry, level, aisle signs to special information displays. For a list of INDECT LED modules to be installed in a sign for customer-specific preferences, see below.

Advantages

Quality	<ul style="list-style-type: none"> • Flat and sturdy sign rack - only 80 mm / 3.15" deep and up to 6 m / 19.7' long • Front protected by transparent plexi cover • Backlight through SMD LED panels • Optimal visibility through backlight and transparent text panel • Easy maintenance • IP65 protection (dust and water) • Optional sun roof
Flexibility in design	<ul style="list-style-type: none"> • Great variety of LED modules and LED digits to be combined • Standard layouts or according to customer preferences • Double-sided signs through back-to-back installation (160 mm / 6.3" deep) • Rack profile colour and backlit text panel colour according to customer preferences
Easy installation	<ul style="list-style-type: none"> • Installation brackets for ceiling or wall installation

Pictures



For more pictures please visit www.flickr.com/photos/Indect.



Suggested Internal Sign Sample

D01



Sign Type:	1_Profile Sign IP65, 241x80 mm (HxD)
Quantity:	1
General comment:	Client to approve "P", foil color and casing color. LED Digits are solid green and ADA Digs are solid blue with red X
Comment relevant for mounting:	
Comment relevant for production:	Frame Colour: Deep Black (RAL-9005); Foil Colour: 5745T Electric Blue Translucent
Dimensions (+/- 30 mm due to production):	1050x240mm

INDECT Electronics & Distribution GmbH

Rennweg 83
2345 Brunn am Gebirge
AUSTRIA

T: +43/2236/32 01 99
F: +43/2236/32 01 99-99

office@indect.com
www.indect.com



All rights reserved.

No part of this document may be reproduced, stored in a retrieval system, or transmitted in any form or by any means, electronic, mechanical, photocopying, microfilming, or otherwise, without written permission from Indect Electronics & Distribution GmbH.

Indect Electronics & Distribution GmbH assumes no liability whatsoever for the contents of this document. Indect Electronics & Distribution GmbH reserves the right to change the contents of this document, in its own estimation and without notice. This document is delivered in an "as is" state, and Indect Electronics & Distribution GmbH assumes no liability for its use.

Technical Data: Profile Sign

Dimensions

H x D:	240 x 80 mm (9.49 x 3.15 in)
W:	max. 6 m (20 ft)

Technical Data

Rack material:	Extruded aluminium profile
Rack colour:	<ul style="list-style-type: none"> Aluminium anodised or RAL powder coating according to customer preferences
Rack openings:	Left and right
Text panel / Front panel:	Transparent acrylic glass 3 mm (0.12 in) (temperature resistant up to 80 °C / 176 °F)
Text foil (applied on text panel)s:	Colour and layout (text and symbols) according to customer preferences
Ingress Protection:	IP65
Ambient conditions:	-25 to 70 °C (-13 to 158 °F) 10 to 90% RH (non-condensing)
Storage temperature:	-40 to 70 °C (-40 to 158 °F)
Input power of LED backlight:	<ul style="list-style-type: none"> 24 VDC from INDECT bus, or sign-integrated 24 VDC power supply
Power consumption of backlight lamps:	0.1 A to 1 A depending on the dimensions and the required number of LED panels
Input power of LED modules:	24 VDC from INDECT bus
Power consumption of LED modules:	Depending on installed LED modules, see respective data sheets

Installation

- Ceiling mounted: direct or suspended via threaded rods (M8), chains or profiles
- Wall mounted: via profiles (optional profiles available)

Cabling

- Recommended cable for power supply of backlight: NYM-J 3x1.5 mm / AWG16
Note: Comply with local standards and requirements!
- Recommended cables for connection of LED modules: see data sheet LESY2.0, LEDI2.0, MAMO2.0, TEMO2.0 and DIMO2.0.

Note: Other cable types can be tested for suitability by INDECT upon request.

Power and data connects directly to the busline

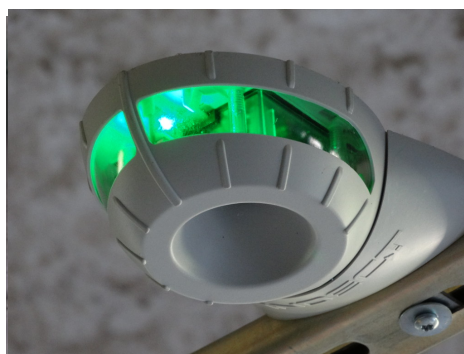

UMS - Ultrasonic Mini Sensor

Article number: 200114

Picture: Hidden cable installation
(actual item may differ from photo)

Sample

Contents

- UMS Sensor 1
- UMS Installation System 4
- Space Indicator LED 7
- Commercial Data 8

Description

INDECT's UMS is a ceiling-mounted ultrasonic sensor used for precise vehicle detection in indoor car parks. The UMS is part of INDECT's Space Administration System ISA.

The UMS is available with integrated RGB space indicator LED (SIⁱⁿ)

The UMS is CE and EMC certified and has been developed and produced in compliance with ISO 9001.

Advantages

Save installation costs	<ul style="list-style-type: none"> • Fast installation through mounting plate and secure clamp system • Fast wire connection through push-in direct connection terminals • Cost-effective wiring with standard cable NYM-J 4x1.5 mm / AWG16 • Installation with standard installation material such as steel/aluminium/PVC conduits, C-channels, cable trays etc.
High longevity in rough car park environments	<ul style="list-style-type: none"> • Ceramic ultrasonic transducer in automotive quality • Fully encapsulated and dirt resistant ultrasonic transducer (IP65) • Gold-plated connection pins • Flame-retardant casing

Safe investment

- Remotely updateable firmware to guarantee state-of-the-art detection also of future vehicle types
- Completely independent sensor operation also without central control
- Maintenance-free
- Sensor sound inaudible for humans

LED options

- Built-in RGB Space Indicator LED

Pictures

UMS, C-channel-mounted with external space indicator LED

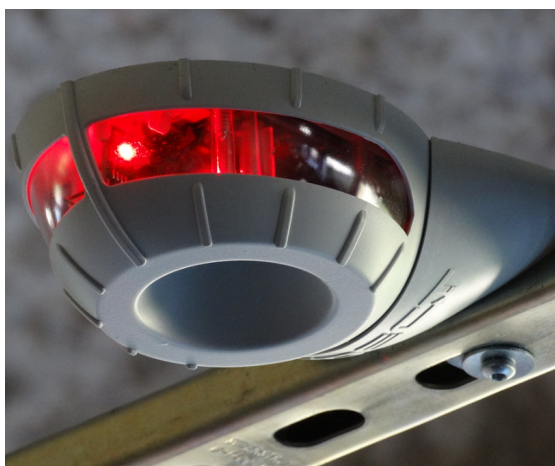

Technical Data: UMS

Dimensions

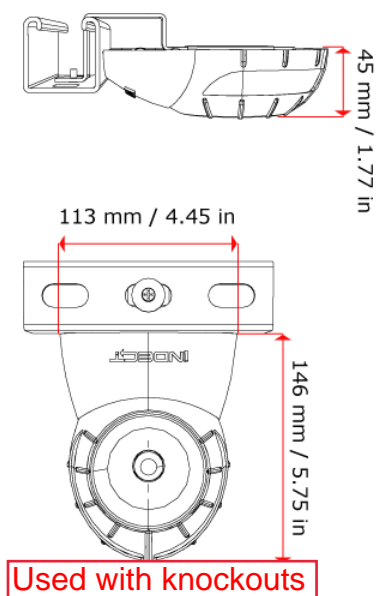

Ultrasonic Sensor Data

Measuring principle:	Ultrasound
Measuring distance:	500 to 4500 mm (19.7 to 177 in)
Casing material:	Plastic
Casing colour:	RAL 7035
Ingress Protection of transducer:	IP65
Supply voltage range:	15 to 24 V DC
Power consumption:	UMS: 47 mA (according to equipment and settings); connected RGB-LED: 20 mA ¹
Ambient conditions:	-25 to 60 °C (-13 to 140 °F) 10 to 90% RH (non-condensing)
Storage temperature:	-30 to 70 °C (-22 to 158 °F)

1. Depending on the preset LED colour and brightness.

Cabling

- Push-in direct connection terminals
- Recommended cable for connection: NYM-J 4x1.5 mm / AWG16
(A05VV-U 4 x 1.5 mm / AWG16)

Note: Other cable types can be tested for suitability by INDECT upon request.

UMS Installation System



Description

INDECT's UMS Installation System is a modular system consisting of INDECT's base plates and an off-the-shelf C-channel or conduit system for cost-efficient and quick installation of sensors (UMS) and space indicators (SI).

Note: The UMS must not be installed outdoors.

Advantages

Flexible installation	<ul style="list-style-type: none">• Conduits (steel, PVC, aluminium)• C-channels, cable trays, light rails• In slab
Save installation costs	<ul style="list-style-type: none">• Fast installation• Fast wire connection through push-in direct connection terminals• Simple click-in sensor mounting
Use standard installation material	<ul style="list-style-type: none">• Cost-effective wiring with standard cable NYM-J 4x1.5 mm / AWG16• Installation with standard installation material such as steel/aluminium/PVC conduits, C-channels, cable trays etc.

UMS Technical Data & Installation: Conduits

Technical Data

Tube dimensions sensor to sensor:	25 mm (0.98 in) diameter; length individually adjustable
Tube dimensions sensor to space indicator:	20 mm (0.79 in) (recommended) or 25 mm (0.98 in) diam.; length individually adjustable





Installation

The base plate is mounted on threaded rods (M8) pending from the ceiling, or directly screwed to the ceiling (with 1, 2 or 3 screws, according to the circumstances, in this case INDECT also provides spacers (SPAC) to be clicked on the base plate extension).

The conduits are fixed on the base plate with cable ties. In case of an external Space Indicator, the conduit to the Space Indicator is also fixed on the base plate with a cable tie. For more information on how to fix the conduit on the Space Indicator side, see data sheet External Space Indicator SI^{ex}. The conduits hold the cable from sensor to sensor and from the sensor to the Space Indicator.

The UMS sensors are simply clicked on the base plate.

Commercial Data: UMS

	Article number	Article name and description	Weight per unit
	200114	UMS Car detection sensor for precise vehicle detection in indoor car parks. Fully encapsulated transducer in automotive quality, IP65. Integrated or external LED space indicators must be ordered separately.	0,110 kg (0,243 lbs)
	1002492	COCH Cable cover for C-channel installation.	

Commercial Data: UMS Installation System

	Article number	Article name and description	Weight per unit
	10024056	UMS IBP Set C-Channel Comprising UMS IBP, UMS TP and 4 terminal pins. Unassembled.	0,075 kg (0,165 lbs)
	10024059	Surcharge UMS IBP C-channel Set Assembly	

Commercial Data: UMS Installation System

Article number	Article name and description	Weight per unit
-------------------	------------------------------	--------------------

UMS Installation Kit Assembling

Conduit Installation

Example of install. C- Channel will be used on Camperdown.

Assembling the Installation Plate

1. Place the extension plate underneath the installation base plate.
2. Put the pins through the 4 holes to join the two plates.
3. Make sure the pins click into position!
4. Click the connection terminal onto the pins..

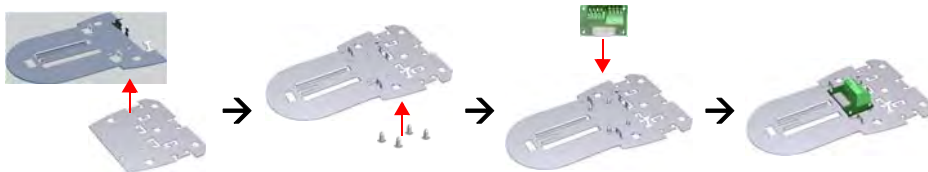

A. Direct ceiling installation

1. Turn the plate upside down and place 3 spacers in the spacer holes.
2. Fix the installation plate to the ceiling.



B. Suspended installation

1. Turn the plate upside down and fix it with a thread rod (M10) to the ceiling. Fix the installation plate with nuts above and underneath the thread rod.

Conduits and cabling

1. Conduits are attached to the extension plate via cable ties.

Note: the conduits on the picture go to the left and right to the previous and next sensor, and to the rear to the external space indicator.



Note: If you use plastic or steel conduits instead of aluminum it is often necessary to fix those additionally with clamps to the ceiling.

2. Connect the cable from sensor to sensor and from the sensor to the external space indicator (see cable layout).

Sensor and cable cover

1. Connect your laptop to the COMO and open the setup software (see separate manual).
2. Connect sensor after sensor. The sensor slides onto the connection terminal and clicks into the two ears on the installation plate.
3. Click on the cable cover.



77 Danbury Road

Existing Signage

Monument Sign



Cantilevered Façade



Eastern Façade



Directional Wall Sign



48" x 29"

PLANNING & ZONING
COMMISSION
Telephone (203) 563-0185
Fax (203) 563-0284



TOWN HALL ANNEX
238 Danbury Road
Wilton, Connecticut 06897

RESOLUTION #1113-4Z
November 25, 2013

WHEREAS, the Wilton Planning and Zoning Commission has received an application from ASML US, Inc. for an alternative signage program application for property located at 77 Danbury Road; in a Design Enterprise (DE-10) District, known as Assessor's Map #69, Lot# 18, consisting of 29.2 acres; owned by ASML, US, Inc., and shown on the plans entitled:

Landscape Plan (Sheet L.1) – Prepared by Arthur H. Howland and Associates, submitted for ASML US, Inc., 77 Danbury Road, dated May 1, 2013 and drawn at a of 1" = 20'.

New Exterior Elevations (Sheet A300) - Prepared by H & R Design Facilities Planners, submitted for ASML US, Inc., 77 Danbury Road, dated July 22, 2013, last revised November 14, 2013 and drawn at a of 3/4" = 1'.

Enlarged Exterior Elevations (Sheet A301) - Prepared by H & R Design Facilities Planners, submitted for ASML US, Inc., 77 Danbury Road, dated July 22, 2013 and drawn at a of 3/8" = 1'.

Enlarged Exterior Elevations (Sheet A303) - Prepared by H & R Design Facilities Planners, submitted for ASML US, Inc., 77 Danbury Road, dated July 22, 2013, last revised November 14, 2013 and drawn at a of 3/8" = 1'.

Wall Sections (Sheet A305) - Prepared by H & R Design Facilities Planners, submitted for ASML US, Inc., 77 Danbury Road, dated July 22, 2013 and drawn at a of 3/4" = 1'.

Wall Sections (Sheet A306) - Prepared by H & R Design Facilities Planners, submitted for ASML US, Inc., 77 Danbury Road, dated July 22, 2013 and drawn at a of 3/4" = 1'.

Wall Sections (Sheet A306A) - Prepared by H & R Design Facilities Planners, submitted for ASML US, Inc., 77 Danbury Road, dated August 6, 2013, last revised November 19, 2013 and drawn at varying scales.

WHEREAS, the Wilton Planning and Zoning Commission reviewed the Alternative Signage Plan request at regularly scheduled meetings on October 14, 2013, November 12, 2013 and November 25, 2013; and

WHEREAS, the Wilton Planning and Zoning Commission has determined that the unique size and complexities associated with site warrant consideration for alternative signage; and

WHEREAS, the Wilton Planning and Zoning Commission has determined that the application is in substantial compliance with the Wilton Zoning Regulations;

NOW THEREFORE BE IT RESOLVED that the Wilton Planning and Zoning Commission **APPROVES** the Sign Plan effective December 16, 2013 and subject to the following conditions:

1. This Resolution does not replace requirements for the applicant to obtain any other permits or licenses required by law or regulation by the Town of Wilton, such as but not limited to: Zoning Permit, Sign Permit, Building Permit, Certificate of Zoning Compliance; or from the State of Connecticut or the Government of the United States. Obtaining such permits or licenses is the responsibility of the applicant.
2. In accordance with Section 8-3.(i) of the Connecticut General Statutes, all work or physical improvements required and/or authorized by the approved Plan shall be completed within five years of the effective date of this resolution. This five-year period shall expire on December 15, 2018.
3. All proposed signage shall be non-illuminated unless otherwise amended by the Commission. Signage shall be installed in locations as designated on the approved signage plan.
4. Conditions pertaining to allowed alternative signage at 77 Danbury Road (existing signage)
 - a. Unless otherwise authorized by the Commission, the two existing monument signage along the Danbury Road right-of-way shall remain unchanged.

Conditions pertaining to allowed alternative signage at 77 Danbury Road (proposed signage)

- a. The façade signage shall be limited to the following:
 1. ASML Logo on two-story building – 60 square feet (4' x 15').
 2. ASML logo on cantilevered façade – 16 square feet (8'x2') – (two signs, one on each elevation of the cantilevered projection).
 3. ASML logo on single-story building– 33 square feet (3' x 11').
5. All approved signs shall be designed and erected in accordance with the aforementioned plans and as described on the alternative signage plan listed above. The proposed signs, shall be consistent with the signage represented on the submitted

plans and shall not differ with respect to size, color, design or appearance. Said signs shall be located in the areas as shown on the submitted site plan.

Submittal of revised plans and application:

6. Two (2) completed revised sets, (collated and bound) shall be submitted to the Commission's office for endorsement as "Final Approved Plan" by the Town Planner. Said plans shall include all revisions noted above and shall bear an ORIGINAL signature, seal and license number of the professional responsible for preparing each plan or portion of it. Said plans shall include the following notes:
 - a. "In accordance with Section 8-3.(i) of the Connecticut General Statutes, all work in connection with this Sign Plan shall be completed within five years after the approval of the plan. Said five-year period shall expire on December 16, 2018."
 - b. "For conditions of approval for Sign Plan, see **Resolution #1113-4Z.**"

- END RESOLUTION -

ASML US, LLC

Land Use Applications to Town of Wilton

Premises: 77 Danbury Road, Wilton, CT

List of Project Professionals

- | | |
|------------------------|---|
| 1. Owner and Applicant | ASML US, LLC
c/o Gregory and Adams, P.C.
190 Old Ridgefield Road
Wilton, CT 06897

Mr. Jason Domena
Jason.domena@asml.com |
| 2. Project Manager | Ms. Marilee Beebe, P.E.
WSP USA
6 Research Drive, Suite 260
Shelton, CT 06484
Marilee.Beebe@wsp.com |
| 2. Civil Engineer | Mr. Joseph A. Canas, P.E.
Tighe & Bond, Inc,
1000 Bridgeport Avenue
Shelton, CT 06484
jacanas@tighebond.com
203.712.1100 |
| 3. Parking Consultant | Mr. Matthew Valera
Parking Guidance Systems, LLC
mvalera@parkingguidancesystems.com
954.609.881 |
| 4. Attorney | Daniel L. Conant, Esq.
Gregory and Adams, P.C.
190 Old Ridgefield Road
Wilton, CT 06897
dconant@gregoryandadams.com
203.762.9000 |

GREGORY AND ADAMS, P.C.

ATTORNEYS AT LAW
190 OLD RIDGEFIELD ROAD
WILTON, CT 06897
(203) 762-9000
FAX: (203) 834-1628

ESTABLISHED 1964

NEW YORK OFFICE:
399 KNOLLWOOD ROAD - SUITE 201
WHITE PLAINS, NY 10603
(914) 848-5000

WWW.GREGORYANDADAMS.COM

J. CASEY HEALY
OF COUNSEL

JULIAN A. GREGORY
(1912 - 2002)

THOMAS T. ADAMS
(1929 - 2015)

PLEASE REPLY TO SENDER:
DANIEL L. CONANT

DIRECT DIAL: 203-571-6317
dconant@gregoryandadams.com

PAUL H. BURNHAM
DANIEL L. CONANT*
TREVOR C. CONLOW§
SUSAN L. GOLDMAN
J. VANCE HANCOCK
MICHAEL LAMAGNA*
DERREL M. MASON*
MATTHEW C. MASON*
JAMES D'ALTON MURPHY*
KATHLEEN L. ROYLE*
RALPH E. SLATER
ROGER R. VALKENBURGH *

* ALSO ADMITTED IN NEW YORK

⊗ ALSO ADMITTED IN VERMONT

§ ADMITTED IN NY & NJ ONLY

May 25, 2023

By E-mail and Hand Delivery

Planning and Zoning Commission
Town Hall Annex
238 Danbury Road
Wilton, CT 06897

Attn: Mr. Michael E. Wrinn – Director of Planning and Land Use Management

Re: ASML US, LLC – Application for Site Development Plan (Alternative Signage Program)
Premises: 77 Danbury Road, Wilton, Connecticut

Dear Mr. Chairman and Members of the Commission:

As attorneys for ASML US, LLC, we hereby certify that title to the above-referenced Premises is vested in ASML US, LLC by virtue of the following documents:

1. Warranty Deed from The Perkin-Elmer Corporation to SVG Lithography Systems, Inc. dated August 1, 1996 and recorded on August 2, 1996 in Volume 1002 of the Wilton Land Records at Page 329; and
2. Certificate of Change of Name by which SVG Lithography Systems Inc. changed its name to ASML US, Inc., which Certificate is dated January 17, 2002 and was recorded on January 17, 2002 in Volume 1348 of the Wilton Land Records at Page 202.
3. Certificate of Change of Name by which ASML US, Inc. changed its name to ASML US, LLC, which Certificate is dated January 30, 2019 and was recorded on February 5, 2019 in Volume 2494 of the Wilton Land Records at Page 293.

Planning and Zoning Commission
May 25, 2023
Page 2 of 2

Copies of the Warranty Deed and the Certificates of Change of Name are enclosed for the Commission's file.

Respectfully submitted,

Gregory and Adams, P.C.

By: 
Daniel Conant

DLC/ko
Enclosures

cc: Messrs. Patrick van den Bogaard and Jason Domena – ASML US, LLC
James D'Alton Murphy, Esq.

VOL 1002 PG 329

34119

TO ALL PEOPLE TO WHOM THESE PRESENTS SHALL COME, GREETING:

Know Ye, That THE PERKIN-ELMER CORPORATION, a New York Corporation, with an office and place of business located at 761 Main Avenue in the City of Norwalk, County of Fairfield and State of Connecticut, acting herein by STEPHEN L. RUDOLF, its AGENT, duly authorized, for the consideration of Ten Dollars (\$10.00) and other valuable consideration, received to its full satisfaction of SVG LITHOGRAPHY SYSTEMS, INC., a Delaware Corporation, with an office and place of business located at 101 Metro Drive, Suite 400, San Jose, California 95110, does give, grant, bargain, sell and confirm unto the said SVG Lithography Systems, Inc. and unto its successors and assigns forever the following described three tracts or parcels of land, together with the buildings and improvements thereon located, situated in the Town of Wilton, County of Fairfield and State of Connecticut:

TRACT ONE

All that certain piece or parcel of land, with the buildings and improvements thereon, situated in the Town of Wilton, County of Fairfield and State of Connecticut, and bounded and described as follows, to wit: Northerly by land now or formerly of Elizabeth W. Rodger and by a stonewall; Easterly by the westerly bank of the Norwalk River, so-called, and being land now or formerly of Marguerite L. Arnold; thence northerly by land of Marguerite L. Arnold; thence easterly by the Norwalk-Danbury Road; Southerly by land now or formerly of Charles and Florence Hoeffle; and Westerly by land now or formerly of Charles and Florence Hoeffle, being the center line of the Norwalk River; thence southerly and westerly by land of Charles and Florence Hoeffle; containing 5.3 acres, more or less, and being more particularly shown on a certain map entitled "Map Showing Property Being Conveyed to Lillian Beilin, Wilton, Connecticut", Certified "Substantially Correct" by Walter K. Goodhue, Civil Engineer, New Canaan, Conn., dated Dec. 8, 1947, Scale 1" = 60'.

Being the same premises conveyed to The Perkin-Elmer Corporation by Thomas R. Lyons and John F. Lyons by Warranty Deed dated December 1, 1965 and recorded in Volume 116, page 469 of the Wilton Land Records.

TRACT TWO

All that certain piece or parcel of land, in quantity 16.806 acres, more or less, with the buildings and improvements thereon, situated in the Town of Wilton, County of Fairfield and State of Connecticut, and bounded and described as follows:

EASTERLY by the Norwalk-Danbury Road, U.S. Route #7;

SOUTHERLY by land now or formerly of Frantisca Vogel;

S - \$175,000.00

M- \$19,250.00 Conveyance Tax Collected

Mary H. DeH...
Town Clerk of Wilton:

LSKALKEPATITDPP-BJ1-73-77.W02

VOL 1002 PG 330

EASTERLY again,	by land now or formerly of Frantisca Vogel;
SOUTHERLY again,	by land now or formerly of Frantisca Vogel;
WESTERLY	by the Norwalk-Danbury Branch of the New York, New Haven and Hartford Railroad;
NORTHERLY	by land now or formerly of Harry Richmond;
NORTHEASTERLY	by land now or formerly of Robins P. Crowell;
NORTHERLY again,	by land now or formerly of Robins P. Crowell;
EASTERLY again,	by land now or formerly of said Robins P. Crowell along the center line of the Norwalk River;
NORTHERLY again,	by land now or formerly of said Robins P. Crowell.

Said property being the easterly parcel of the premises shown on a certain map entitled "Map of Property Belonging to Elizabeth and Lemuel Hurlburt and W.B. Hurlburt, Esq. situated at South Wilton, Conn.", on file in the Office of the Town Clerk of the Town of Wilton and numbered 68, reference thereto being had.

Being the same premises conveyed to The Perkin-Elmer Corporation by The Hallicrafters Co. by Warranty Deed dated April 1, 1966 and recorded in Volume 118, page 399 of the Wilton Land Records.

TRACT THREE

All that certain piece, parcel or tract of land together with the buildings and improvements thereon, and the heating, ventilating and air conditioning equipment attached thereto, situated in the Town of Wilton, designated as "Area = 6.62 Ac." as laid down and delineated on a certain map entitled "Map of Property Prepared For The Estate of Frantisca Vogel, Wilton, Conn.", which map is on file in the office of the Town Clerk of the said Town of Wilton as the map numbered 1869, reference thereto being had. Said premises are bounded and described as follows: Beginning at a point on the westerly line of Danbury Road marking the intersection therewith of the land herein described and land now or formerly of C.G.S. Laboratories, Inc., which point of intersection is marked by a Connecticut Highway Department monument, and running thence in a generally westerly direction along the northerly line of said land now or formerly of C.G.S. Laboratories, Inc., the following courses and distances: North 61° 47' 20" West 380.00 feet, South 82° 41' 00" West 405.15 feet, South 61° 03' 20" West 94.21 feet, and North 78° 34' West 210.13 feet to the easterly line of land of the Penn Central Transportation Company, Danbury Branch; running thence in a northerly direction along the easterly line of said land of the Penn

VOL 1002 PG 331

Central Transportation Company, Danbury Branch, North 11° 26' East 420.67 feet to the southerly line of land now or formerly of Peter E. Olsen; running thence in a generally easterly direction along the southerly line of said land now or formerly of Peter E. Olsen, the following courses and distances: South 83° 24' 10" East 152.80 feet, South 74° 37' 10" East 74.50 feet, South 63° 01' 10" East 47.20 feet, South 48° 38' 10" East 76.60 feet, South 34° 13' 10" East 56.00 feet, South 75° 00' 50" East 30.10 feet, South 75° 23' 10" East 136.00 feet, and South 75° 14' 10" East 220.70 feet to a point; running thence in a northerly direction along the easterly line of said land now or formerly of Peter E. Olsen North 7° 42' 50" East 56.40 feet to a point; running thence in an easterly direction along the southerly line of said land now or formerly of Peter E. Olsen South 79° 36' 10" East 82.20 feet and South 76° 33' 10" East 172.77 feet to the westerly line of Danbury Road; running thence in a southerly direction along the westerly line of Danbury Road South 7° 34' West 199.16 feet and South 9° 43' West 102.90 feet to the northerly line of land now or formerly of C.G.S. Laboratories, Inc., being the point or place of beginning. Together with all rights appurtenant thereto including, without limitation, any right of Grantor in and to the Norwalk River and any other water courses flowing through the premises and the use of the bridges and spur railroad track hereinafter mentioned and rights of way.

Being the same premises conveyed to The Perkin-Elmer Corporation by Joan H. Faerman, formerly known as Joan H. Peltz, Executrix under the last will and testament of Harvey A. Peltz by an Executrix Deed dated January 6, 1981 and recorded in Volume 361, Page 268 of the Wilton Land Records.

SUBJECT TO:

1. Any and all provisions of any law, statute, ordinance, regulation, including zoning and planning, or public or private law of the Town of Wilton.
2. Taxes and Sewer Use charges to the Town of Wilton, hereinafter due and payable.
3. Sewer Assessment Lien in the original amount of \$12,957.25 recorded in Volume 314, Page 116 of the Wilton Land Records.
4. Sewer Assessment Lien in the original amount of \$96,317.75 recorded in Volume 314, Page 134 of the Wilton Land Records.
5. Sewer Assessment Lien in the original amount of \$3,861.00 recorded in Volume 314, Page 135 of the Wilton Land Records.
6. Sewer Assessment Lien in the original amount of \$3,208.00 recorded in Volume 360, Page 20 of the Wilton Land Records.
7. Sewer Assessment Lien in the original amount of \$41,354.50 recorded in Volume 360, Page 30 of the Wilton Land Records.

VOL 1002 PG 332

8. Sewer Assessment Lien in the original amount of \$26,053.65 recorded in Volume 398, Page 218 of the Wilton Land Records.
9. Common law and statutory rights of upper and lower riparian owners in and to the watercourses flowing through said premises.
10. The effect, if any, of a grant of easement in favor of The Southern New England Telephone Company dated February 2, 1900 and recorded February 8, 1900 in Volume 23, page 389 of the Wilton Land Records.
11. A Lease from James Adlard to the Southern New England Telephone Company recorded February 10, 1900 in Volume 23, Page 391 of the Wilton Land Records.
12. A right of way from Sarah E. Smith to Samuel D. Folsom as set forth in a deed dated June 14, 1907, and recorded June 15, 1907 in Volume 25, Page 543 of the Wilton Land Records.
13. A grant from Marshall P. Richards to The Connecticut Light & Power Company dated May 29, 1923, and recorded June 4, 1923 in Volume 35, Page 162 of the Wilton Land Records.
14. A grant from William B. Hurlbutt to The Connecticut Light & Power Company dated May 31, 1923 and recorded June 8, 1923 in Volume 35, Page 164 of the Wilton Land Records.
15. An easement in favor of The Connecticut Light & Power Company dated July 23, 1923 and recorded August 10, 1923 in Volume 35, Page 199 of the Wilton Land Records.
16. An easement from Marshall P. Richards to The Connecticut Light & Power Company dated September 19, 1923 and recorded September 26, 1923 in Volume 35, Page 228 of the Wilton Land Records.
17. Flood encroachment lines as set forth in a report from the State of Connecticut, Water Resources Commission dated October 18, 1965 and recorded October 28, 1965 in Volume 115, Page 634 of the Wilton Land Records, as shown on Map No. 2499 and Map No. 2500 both on file in the Wilton Town Clerk's Office and as may be of record in the Wilton Land Records as of the date of this deed.
18. The effect, if any, of a right to connect with a spur track as set forth in a deed from Adolph Musil to C.G.S. Laboratories, Inc., dated December 31, 1958 and recorded January 2, 1959 in Volume 77, Page 453 of the Wilton Land Records.

VOL 1002 PG 333

19. A grant in favor of the State of Connecticut from The Perkin-Elmer Corporation dated June 4, 1971 and recorded August 10, 1971 in Volume 158, Page 337 of the Wilton Land Records, as shown on Map No. 156, and Map No. 157 both on file in the Wilton Town Clerk's Office.
20. Zoning Board of Appeals Notice recorded May 9, 1978 in Volume 300, Page 177 of the Wilton Land Records.
21. Planning and Zoning Special Permit recorded April 29, 1981 in Volume 366, Page 177 of the Wilton Land Records.
22. An easement in favor of the State of Connecticut dated January 6, 1986 and recorded October 15, 1986 in Volume 566, page 264 of the Wilton Land Records, as shown on Map No. 4373 on file in the Wilton Town Clerk's Office.
23. Planning & Zoning Special Permit recorded July 2, 1987 in Volume 609, page 26 of the Wilton Land Records.
24. Planning & Zoning Resolution dated June 6, 1988 and recorded June 9, 1988 in Volume 649, Page 267 of the Wilton Land Records.
25. Planning & Zoning Resolution dated July 25, 1988 and recorded July 28, 1988 in Volume 655, Page 295 of the Wilton Land Records.
26. An easement in favor of the State of Connecticut dated May 6, 1986 and recorded March 25, 1991 in Volume 740, page 344 of the Wilton Land Records, as shown on Map 4694 on file in the Wilton Town Clerk's Office.
27. Planning & Zoning Special Permit recorded July 30, 1991 in Volume 754, page 197 of the Wilton Land Records.
28. The effect, if any, of rights of others in and to the spur track as set forth in a deed to 59 Danbury Road Associates, Inc., dated and recorded June 10, 1992 in Volume 791, Page 158 of the Wilton Land Records.
29. An easement in favor of the State of Connecticut dated July 2, 1993 and recorded July 8, 1993 in Volume 852, Page 55 of the Wilton Land Records, as shown on Map No. 4830 on file in the Wilton Town Clerk's Office.

To Have and To Hold the above granted and bargained premises, with the appurtenances thereof, unto it, the said grantee and unto its successors and assigns forever, to it and their own proper use and behoof.

VOL 1002 PG 334

And also, It, the said grantor, does for itself, its successors and assigns, covenant with the said grantee and with its successors and assigns, that at and until the ensealing of these presents, it is well seized of the premises, as a good indefeasible estate in FEE SIMPLE; and has good right to bargain and sell the same in manner and form as is above written; and that the same is free from all encumbrances whatsoever, except as hereinbefore mentioned.

And Furthermore, It, the said grantor, does by these presents bind itself and its successors and assigns forever to WARRANT AND DEFEND the above granted and bargained premises to it, the said grantee and its successors and assigns, against all claims and demands whatsoever, except as hereinbefore mentioned.

IN WITNESS WHEREOF, It has hereunto caused its seal to be set this 1st day of August, 1996

Signed, Sealed and Delivered
in the Presence of:

William S. Steele Jr.
Catherine M. Agius
CATHERINE M. AGIUS

THE PERKIN-ELMER CORPORATION

By Stephen L. Rube
STEPHEN L. RUBE
Its AGENT
Duly Authorized

STATE OF CONNECTICUT :

: ss.:

, August 1, 1996

COUNTY OF FAIRFIELD :

Personally appeared Stephen L. Rube, duly authorized AGENT of THE PERKIN-ELMER CORPORATION, Signer and Sealer of the foregoing Instrument, and acknowledged the same to be his free act and deed and the free act and deed of said Corporation, before me.

William S. Steele Jr.
Commissioner of the Superior Court
~~Notary Public~~ William S. Steele Jr.

Latest address of Grantee:
101 Metro Drive, Suite 400
San Jose
California 95110

Received for Record August 02, 1996

at 12:12 P. M. Attest

Town Clerk

000066885 Bk:01348 Pg:00202

Grantor: SVG Lithography Systems, Inc.
 Grantee: ASML US, Inc.

CERTIFICATE OF CHANGE OF NAME

SVG LITHOGRAPHY SYSTEMS, INC., a Delaware corporation ("SVG"), the owner of certain real property commonly known as 77 Danbury Road, Wilton, Connecticut, and more particularly bounded and described on Schedule A attached hereto and made a part hereof, has merged into its parent corporation, ASML US, INC., a Delaware corporation having its principal place of business at 8555 South River Parkway, Tempe, AZ 85284 (the "Company"), with the Company being the surviving entity. A copy of the Certificate of Merger filed with the office of the Secretary of State of Delaware is attached hereto as Schedule B.

This certificate is duly acknowledged and given for record in compliance with Connecticut General Statutes §47-12.

Dated this 31st day of December, 2001.

Witnesses:

ASML US, INC.

Paul Wallen
 JASON WALLEN

By:

Its: VP Finance, ASML US
 Duly Authorized

E. GEORGE JACOBY

STATE OF CALIFORNIA)

COUNTY OF San Jose)

ss.: SAN JOSE

The foregoing instrument was acknowledged before me this 4th day of January, 2002 by Joe Passarello, VP FINANCE of ASML US, Inc., a Delaware corporation, on behalf of the corporation.



Lori M. Martinez
 Notary Public
 Commission Expires: Sept. 24, 2005

OR

000066885 Bk:01348 Pg:00203

STATE OF CALIFORNIA)

COUNTY OF _____)

SS.: _____

On December ____, 2001, before me, _____ (name and title of officer),
 personally appeared _____ (name of signer(s)),

- ☐ personally known to me
☐ proved to me on the basis of satisfactory evidence

to be the person (s) whose name(s) is/are subscribed to the within instrument and acknowledged to me that he/she/they executed the same in his/her/their authorized capacity(ies), and that by his/her/their signature(s) on the instrument the person(s), or the entity upon behalf of which the person(s) acted, executed the instrument.

WITNESS my hand and official seal.

 (Signature of Notary Public)

(Place Notary Seal Above)

OPTIONAL

Though the data below is not required by law, it may prove valuable to persons relying on the document and could prevent fraudulent reattachment of this form.

CAPACITY CLAIMED BY SIGNER

- ☐ Individual
☐ Corporate Officer

 Title(s)

- ☐ Partner(s) ☐ Limited
☐ Attorney-in-Fact ☐ General
☐ Trustee(s)
☐ Guardian/Conservator
☐ Other: _____

DESCRIPTION OF ATTACHED DOCUMENT

 Title or Type of Document

 Number of Pages

 Date of Document

 Signers(s) Other Than Named Above

SIGNER IS REPRESENTING:

Name of Person(s) or Entity(ies)

000066885 Bk: 01348 Pg: 00204

SCHEDULE A**TRACT ONE**

All that certain piece or parcel of land, with the buildings and improvements thereon, situated in the Town of Wilton, County of Fairfield and State of Connecticut, and bounded and described as follows, to wit: Northerly by land now or formerly of Elizabeth W. Rodger and by a stone wall; Easterly by the westerly bank of the Norwalk River, so-called, and being land now or formerly of Marguerite L. Arnold; thence northerly by land of Marguerite L. Arnold; thence easterly by the Norwalk-Danbury Road; southerly by land now or formerly of Charles and Florence Hootle; and Westerly by land now or formerly of Charles and Florence Hootle, being the center line of the Norwalk River; thence southerly and westerly by land of Charles and Florence Hootle; containing 3.3 acres, more or less, and being more particularly shown on a certain map entitled "Map Showing Property Being Conveyed to Lilian Bellin, Wilton, Connecticut", Certified "Substantially Correct" by Walter K. Goodhue, Civil Engineer, New Canaan, Conn., dated Dec. 2, 1947, Scale 1" = 40'.

Being the same premises conveyed to The Pettko-Elmer Corporation by Thomas R. Lyons and John P. Lyons by Warranty Deed dated December 1, 1963 and recorded in Volume 116, page 469 of the Wilton Land Records.

TRACT TWO

All that certain piece or parcel of land, in quantity 16.804 acres, more or less, with the buildings and improvements thereon, situated in the Town of Wilton, County of Fairfield and State of Connecticut, and bounded and described as follows:

EASTERLY	by the Norwalk-Danbury Road, U.S. Route #7;
SOUTHERLY	by land now or formerly of Frances Vogel;
EASTERLY again,	by land now or formerly of Frances Vogel;
SOUTHERLY again,	by land now or formerly of Frances Vogel;
WESTERLY	by the Norwalk-Danbury Branch of the New York, New Haven and Hartford Railroad;
NORTHERLY	by land now or formerly of Harry Richmond;
NORTHEASTERLY	by land now or formerly of Robins P. Crowell;
NORTHERLY again,	by land now or formerly of Robins P. Crowell;
EASTERLY again,	by land now or formerly of said Robins P. Crowell along the center line of the Norwalk River;
NORTHERLY again,	by land now or formerly of said Robins P. Crowell.

Said property being the easterly parcel of the premises shown on a certain map entitled "Map of Property Belonging to Elizabeth and Lemuel Hurlburt and W.B. Hurlburt, Esq., situated at South Wilton, Conn.", on file in the Office of the Town Clerk of the Town of Wilton and numbered 68, reference thereto being had.

Being the same premises conveyed to The Pettko-Elmer Corporation by The Hallcrafters Co. by Warranty Deed dated April 1, 1966 and recorded in Volume 118, page 399 of the Wilton Land Records.

000066885 Bk:01348 Pg:00205

SCHEDULE A-1

TRACT THREE

All that certain piece, parcel or tract of land together with the buildings and improvements thereon, and the heating, ventilating and air conditioning equipment attached thereto, situated in the Town of Wilton, designated as "Acre - 6.62 Ac." as laid down and delineated on a certain map entitled "Map of Property Prepared For The Estate of Francesa Vogel, Wilton, Conn.", which map is on file in the office of the Town Clerk of the said Town of Wilton as the map numbered 1860, reference thereto being had. Said premises are bounded and described as follows: Beginning at a point on the westerly line of Danbury Road marking the intersection therewith of the land herein described and land now or formerly of C.O.S. Laboratories, Inc., which point of intersection is marked by a Connecticut Highway Department monument and running thence in a generally westerly direction along the northerly line of said land now or formerly of C.O.S. Laboratories, Inc., the following courses and distances: North 61° 47' 20" West 380.00 feet, South 82° 41' 00" West 405.15 feet, South 61° 03' 20" West 94.31 feet, and North 78° 34' West 210.13 feet to the easterly line of land of the Penn Central Transportation Company, Danbury Branch; running thence in a northerly direction along the westerly line of said land of the Penn

Central Transportation Company, Danbury Branch, North 11° 20' East 630.67 feet to the southerly line of land now or formerly of Peter E. Olsen; running thence in a generally easterly direction along the southerly line of said land now or formerly of Peter E. Olsen, the following courses and distances: South 83° 34' 10" East 132.80 feet, South 74° 37' 10" East 74.50 feet, South 43° 01' 10" East 47.20 feet, South 48° 38' 10" East 74.80 feet, South 34° 13' 10" East 56.00 feet, South 75° 00' 50" East 30.10 feet, South 75° 23' 10" East 196.00 feet, and South 75° 14' 10" East 120.70 feet to a point; running thence in a northerly direction along the easterly line of said land now or formerly of Peter E. Olsen North 7° 42' 50" East 56.40 feet to a point; running thence in an easterly direction along the easterly line of said land now or formerly of Peter E. Olsen South 70° 36' 10" East 61.30 feet and South 76° 33' 10" East 172.77 feet to the westerly line of Danbury Road; running thence in a southerly direction along the westerly line of Danbury Road South 7° 34' West 189.16 feet and South 9° 43' West 103.90 feet to the northerly line of land now or formerly of C.O.S. Laboratories, Inc., being the point or place of beginning. Together with all rights appurtenant thereto including, without limitation, any right of drainage in and to the Norwalk River and any other water courses flowing through the premises and the use of the bridges and spur railroad track hereinafter mentioned and rights of way.

Being the same premises conveyed to The Perkin-Elmer Corporation by Joan H. Fastman, formerly known as Joan H. Felts, Executrix under the last will and testament of Henry A. Felts by an Executrix Deed dated January 6, 1981 and recorded in Volume 361, Page 268 of the Wilton Land Records.

000066885 Bk:01348 Pg:00206

Delaware

PAGE 1

The First State

I, HARRIET SMITH WINDSOR, SECRETARY OF STATE OF THE STATE OF DELAWARE, DO HEREBY CERTIFY THE ATTACHED IS A TRUE AND CORRECT COPY OF THE CERTIFICATE OF OWNERSHIP, WHICH MERGES:

"SVG LITHOGRAPHY SYSTEMS, INC.", A DELAWARE CORPORATION, WITH AND INTO "ASML US, INC." UNDER THE NAME OF "ASML US, INC.", A CORPORATION ORGANIZED AND EXISTING UNDER THE LAWS OF THE STATE OF DELAWARE, AS RECEIVED AND FILED IN THIS OFFICE THE TWENTY-EIGHTH DAY OF DECEMBER, A.D. 2001, AT 2 O'CLOCK P.M.

AND I DO HEREBY FURTHER CERTIFY THAT THE EFFECTIVE DATE OF THE AFORESAID CERTIFICATE OF OWNERSHIP IS THE THIRTY-FIRST DAY OF DECEMBER, A.D. 2001.

A FILED COPY OF THIS CERTIFICATE HAS BEEN FORWARDED TO THE NEW CASTLE COUNTY RECORDER OF DEEDS.

2114543 8100M

010674325



Harriet Smith Windsor

Harriet Smith Windsor, Secretary of State

AUTHENTICATION: 1535710

DATE: 01-02-02

000066885 Bk:01348 Pg:00207

STATE OF DELAWARE
SECRETARY OF STATE
DIVISION OF CORPORATIONS
FILED 02:00 PM 12/28/2001
010674325 - 2114543

CERTIFICATE OF OWNERSHIP AND MERGER

MERGING

SVG LITHOGRAPHY SYSTEMS, INC.
(A Delaware Corporation)

INTO

ASML US, INC.
(A Delaware Corporation)

(Pursuant to Section 253 of the General Corporation Law of Delaware)

We, the undersigned Peter T.F.M. Wennink and Robert F. Roelofs, hereby certify as to the following facts relating to the merger of SVG Lithography Systems, Inc. and ASML US, Inc. (the "Merger"):

1. We are the President and Secretary, respectively, of ASML US, Inc., a corporation organized under the laws of the State of Delaware (the "Company"), the provisions of which permit the merger of a subsidiary corporation into a parent corporation.
2. The Company owns at least 90% of the outstanding shares of SVG Lithography Systems, Inc., a Delaware corporation ("SVGL").
3. The sole minority stockholder of SVGL owns less than 10% of the shares of Common Stock of SVGL.
4. SVGL is hereby merged with and into ASML US, Inc., and the name of the surviving corporation shall be ASML US, Inc. (the "Surviving Corporation").
5. The 5,000 shares of Common Stock of SVGL held by the sole minority stockholder is hereby converted into the right to receive an aggregate of \$37,000.00 upon the effectiveness of the Merger.
6. This Certificate of Merger shall be effective on December 31, 2001.
7. The Board of Directors of the Company duly adopted the following resolutions on December 21, 2001 by unanimous written consent:

000066885 Bk:01348 Pg:00208

Merger of SVG Lithography Systems, Inc. with and into the Company

WHEREAS, the Company lawfully owns at least 90% of the capital stock of SVG Lithography Systems, Inc., a Delaware corporation ("SVGL"), and now desires to merge SVGL with and into the Company:

NOW, THEREFORE, BE IT RESOLVED: That the Board of Directors of the Company hereby determines that it is in the best interests of the Company and SVGL to merge SVGL with and into the Company, and for the Company to assume all of the liabilities and obligations of SVGL for all such actions to be carried out by the Company, as the majority stockholder of SVGL;

RESOLVED FURTHER: Upon completion of the merger, the five thousand (5,000) shares of SVGL Common Stock held by the sole minority stockholder will be automatically converted upon surrender of the certificate or certificates representing such shares of common stock into the right to receive \$37,000.00.

RESOLVED FURTHER: That the aggregate cash consideration of \$37,000.00 to be paid to the sole minority stockholder is fair, just and reasonable consideration for the five thousand (5,000) shares of SVGL common stock held by such stockholder.

RESOLVED FURTHER: That the Certificate of Ownership and Merger, substantially in the form attached hereto as Exhibit A, is hereby approved and authorized in all respects, with such changes, additions, deletions, supplements and amendments thereto as the Chief Executive Officer, President or any Vice President of the Company may deem necessary or advisable, such determination to be conclusively evidenced by his or her execution thereof; and that each of the Chief Executive Officer, President, Secretary and any Vice President of the Company is authorized and directed to execute and deliver the Certificate of Ownership and Merger on behalf of the Company, and to file the same in the office of the Secretary of State of the State of Delaware.

[THE REMAINDER OF THIS PAGE INTENTIONALLY LEFT BLANK]

000066885 Bk:01348 Pg:00209

IN WITNESS WHEREOF, the undersigned have executed this Certificate of Ownership
and Merger this 21st day of December 2001.

/s/ Peter T. F. M. Wennink
Peter T.F.M. Wennink
President

/s/ Robert F. Roelofs
Robert F. Roelofs
Secretary

C:\TEMP\1992147_4.DOC

-3-

RECEIVED FOR RECORD 01/17/2002
AT 03:17:15PM
ATTEST: Bettye Joan Ragnonetti
TOWN CLERK

GREGORY AND ADAMS, P.C.
190 OLD RIDGEFIELD ROAD
WILTON, CONNECTICUT 06897

Doc ID: 001057460007 Type: LAN
BK 2494 PG 293-299

Certificate of Change of Name

TO WHOM IT MAY CONCERN:

Be it known that **ASML US, LLC**, a Delaware limited liability company, owning property by virtue of a deed recorded in the land records of the Town of Wilton, County of Fairfield and State of Connecticut, in Volume 1002 at Page 329 in the name of **SVG LITHOGRAPHY SYSTEMS, INC.**, which name was previously changed to **ASML US, INC.** by Certificate of Change of Name dated December 31, 2001 and recorded in Volume 1348 at Page 202 of the Wilton Land Records, and which name has now been changed to **ASML US, LLC** by virtue of Certificate of Conversion (a copy of which is attached hereto as Exhibit A), has duly acknowledged this certificate and given it for record in compliance the statutory requirements of the State of Connecticut.

Premises commonly known as: **77 Danbury Road, Wilton, Connecticut**

Dated this 30th day of January, 2019.

Witnesses:

Jennifer Funder
Vanessa Stuart

ASML US, LLC

Keith Maki
By: Keith Maki
Its: Treasurer
Duly Authorized

State of Arizona

Date: 30 Jan 2019

SS:

County of Maricopa

Personally appeared **ASML US, LLC**, acting herein by Keith Maki, its Treasurer, duly authorized, who subscribed and swore to the truth of the foregoing certificate, and who acknowledged that he executed the same before me, the undersigned officer.

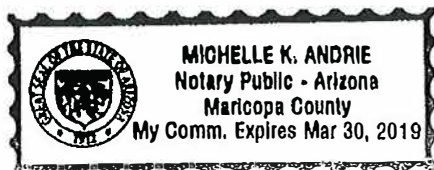

Michelle K Andrie
Notary Public
My Commission Expires: 3/30/2019

Delaware

The First State

Page 1

I, JEFFREY W. BULLOCK, SECRETARY OF STATE OF THE STATE OF DELAWARE, DO HEREBY CERTIFY THAT THE ATTACHED IS A TRUE AND CORRECT COPY OF THE CERTIFICATE OF CONVERSION OF A DELAWARE CORPORATION UNDER THE NAME OF "ASML US, INC." TO A DELAWARE LIMITED LIABILITY COMPANY, CHANGING ITS NAME FROM "ASML US, INC." TO "ASML US, LLC", FILED IN THIS OFFICE ON THE NINETEENTH DAY OF DECEMBER, A.D. 2017, AT 5:53 O'CLOCK P.M.

AND I DO HEREBY FURTHER CERTIFY THAT THE EFFECTIVE DATE OF THE AFORESAID CERTIFICATE OF CONVERSION IS THE FIRST DAY OF JANUARY, A.D. 2018 AT 11 O'CLOCK A.M.



A handwritten signature in dark ink, appearing to read "JBullock", is written over a horizontal line. Below the line, the text "Jeffrey W. Bullock, Secretary of State" is printed in a small font.

3294667 8100V
SR# 20177671237

You may verify this certificate online at corp.delaware.gov/authver.shtml

Authentication: 203809833
Date: 12-21-17

State of Delaware
Secretary of State
Division of Corporations
Delivered 05:53 PM 12/19/2017
FILED 05:53 PM 12/19/2017
SR 20177671237 - File Number 3294667

ASML US, INC.

STATE OF DELAWARE
CERTIFICATE OF CONVERSION
FROM A CORPORATION TO A LIMITED LIABILITY COMPANY
PURSUANT TO SECTION 18-214 OF THE
LIMITED LIABILITY COMPANY ACT

1. The jurisdiction where the Corporation first formed is Delaware.
2. The jurisdiction immediately prior to filing this Certificate is Delaware.
3. The date the Corporation first formed is September 28, 2000.
4. The name of the Corporation immediately prior to filing this Certificate is "ASML US, Inc."
5. The name of the Limited Liability Company as set forth in the Certificate of Formation is "ASML US, LLC."
6. This Certificate of Conversion shall be effective at 11:00 a.m. Eastern Standard Time on January 1, 2018.

* * *

IN WITNESS WHEREOF, the undersigned has executed this Certificate as of the
19th day of December, 2017.

Name: Jerry Deuba
Title: Authorized Person

[Signature Page to Certificate of Conversion]

Delaware

The First State

Page 1

I, JEFFREY W. BULLOCK, SECRETARY OF STATE OF THE STATE OF
DELAWARE DO HEREBY CERTIFY THAT THE ATTACHED IS A TRUE AND
CORRECT COPY OF THE CERTIFICATE OF FORMATION OF "ASML US, LLC"
FILED IN THIS OFFICE ON THE NINETEENTH DAY OF DECEMBER, A.D.
2017, AT 5:53 O'CLOCK P.M.

AND I DO HEREBY FURTHER CERTIFY THAT THE EFFECTIVE DATE
OF THE AFORESAID CERTIFICATE OF FORMATION IS THE FIRST DAY OF
JANUARY, A.D. 2018 AT 11 O'CLOCK A.M.



3294667 8100V
SR# 20177671237

You may verify this certificate online at corp.delaware.gov/authver.shtml

A handwritten signature in black ink, appearing to read "JB", is written over a horizontal line. Below the line, the text "Jeffrey W. Bullock, Secretary of State" is printed.

Jeffrey W. Bullock, Secretary of State

Authentication: 203809833
Date: 12-21-17

State of Delaware
Secretary of State
Division of Corporations
Delivered 05:53 PM 12/19/2017
FILED 05:53 PM 12/19/2017
SR 20177671237 - File Number 3294667

CERTIFICATE OF FORMATION

OF

ASML US, LLC

This Certificate of Formation is being executed as of this 19th day of December, 2017, for the purpose of forming a limited liability company pursuant to the Delaware Limited Liability Company Act, *Title 6 Del. Code §§18-101*, et seq.

The undersigned, being duly authorized to execute and file this Certificate of Formation, does hereby certify as follows:

1. *Name.* The name of the limited liability company is:

ASML US, LLC (the "Company").

2. *Registered Office and Registered Agent.* The address of the Company's registered office in the State of Delaware is:

Corporation Trust Center
1209 Orange Street
Wilmington, New Castle County, Delaware 19801

The name of the Company's registered agent at such address is:

The Corporation Trust Company

3. *Effective Time.* This Certificate of Formation shall be effective at 11:00 a.m. Eastern Standard Time on January 1, 2018.

* * *

IN WITNESS WHEREOF, the undersigned has duly executed this Certificate of Formation as of the day and year first above written.

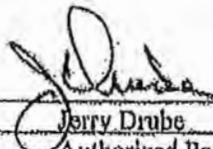
Name: Jerry Dube
Title: Authorized Person

[Signature Page to Certificate of Formation]