

**WILTON PLANNING AND
ZONING COMMISSION**

**ARCHITECTURAL REVIEW BOARD/VILLAGE
DISTRICT DESIGN ADVISORY COMMITTEE APPLICATION**

Wilton Library Association	137 Old Ridgefield Road, Wilton CT 06897
APPLICANT'S NAME	ADDRESS
Wilton Library Association	137 Old Ridgefield Road, Wilton CT 06897
OWNER'S NAME	ADDRESS
137 Old Ridgefield Road, Wilton CT 06897	WC
PROPERTY LOCATION	ZONING DISTRICT

WLR	VOLUME	PAGE	TAX MAP #	LOT #	ACREAGE
-----	--------	------	-----------	-------	---------

THE FOLLOWING MATERIALS ARE REQUIRED:

* Please see **SPECIAL INSTRUCTIONS FOR SUBMISSION DURING COVID** at:

[Application Forms / Materials | Wilton CT](#)

* All submitted plans and documents shall bear an **original signature, seal, and license number** of the professional responsible for preparing each item. Maps should be **folded, not rolled** – 11" x 17" Plan Copies

**ELECTRONIC SUBMISSION OF ALL APPLICATION MATERIALS (CONSOLIDATED INTO
1 OR 2 PDFs MAXIMUM), emailed to: michael.wrinn@wiltonct.org & daphne.white@wiltonct.org**

- i. An application form;
- ii. A statement describing the proposed project (use page 2 or attach separate sheet);
- iii. The following plans, where applicable, based on the nature of the proposed project:

- ☐ 1. An A-2 survey for any proposal involving the physical enlargement of a building, structure, parking area and/or vehicle access aisle.
- ☐ 2. A site plan drawn at a scale of no greater than 1" = 60', incorporating an A-2 survey (where required), of the property sufficient to show the location of:

- a. wetlands, upland buffers, watercourse and flood zones, if any;
- b. existing and/or proposed buildings and appurtenances thereof;
- c. existing and/or proposed parking accommodations;
- d. existing and/or proposed lighting
- e. existing and proposed buffer strips and landscaping;
- f. access and egress details for pedestrian and vehicular traffic;
- g. existing and/or proposed signs, and
- h. adjacent roads, curb cuts, and width of rights-of-way and travel way.
- i. easements, regulatory setbacks, historic covenants or other historic assets.

- ☐ 3. Floor plans at each level showing the basic divisions of the building, all entrances, exits and loading and service areas.
- ☐ 4. A description of the architectural vernacular of proposed construction and its architectural relationship to other buildings within 500 feet.
- ☐ 5. Elevation drawings of all sides of the building, with dimensions, finish materials, fixtures, lighting, signage, landscape and colors indicated.

- ☐ 6. Samples of all finish materials to be used on the exterior of the building.
- ☐ 7. A roof plan showing all mechanical equipment, vents, hatches, skylights, solar arrays, wind turbines, green roofing etc., and the type and extent of screening to be provided.
- ☐ 8. A signage plan with a scaled drawing showing the design of any proposed signage, including dimensions (length, width, height), a drawing of sign design and content, colors of sign, materials for construction and illumination, together with a site plan showing location of proposed free-standing sign and/or building elevations showing location and proportions of wall signs.

THE APPLICANT understands that this application is to be considered complete only when all information and documents required by the Commission have been submitted and is responsible for the payment of all legal notices incurred.

THE UNDERSIGNED WARRANTS the truth of all statements contained herein and in all supporting documents according to the best of his or her knowledge and belief; and hereby grants visitation and inspection of the subject property as described herein.

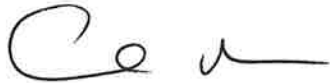

APPLICANT'S SIGNATURE

8/17/2023

DATE

203-762-6322

TELEPHONE



OWNER'S SIGNATURE

8/17/2023

DATE

203-762-6322

TELEPHONE

PROJECT NARRATIVE:

Please see attached "Project Proposal"

Thank you for considering our application.

Caroline Mandler
Executive Director
Wilton Library Association, Inc.
137 Old Ridgefield Road
Wilton, CT 06897
(203) 762-6322
cmandler@wiltonlibrary.org

Sandy Stein
Board Member, Wilton Library Association
sstein@wiltonlibrary.org



Wilton Library Project Proposal

August 2023

Proposed Project: Wilton Library Parking Lot Banners

Our proposal is to create 16 double-sided permanent banners that would hang from existing poles in the Library Parking lot.

Project Specifications:

Number of Banners: 16

Dimensions: 24" x 54"

Location: Library parking lot

Timeframe: Permanent, year-round

Reason for Proposal:

A direct reflection of the Library's branding, the banners would educate by communicating the Library's mission to "inform, enrich, connect and inspire our community" by using these very words on the banners themselves. Additionally, we believe the simple, artful design and vibrancy of the banners would encourage Library visitation and enhance the vitality of Wilton Center. These banners will be similar to the banners put up for our 125th Anniversary in 2020 which were very well received by the town. (See page 5)

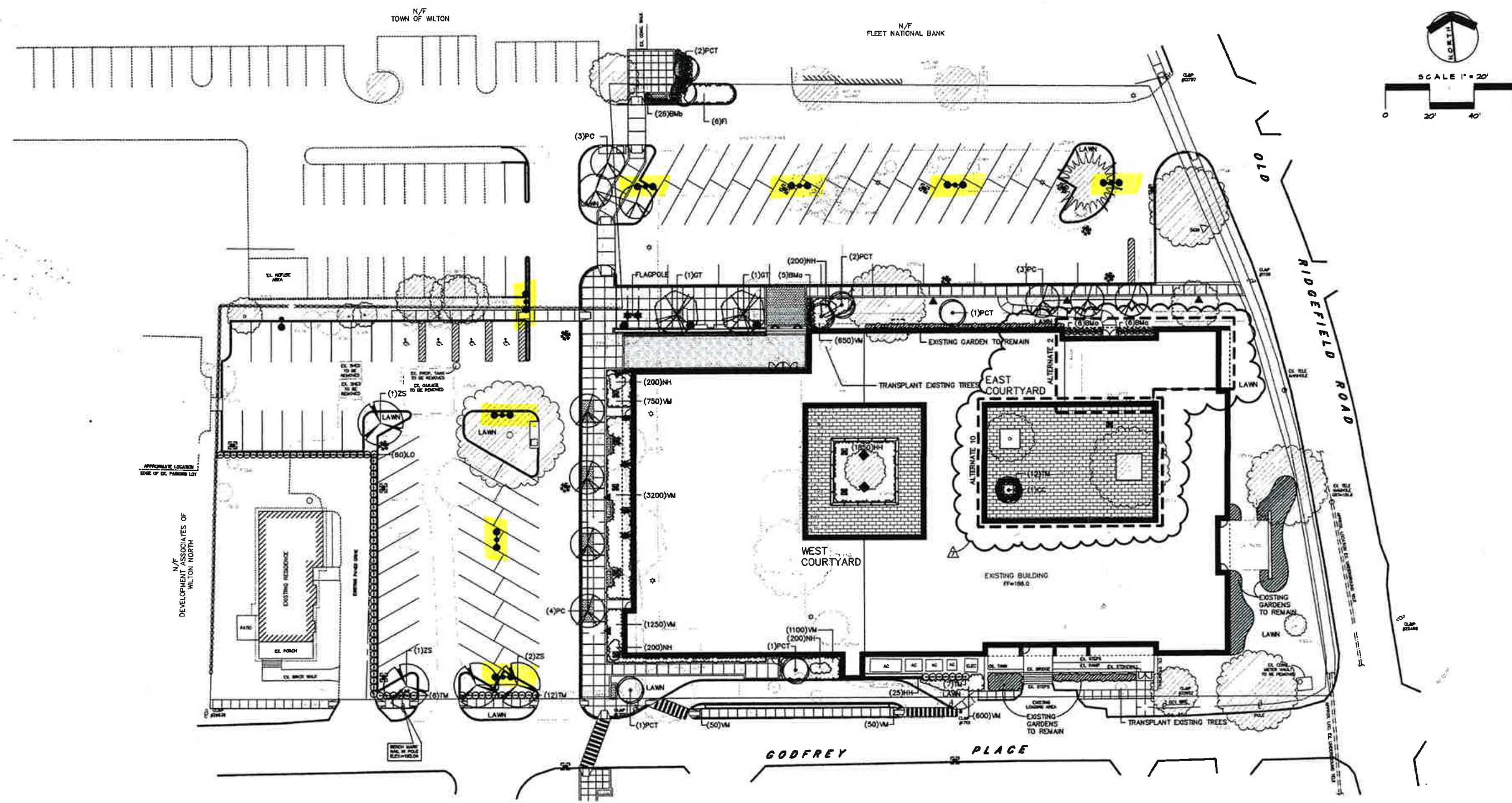

TAI SOO KIM PARTNERS
ARCHITECTS
285 Farmington Avenue
Hartford, Connecticut
Tel: (860) 547-1970
Fax: (860) 248-9865
e-mail: tskim@tskpa.com

ENVIRONMENTAL
DESIGN ASSOCIATES P.C.
1000 Main Street, Suite 200
Hartford, Connecticut 06103
Tel: (860) 521-1111
Fax: (860) 521-1112
e-mail: info@eda-hartford.com

WILTON LIBRARY

137 OLD RIDGEFIELD ROAD

WILTON, CONNECTICUT 06897

PLANTING & LIGHTING PLAN

PROJECT NUMBER: 22001
SCALE: 1" = 20'
DATE: AUGUST 8, 2003

REVISIONS:
1. 8-08-03 ISSUED TO PLANNING & ZONING
2. 10-27-03 RE-DESIGNED TO P. & Z.
3. 11-24-03 PLANT REVISIONS FOR CONSERVATION
4. 01-21-04 REVISED & ISSUED FOR PERMIT
5. 04-30-04 REV. & ISSUED FOR WORK SET
6. 05-28-04 REV. PER TSK
7. 08-15-04 REVISED PER TSK
CHAFFIN: 09-13-04per

L-1

PLANT LIST-ALL PROPOSED PLANT MATERIAL TO BE LOCATED IN FIELD BY LANDSCAPE ARCHITECT

QUAN.	KEY	BOTANICAL NAME	COMMON NAME	SIZE	REMARKS
DECIDUOUS TREES					
1	CC	Cercis canadensis	Southern Red Bud	3-2 1/2" cal.	848
2	BT	Buddleia fraxinifolia var. 'harlequin'	Buddleia Harlequin	3-2 1/2" cal.	848
3	PCF	Prunella canadensis 'Thundercloud'	Thundercloud Plum	3-2 1/2" cal.	848
4	PC	Prunella virginiana 'Chanticleer'	Chanticleer Cherry Plum	3-2 1/2" cal.	848
5	ZS	Zelkova serrata	Japanese Zelkova	5-8 1/2" cal.	848
DECIDUOUS SHRUBS					
6	PL	Paniclea laevis	Border Paniclea	50-60" H.	848
7	LO	Ligustrum obtusifolium	Border Privet	50-60" H.	848
EVERGREEN SHRUBS					
8	SH	Shorea macrophylla var. 'lanceolata'	Hillside Shrub	18-24" H.	848
9	SH	Shorea macrophylla var. 'lanceolata'	Hillside Shrub	24-30" H.	848
10	TH	Thunbergia alata	Japanese Yew	24-30" H.	848
GRASSES, PERENNIALS, GEOPHYTES, ETC.					
11	HH	Hesperis matronalis	Matrona	3" H.	8" O.C.
12	HH	Hesperis matronalis	Matrona	3" H.	8" O.C.
13	HH	Hesperis matronalis	Matrona	3" H.	8" O.C.
14	HH	Hesperis matronalis	Matrona	3" H.	8" O.C.
15	HH	Hesperis matronalis	Matrona	3" H.	8" O.C.
16	HH	Hesperis matronalis	Matrona	3" H.	8" O.C.
17	HH	Hesperis matronalis	Matrona	3" H.	8" O.C.
18	HH	Hesperis matronalis	Matrona	3" H.	8" O.C.
19	HH	Hesperis matronalis	Matrona	3" H.	8" O.C.
20	HH	Hesperis matronalis	Matrona	3" H.	8" O.C.
21	HH	Hesperis matronalis	Matrona	3" H.	8" O.C.
22	HH	Hesperis matronalis	Matrona	3" H.	8" O.C.
23	HH	Hesperis matronalis	Matrona	3" H.	8" O.C.
24	HH	Hesperis matronalis	Matrona	3" H.	8" O.C.
25	HH	Hesperis matronalis	Matrona	3" H.	8" O.C.
26	HH	Hesperis matronalis	Matrona	3" H.	8" O.C.
27	HH	Hesperis matronalis	Matrona	3" H.	8" O.C.
28	HH	Hesperis matronalis	Matrona	3" H.	8" O.C.
29	HH	Hesperis matronalis	Matrona	3" H.	8" O.C.
30	HH	Hesperis matronalis	Matrona	3" H.	8" O.C.
31	HH	Hesperis matronalis	Matrona	3" H.	8" O.C.
32	HH	Hesperis matronalis	Matrona	3" H.	8" O.C.
33	HH	Hesperis matronalis	Matrona	3" H.	8" O.C.
34	HH	Hesperis matronalis	Matrona	3" H.	8" O.C.
35	HH	Hesperis matronalis	Matrona	3" H.	8" O.C.
36	HH	Hesperis matronalis	Matrona	3" H.	8" O.C.
37	HH	Hesperis matronalis	Matrona	3" H.	8" O.C.
38	HH	Hesperis matronalis	Matrona	3" H.	8" O.C.
39	HH	Hesperis matronalis	Matrona	3" H.	8" O.C.
40	HH	Hesperis matronalis	Matrona	3" H.	8" O.C.
41	HH	Hesperis matronalis	Matrona	3" H.	8" O.C.
42	HH	Hesperis matronalis	Matrona	3" H.	8" O.C.
43	HH	Hesperis matronalis	Matrona	3" H.	8" O.C.
44	HH	Hesperis matronalis	Matrona	3" H.	8" O.C.
45	HH	Hesperis matronalis	Matrona	3" H.	8" O.C.
46	HH	Hesperis matronalis	Matrona	3" H.	8" O.C.
47	HH	Hesperis matronalis	Matrona	3" H.	8" O.C.
48	HH	Hesperis matronalis	Matrona	3" H.	8" O.C.
49	HH	Hesperis matronalis	Matrona	3" H.	8" O.C.
50	HH	Hesperis matronalis	Matrona	3" H.	8" O.C.
51	HH	Hesperis matronalis	Matrona	3" H.	8" O.C.
52	HH	Hesperis matronalis	Matrona	3" H.	8" O.C.
53	HH	Hesperis matronalis	Matrona	3" H.	8" O.C.
54	HH	Hesperis matronalis	Matrona	3" H.	8" O.C.
55	HH	Hesperis matronalis	Matrona	3" H.	8" O.C.
56	HH	Hesperis matronalis	Matrona	3" H.	8" O.C.
57	HH	Hesperis matronalis	Matrona	3" H.	8" O.C.
58	HH	Hesperis matronalis	Matrona	3" H.	8" O.C.
59	HH	Hesperis matronalis	Matrona	3" H.	8" O.C.
60	HH	Hesperis matronalis	Matrona	3" H.	8" O.C.
61	HH	Hesperis matronalis	Matrona	3" H.	8" O.C.
62	HH	Hesperis matronalis	Matrona	3" H.	8" O.C.
63	HH	Hesperis matronalis	Matrona	3" H.	8" O.C.
64	HH	Hesperis matronalis	Matrona	3" H.	8" O.C.
65	HH	Hesperis matronalis	Matrona	3" H.	8" O.C.
66	HH	Hesperis matronalis	Matrona	3" H.	8" O.C.
67	HH	Hesperis matronalis	Matrona	3" H.	8" O.C.
68	HH	Hesperis matronalis	Matrona	3" H.	8" O.C.
69	HH	Hesperis matronalis	Matrona	3" H.	8" O.C.
70	HH	Hesperis matronalis	Matrona	3" H.	8" O.C.
71	HH	Hesperis matronalis	Matrona	3" H.	8" O.C.
72	HH	Hesperis matronalis	Matrona	3" H.	8" O.C.
73	HH	Hesperis matronalis	Matrona	3" H.	8" O.C.
74	HH	Hesperis matronalis	Matrona	3" H.	8" O.C.
75	HH	Hesperis matronalis	Matrona	3" H.	8" O.C.
76	HH	Hesperis matronalis	Matrona	3" H.	8" O.C.
77	HH	Hesperis matronalis	Matrona	3" H.	8" O.C.
78	HH	Hesperis matronalis	Matrona	3" H.	8" O.C.
79	HH	Hesperis matronalis	Matrona	3" H.	8" O.C.
80	HH	Hesperis matronalis	Matrona	3" H.	8" O.C.
81	HH	Hesperis matronalis	Matrona	3" H.	8" O.C.
82	HH	Hesperis matronalis	Matrona	3" H.	8" O.C.
83	HH	Hesperis matronalis	Matrona	3" H.	8" O.C.
84	HH	Hesperis matronalis	Matrona	3" H.	8" O.C.
85	HH	Hesperis matronalis	Matrona	3" H.	8" O.C.
86	HH	Hesperis matronalis	Matrona	3" H.	8" O.C.
87	HH	Hesperis matronalis	Matrona	3" H.	8" O.C.
88	HH	Hesperis matronalis	Matrona	3" H.	8" O.C.
89	HH	Hesperis matronalis	Matrona	3" H.	8" O.C.
90	HH	Hesperis matronalis	Matrona	3" H.	8" O.C.
91	HH	Hesperis matronalis	Matrona	3" H.	8" O.C.
92	HH	Hesperis matronalis	Matrona	3" H.	8" O.C.
93	HH	Hesperis matronalis	Matrona	3" H.	8" O.C.
94	HH	Hesperis matronalis	Matrona	3" H.	8" O.C.
95	HH	Hesperis matronalis	Matrona	3" H.	8" O.C.
96	HH	Hesperis matronalis	Matrona	3" H.	8" O.C.
97	HH	Hesperis matronalis	Matrona	3" H.	8" O.C.
98	HH	Hesperis matronalis	Matrona	3" H.	8" O.C.
99	HH	Hesperis matronalis	Matrona	3" H.	8" O.C.
100	HH	Hesperis matronalis	Matrona	3" H.	8" O.C.

PLANTING LEGEND

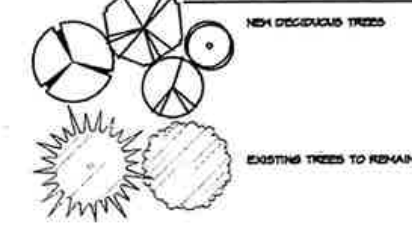

LIGHTING LEGEND

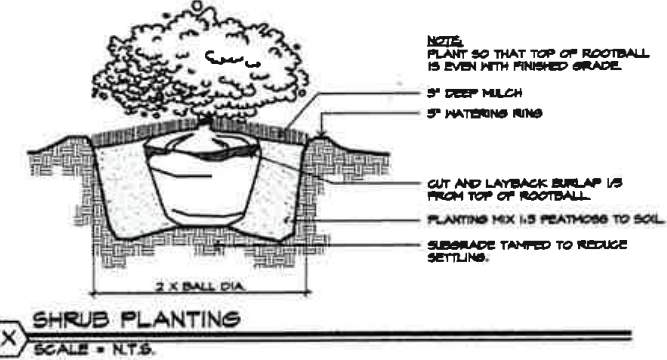
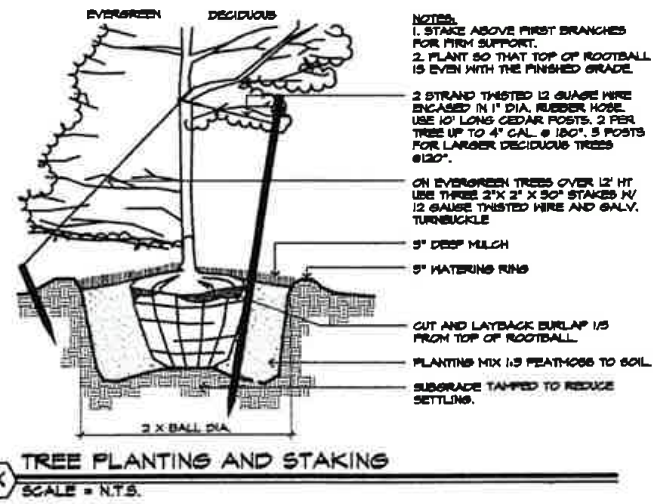
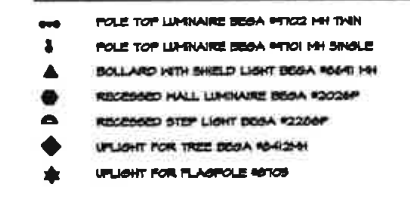

Proposed Banners

24"

54"



24"

54"



24"

54"



24"

54"



125th Anniversary Banners



WILTON LIBRARY

