

STANDARD	MINIMUM/REQUIRED MAXIMUM/ALLOWED	EXISTING CONDITIONS
Minimum Lot Area	2 acre (87,120 sq.ft.)	0.53 acre (23,185sq.ft.)
Minimum Lot Frontage	25 ft.	69.89 ft.
Maximum Lot Width	200 ft.	133.87 ft.
Minimum Yard (Feet in Depth)		
--Front	50 ft.	46.17 ft.
--Side	40 ft.	1.70 ft.
--Rear	50 ft.	62.27 ft.

RESIDENCE ZONE 2-A

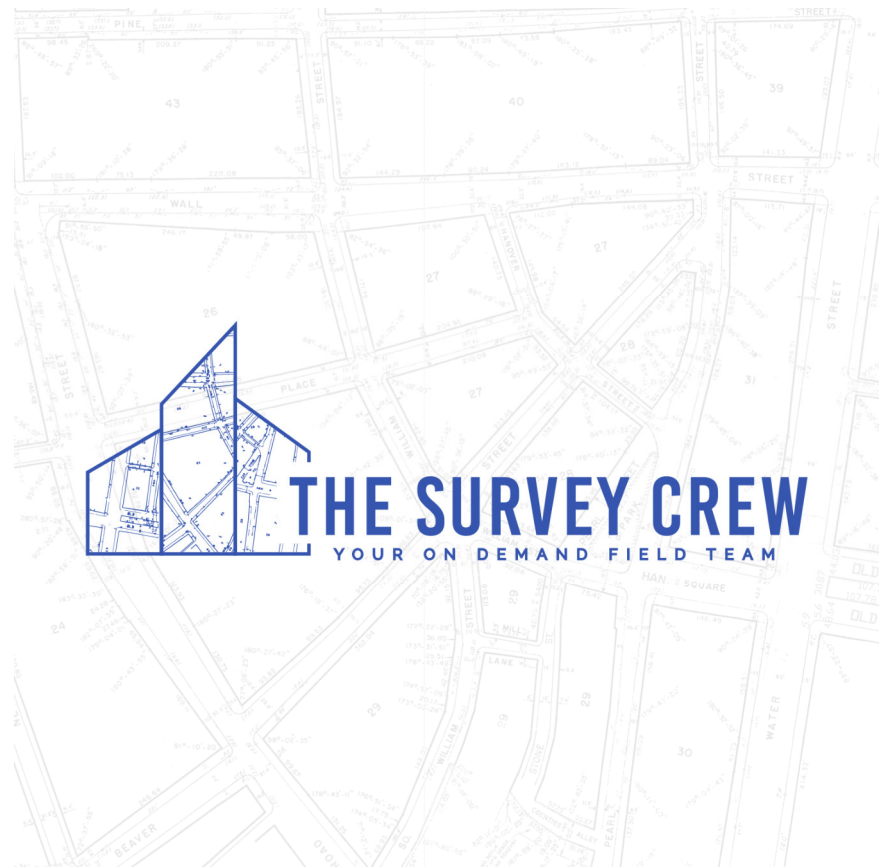

Research & Data Aquisition  
Performed by:  
The Survey Crew LLC.  
55 Merritt Blvd. Trumbull, CT  
203-994-1088

--- NOTES ---

1. This map has been prepared pursuant to the Regulations of Connecticut State Agencies sections 20b-300b-1 thru 20b-300b-20 and the "Standards for Surveys and Maps in the State of Connecticut" as adopted by the Connecticut Association of Land Surveyors, Inc. on September 26, 1996. This conforms to a Class A-2 horizontal survey.
2. The type of survey performed is a Limited Property/Boundary Survey, conforming to an **Zoning Location Survey**, which depicts or notes the position, horizontally & where required, vertically, between particular existing or proposed improvements with respect to the applicable municipal or statutory requirements.
3. The boundary determination is based upon the **dependent resurvey** and is intended to depict a parcel of land acquired by Kristopher Soyland as recorded in Bk. 2562, Pg. 0493, July 10, 2023 on file in the Wilton Town Clerk's Office.
4. No attempt has been made as part of this boundary survey to obtain or show data concerning existence (other than what is shown hereon), size, depth, condition, capacity, or location of any utility or municipal/public service facility. For information regarding these utilities or facilities, please contact the appropriate agencies.
5. This parcel is subject to utility easements, if any, for overhead and or underground service. Substructures and/or their encroachments below grade, if any, not shown.
6. Lot lines depicted hereon established according to record maps & deeds as they exist as well as physical features such as stone walls, wire fences, monuments, iron pins or pipes, etc. all taken under consideration to establish said lot lines.
7. MAP REFERENCES: T.C.M. 1171 on file in the Wilton Town Clerk's Office.

Owner of Record

Kristopher Soyland Bkl. 2562, P. 0496  
Lot Area : 23,185 s.f. = 0.53 acres

**Zoning Location Survey**  
(oil tank installation)

prepared for

**Kristopher Soyland**

**1086 Ridgefield Road, Wilton, Connecticut**

**Residential Zone 2-A**

Scale: 1"= 10'

November 27, 2023.

10 0 10 20 30 Feet

To the best of my knowledge and belief, this is substantially correct as noted hereon.  
This document & copies thereof are valid only if they are signed in red ink & bear the signature & embossed seal of the surveyor noted below. Unauthorized alterations render any declaration hereon null and void.

Fred D'Amico P.E. & LS # 10833  
Connecticut Professionl Land Surveyor

1090 Ridgefield Road  
Bk: 2471 Pg: 0240  
N/F Stockbridge, Ellen P.

GRAVEL  
DRIVEWAY

2 Bay  
Garage

No. 1086  
2 Story  
Residence

Existing Oil Tank  
On Conc. Pad  
New Oil Tank Will  
Be Installed On  
Existing On Conc. Pad  
New Oil Tank Dim.  
L= 3.58' W=2.37'

62.27

1072 Ridgefield Road  
Bk: 2542 Pg: 0710  
N/F Koolis, Christie & Mark

Wood  
Shed

1078 Ridgefield Road  
Bk: 2545 Pg: 0534  
N/F Saverine, Megan

fence  
2.96' South of Lot Line

fence  
7.10' East of Lot Line

fence  
1.53' East of Lot Line

RIDGEFIELD  
ROAD

Location Map  
(not to scale)