

ITEM	REQUIRED / PERMITTED	EXISTING	PROPOSED
ZONE: R – 2A RESIDENCE			
FRONT SETBACK:	50'	MIN. 44.3' (shed)	no change
REAR:	50'	MIN. 2.3' (shed) 47.8' (swelling 2nd floor)	no change
SIDE:	40'	MIN. 36.4' (conservatory)	36.3' (conservatory)
LOT WIDTH:	200'	MIN. 226.97'	no change
LOT AREA:	87,120 S.F.	102,165 Sq. Ft. (TOTAL) 14,285 Sq. Ft. (ACCESS) 87,880 Sq. Ft. (NET LOT)	no change
BUILDING HEIGHT:	35'	MAX. 23.0'	no change
No. STORIES:	2.5	MAX. 2.0	no change
LOT COVERAGE – BUILDING:	7% = 6,151 Sq. Ft.	MAX. 3,160 Sq. Ft. = 3.6%	no change
LOT COVERAGE – SITE:	12% = 10,545 Sq. Ft.	MAX. 11,535 Sq. Ft. = 13.1%	11,535 Sq. Ft. = 13.1%

SIDE YARD SETBACK OF 36.3'  
IN LIEU OF 40' MINIMUM REQUIRED

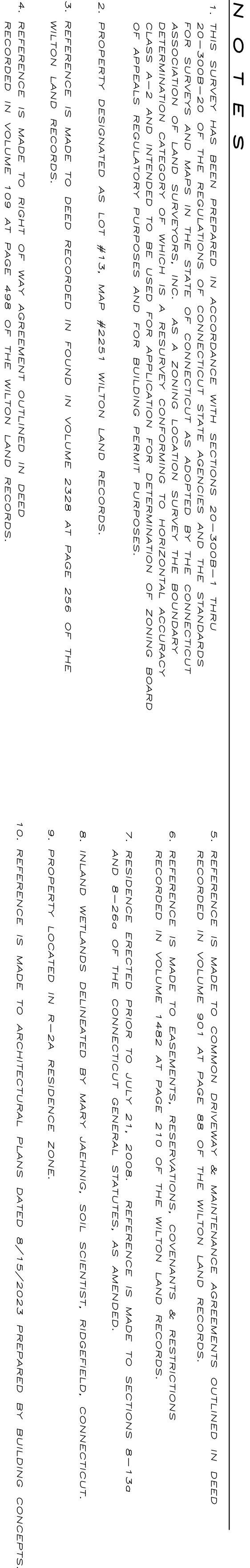

1	CJV	9/28/2023	REVISED PROPOSED SIDE YARD SETBACK FROM PROPOSED CONSERVATORY
No.	By	Date	Revision Note

**RYAN and FAULDS**  
 LAND SURVEYORS  
 4100 SHELTON ST. WILTON, CT 06897  
 TEL: 203.262.3992 | www.ryanandfaulds.com

# ZONING LOCATION SURVEY

## DEPICTING

### CONSERVATORY REPLACEMENT

### #68 DEFOREST ROAD

### WILTON, CONNECTICUT

### PREPARED FOR

### MICHAEL & CRISTIN WALLACE



**REDNISS  
& MEAD**

Scale: 0 30 60  
 1" = 30'



Drawn By: C.W.V.

Checked By: LWP

Date: 09/25/2023

Comm. No.: 9109

Go to my knowledge and I shall find this map is substantially correct as noted above.

*LAWRENCE W. POISSON, Jr.*  
 L.W. POISSON, JR., CT LS #18130  
 9/28/2023

DATE

**Sheet No:**

**ZLS**

This document and copies hereof are to be used only if they bear the signature and embossed seal of the duly licensed professional. I, the undersigned, hereby declare that I am duly licensed herein in the State of Connecticut.