

RE: ZBA Application # **21-04-05**
33 & 37 Church Street, for installation of an AC condenser unit

On the North side of the church structure is an existing row of nine hemlock bushes which provide coverage of the foundation. They are approximately 6-7' high, planted 6' apart and are trimmed annually.

On 4/6/21 the Historical Properties Commission proposed the removal of existing bushes and addition of new bushes such as mountain laurel in a row to provide coverage of the proposed AC unit. Proposed AC condenser unit would sit approximately 3' high. It is likely that the first hemlock to the left of the Bilco doors would need to be removed to accommodate a 3x3 pad on which the condenser would sit.

The applicant notes that this side of the building is in shade/partial sun and any new plantings would need to be hardy. Also, the existing bushes are well established and congruent with the height and type of other plantings on the property. Rather than excavate and cut out existing bushes, the applicant proposes to shield the equipment area with new plantings in a symmetrical way around the existing Bilco doors, and in front of existing bushes. A suggested planting is inkberry holly "ilex glabra" bushes. These were selected for their evergreen foliage and final height of 4-5ft /spread of 4-5ft. Azalea would be another option, but these become bare in winter months. See sketch below, and photos pg 2. Formal landscape plan to follow and be presented at the May meeting of the historical commission.

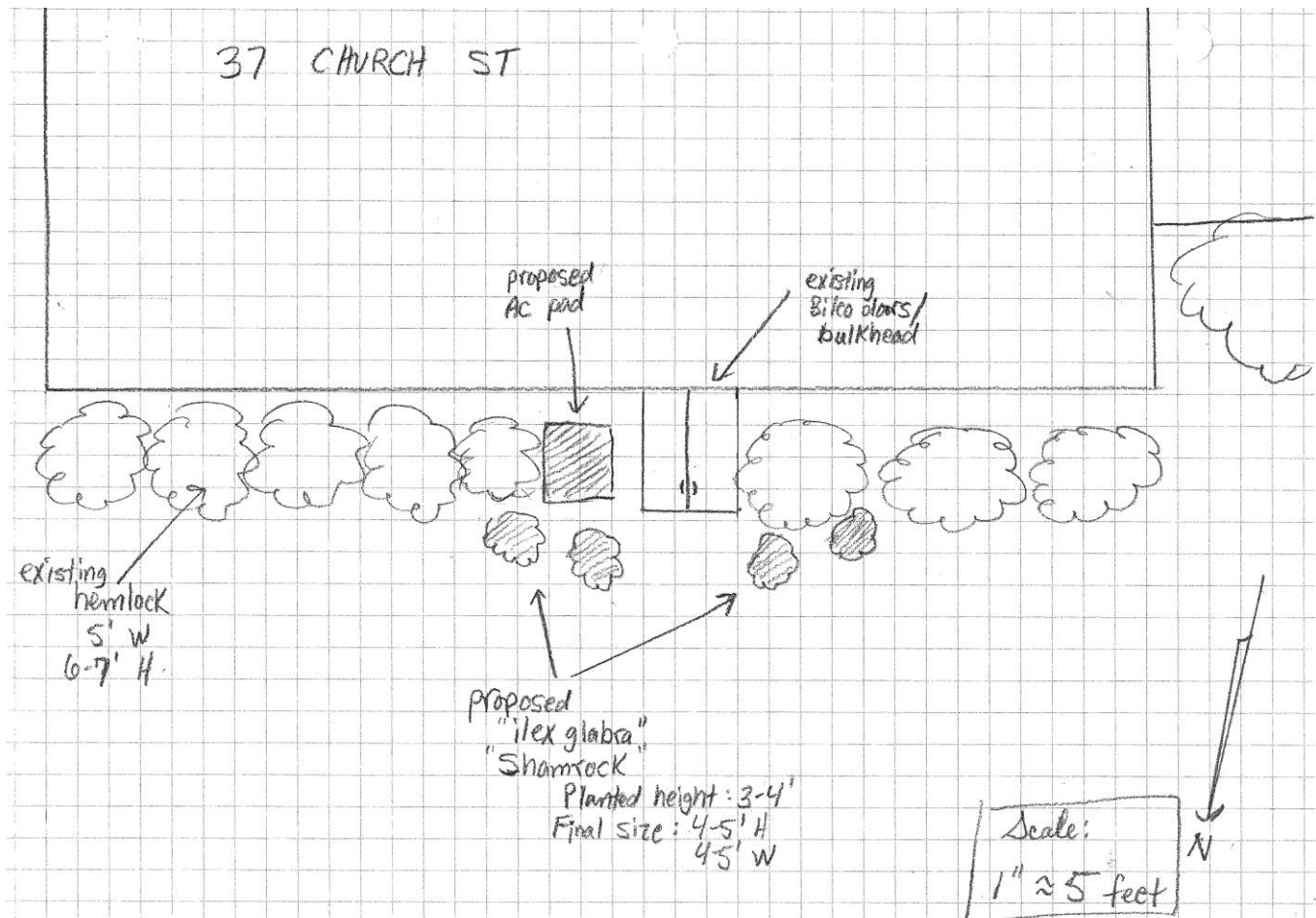



‘Shamrock’ Inkberry/Gallberry Holly
“*ilex glabra*”
Broadleaf evergreen shrub

